

新盤價單表

形璣

價單1號

以最高15%折扣計算

制作日期: 2026-04-29

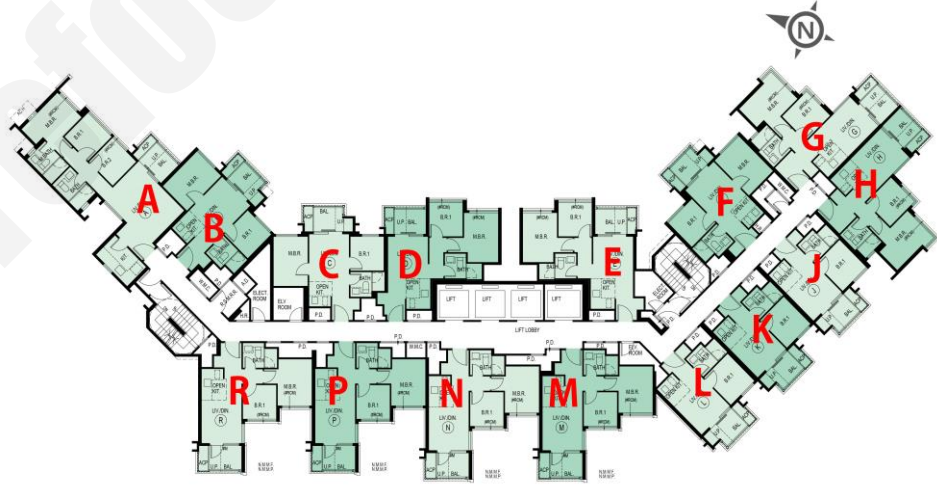

D : 2房 412'		
樓層	訂價	折實價15%
5	\$8,002,000 @\$19,422	\$6,801,700 @\$16,509
6	\$8,018,000 @\$19,461	\$6,815,300 @\$16,542
11	\$8,101,000 @\$19,663	\$6,885,850 @\$16,713
12	\$8,118,000 @\$19,704	\$6,900,300 @\$16,748
15	\$8,143,000 @\$19,765	\$6,921,550 @\$16,800
16	\$8,168,000 @\$19,825	\$6,942,800 @\$16,851
17	\$8,192,000 @\$19,883	\$6,963,200 @\$16,901
22	\$8,317,000 @\$20,187	\$7,069,450 @\$17,159
23	\$8,342,000 @\$20,248	\$7,090,700 @\$17,210
25	\$8,367,000 @\$20,308	\$7,111,950 @\$17,262

E : 2房 416'		
樓層	訂價	折實價15%
5	\$8,163,000 @\$19,623	\$6,938,550 @\$16,679
6	\$8,180,000 @\$19,663	\$6,953,000 @\$16,714
11	\$8,264,000 @\$19,865	\$7,024,400 @\$16,886
12	\$8,280,000 @\$19,904	\$7,038,000 @\$16,918
15	\$8,305,000 @\$19,964	\$7,059,250 @\$16,969
16	\$8,331,000 @\$20,026	\$7,081,350 @\$17,022
17	\$8,356,000 @\$20,087	\$7,102,600 @\$17,074
22	\$8,481,000 @\$20,387	\$7,208,850 @\$17,329
23	\$8,506,000 @\$20,447	\$7,230,100 @\$17,380
25	\$8,531,000 @\$20,507	\$7,251,350 @\$17,431

N : 2房 389'		
樓層	訂價	折實價15%
5	\$7,390,000 @\$18,997	\$6,281,500 @\$16,148
6	\$7,405,000 @\$19,036	\$6,294,250 @\$16,181
11	\$7,699,000 @\$19,792	\$6,544,150 @\$16,823
12	\$7,730,000 @\$19,871	\$6,570,500 @\$16,891
15	\$7,753,000 @\$19,931	\$6,590,050 @\$16,941
16	\$7,776,000 @\$19,990	\$6,609,600 @\$16,991
17	\$7,800,000 @\$20,051	\$6,630,000 @\$17,044
22	\$7,931,000 @\$20,388	\$6,741,350 @\$17,330
23	\$7,970,000 @\$20,488	\$6,774,500 @\$17,415
25	\$8,008,000 @\$20,586	\$6,806,800 @\$17,498

P : 2房 390'		
樓層	訂價	折實價15%
5	\$7,447,000 @\$19,095	\$6,329,950 @\$16,231
6	\$7,482,000 @\$19,185	\$6,359,700 @\$16,307
11	\$7,796,000 @\$19,990	\$6,626,600 @\$16,991
12	\$7,827,000 @\$20,069	\$6,652,950 @\$17,059
15	\$7,851,000 @\$20,131	\$6,673,350 @\$17,111
16	\$7,874,000 @\$20,190	\$6,692,900 @\$17,161
17	\$7,897,000 @\$20,249	\$6,712,450 @\$17,211
22	\$8,029,000 @\$20,587	\$6,824,650 @\$17,499
23	\$8,068,000 @\$20,687	\$6,857,800 @\$17,584
25	\$8,106,000 @\$20,785	\$6,890,100 @\$17,667

G : 2房 410'		
樓層	訂價	折實價15%
5	\$8,235,000 @\$20,085	\$6,999,750 @\$17,073
6	\$8,260,000 @\$20,146	\$7,021,000 @\$17,124
11	\$8,384,000 @\$20,449	\$7,126,400 @\$17,381
12	\$8,408,000 @\$20,507	\$7,146,800 @\$17,431
15	\$8,433,000 @\$20,568	\$7,168,050 @\$17,483
16	\$8,458,000 @\$20,629	\$7,189,300 @\$17,535
17	\$8,483,000 @\$20,690	\$7,210,550 @\$17,587
22	\$8,615,000 @\$21,012	\$7,322,750 @\$17,860
23	\$8,639,000 @\$21,071	\$7,343,150 @\$17,910
25	\$8,664,000 @\$21,132	\$7,364,400 @\$17,962

H : 2房 410'		
樓層	訂價	折實價15%
5	\$8,153,000 @\$19,885	\$6,930,050 @\$16,903
6	\$8,178,000 @\$19,946	\$6,951,300 @\$16,954
11	\$8,301,000 @\$20,246	\$7,055,850 @\$17,209
12	\$8,326,000 @\$20,307	\$7,077,100 @\$17,261
15	\$8,351,000 @\$20,368	\$7,098,350 @\$17,313
16	\$8,375,000 @\$20,427	\$7,118,750 @\$17,363
17	\$8,400,000 @\$20,488	\$7,140,000 @\$17,415
22	\$8,532,000 @\$20,810	\$7,252,200 @\$17,688
23	\$8,565,000 @\$20,890	\$7,280,250 @\$17,757
25	\$8,598,000 @\$20,971	\$7,308,300 @\$17,825

R : 2房 393'		
樓層	訂價	折實價15%
5	\$7,544,000 @\$19,196	\$6,412,400 @\$16,317
6	\$7,598,000 @\$19,333	\$6,458,300 @\$16,433
11	\$7,934,000 @\$20,188	\$6,743,900 @\$17,160
12	\$7,966,000 @\$20,270	\$6,771,100 @\$17,229
15	\$7,989,000 @\$20,328	\$6,790,650 @\$17,279
16	\$8,013,000 @\$20,389	\$6,811,050 @\$17,331
17	\$8,036,000 @\$20,448	\$6,830,600 @\$17,381
22	\$8,169,000 @\$20,786	\$6,943,650 @\$17,668
23	\$8,208,000 @\$20,885	\$6,976,800 @\$17,753
25	\$8,247,000 @\$20,985	\$7,009,950 @\$17,837

J : 1房 273'		
樓層	訂價	折實價15%
5	\$5,432,000 @\$19,897	\$4,617,200 @\$16,913
6	\$5,460,000 @\$20,000	\$4,641,000 @\$17,000
11	\$5,580,000 @\$20,440	\$4,743,000 @\$17,374
12	\$5,603,000 @\$20,524	\$4,762,550 @\$17,445
15	\$5,620,000 @\$20,586	\$4,777,000 @\$17,498
16	\$5,638,000 @\$20,652	\$4,792,300 @\$17,554
17	\$5,655,000 @\$20,714	\$4,806,750 @\$17,607
22	\$5,740,000 @\$21,026	\$4,879,000 @\$17,872
23	\$5,758,000 @\$21,092	\$4,894,300 @\$17,928
25	\$5,775,000 @\$21,154	\$4,908,750 @\$17,981

K : 1房 273'		
樓層	訂價	折實價15%
5	\$5,429,000 @\$19,886	\$4,614,650 @\$16,903
6	\$5,457,000 @\$19,989	\$4,638,450 @\$16,991
11	\$5,578,000 @\$20,432	\$4,741,300 @\$17,367
12	\$5,600,000 @\$20,513	\$4,760,000 @\$17,436
15	\$5,618,000 @\$20,579	\$4,775,300 @\$17,492
16	\$5,635,000 @\$20,641	\$4,789,750 @\$17,545
17	\$5,652,000 @\$20,703	\$4,804,200 @\$17,598
22	\$5,738,000 @\$21,018	\$4,877,300 @\$17,866
23	\$5,755,000 @\$21,081	\$4,891,750 @\$17,918
25	\$5,772,000 @\$21,143	\$4,906,200 @\$17,971

L : 1房 276'		
樓層	訂價	折實價15%
5	\$5,490,000 @\$19,891	\$4,666,500 @\$16,908
6	\$5,519,000 @\$19,996	\$4,691,150 @\$16,997
11	\$5,640,000 @\$20,435	\$4,794,000 @\$17,370
12	\$5,663,000 @\$20,518	\$4,813,550 @\$17,440
15	\$5,681,000 @\$20,583	\$4,828,850 @\$17,496
16	\$5,698,000 @\$20,645	\$4,843,300 @\$17,548
17	\$5,715,000 @\$20,707	\$4,857,750 @\$17,601
22	\$5,802,000 @\$21,022	\$4,931,700 @\$17,868
23	\$5,819,000 @\$21,083	\$4,946,150 @\$17,921
25	\$5,837,000 @\$21,149	\$4,961,450 @\$17,976

M : 2房 393'		
樓層	訂價	折實價15%
5	\$7,434,000 @\$18,916	\$6,318,900 @\$16,079
6	\$7,466,000 @\$18,997	\$6,346,100 @\$16,148
11	\$7,622,000 @\$19,394	\$6,478,700 @\$16,485
12	\$7,653,000 @\$19,473	\$6,505,050 @\$16,552
15	\$7,677,000 @\$19,534	\$6,525,450 @\$16,604
16	\$7,700,000 @\$19,593	\$6,545,000 @\$16,654
17	\$7,723,000 @\$19,651	\$6,564,550 @\$16,704
22	\$7,856,000 @\$19,990	\$6,677,600 @\$16,991
23	\$7,895,000 @\$20,089	\$6,710,750 @\$17,076
25	\$7,934,000 @\$20,188	\$6,743,900 @\$17,160

的物業資料只供參考，一切以發展商最新公布為準，如有任何資料錯漏本網頁不會承擔任何責任。