

新盤價單表

Double Coast III

價單1號

以最高12%折扣計算

制作日期: 2025-12-09



Tower 1A

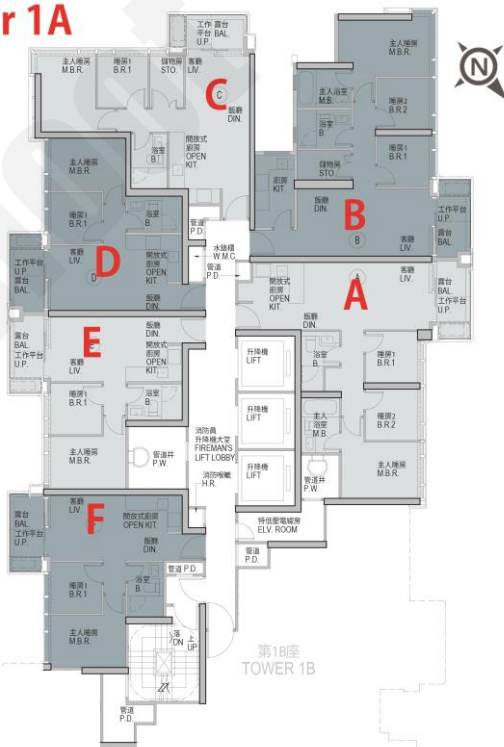

B : 3房 696'		
樓層	訂價	折實價12%
6	\$16,883,000 @\$24,257	\$14,857,040 @\$21,346
7	\$16,925,000 @\$24,318	\$14,894,000 @\$21,399
8	\$17,010,000 @\$24,440	\$14,968,800 @\$21,507
9	\$17,052,000 @\$24,500	\$15,005,760 @\$21,560
10	\$17,095,000 @\$24,562	\$15,043,600 @\$21,614
11	\$17,137,000 @\$24,622	\$15,080,560 @\$21,667
12	\$17,180,000 @\$24,684	\$15,118,400 @\$21,722
15	\$17,223,000 @\$24,746	\$15,156,240 @\$21,776
16	\$17,266,000 @\$24,807	\$15,194,080 @\$21,831
17	\$17,309,000 @\$24,869	\$15,231,920 @\$21,885
18	\$17,396,000 @\$24,994	\$15,308,480 @\$21,995
19	\$17,439,000 @\$25,056	\$15,346,320 @\$22,049
20	\$17,483,000 @\$25,119	\$15,385,040 @\$22,105
21	\$17,527,000 @\$25,182	\$15,423,760 @\$22,161
22	\$17,571,000 @\$25,246	\$15,462,480 @\$22,216
23	\$17,614,000 @\$25,307	\$15,500,320 @\$22,271
26	\$17,703,000 @\$25,435	\$15,578,640 @\$22,383
27	\$17,747,000 @\$25,499	\$15,617,360 @\$22,439
29	\$17,880,000 @\$25,690	\$15,734,400 @\$22,607
30	\$17,925,000 @\$25,754	\$15,774,000 @\$22,664
32	\$18,015,000 @\$25,884	\$15,853,200 @\$22,778
33	\$18,060,000 @\$25,948	\$15,892,800 @\$22,834

A : 3房 641'		
樓層	訂價	折實價12%
8	\$15,228,000 @\$23,757	\$13,400,640 @\$20,906
15	\$15,419,000 @\$24,055	\$13,568,720 @\$21,168
E : 2房 429'		
樓層	訂價	折實價12%
8	\$8,237,000 @\$19,200	\$7,248,560 @\$16,896
9	\$8,258,000 @\$19,249	\$7,267,040 @\$16,939
10	\$8,279,000 @\$19,298	\$7,285,520 @\$16,983
11	\$8,299,000 @\$19,345	\$7,303,120 @\$17,024
12	\$8,320,000 @\$19,394	\$7,321,600 @\$17,067

F : 2房 430'		
樓層	訂價	折實價12%
10	\$8,140,000 @\$18,930	\$7,163,200 @\$16,659
11	\$8,160,000 @\$18,977	\$7,180,800 @\$16,700
12	\$8,181,000 @\$19,026	\$7,199,280 @\$16,743
15	\$8,201,000 @\$19,072	\$7,216,880 @\$16,783
16	\$8,222,000 @\$19,121	\$7,235,360 @\$16,826
17	\$8,242,000 @\$19,167	\$7,252,960 @\$16,867
18	\$8,284,000 @\$19,265	\$7,289,920 @\$16,953

紅色為最高售價、最高平均呎價；藍色為最低售價、最低平均呎價
 以上的物業資料只供參考，一切以發展商最新公布為準，如有任何資料錯漏本網頁不會承擔任何責任。

價單1號

以最高12%折扣計算

制作日期: 2025-12-09

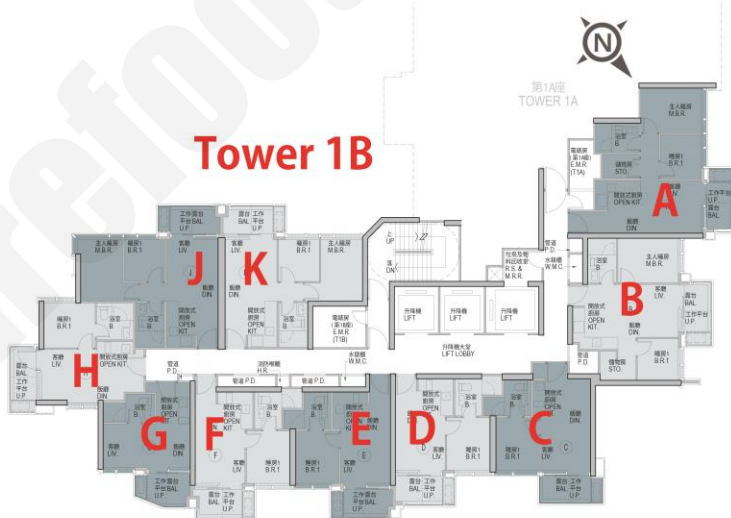

E: 1房 319'		
樓層	訂價	折實價12%
6	\$6,208,000 @\$19,461	\$5,463,040 @\$17,126
7	\$6,223,000 @\$19,508	\$5,476,240 @\$17,167
8	\$6,254,000 @\$19,605	\$5,503,520 @\$17,252
9	\$6,270,000 @\$19,655	\$5,517,600 @\$17,297
10	\$6,285,000 @\$19,702	\$5,530,800 @\$17,338
11	\$6,301,000 @\$19,752	\$5,544,880 @\$17,382
12	\$6,317,000 @\$19,803	\$5,558,960 @\$17,426
15	\$6,333,000 @\$19,853	\$5,573,040 @\$17,470
16	\$6,349,000 @\$19,903	\$5,587,120 @\$17,514
17	\$6,364,000 @\$19,950	\$5,600,320 @\$17,556
18	\$6,396,000 @\$20,050	\$5,628,480 @\$17,644
19	\$6,412,000 @\$20,100	\$5,642,560 @\$17,688
20	\$6,428,000 @\$20,150	\$5,656,640 @\$17,732
21	\$6,444,000 @\$20,201	\$5,670,720 @\$17,777
22	\$6,460,000 @\$20,251	\$5,684,800 @\$17,821
23	\$6,477,000 @\$20,304	\$5,699,760 @\$17,868
25	\$6,493,000 @\$20,354	\$5,713,840 @\$17,912
26	\$6,509,000 @\$20,404	\$5,727,920 @\$17,956
27	\$6,525,000 @\$20,455	\$5,742,000 @\$18,000
29	\$6,574,000 @\$20,608	\$5,785,120 @\$18,135
30	\$6,591,000 @\$20,661	\$5,800,080 @\$18,182
33	\$18,060,000 @\$25,948	\$15,892,800 @\$22,834

F: 1房 319'		
樓層	訂價	折實價12%
6	\$6,207,000 @\$19,458	\$5,462,160 @\$17,123
7	\$6,223,000 @\$19,508	\$5,476,240 @\$17,167
8	\$6,285,000 @\$19,702	\$5,530,800 @\$17,338
9	\$6,301,000 @\$19,752	\$5,544,880 @\$17,382
10	\$6,317,000 @\$19,803	\$5,558,960 @\$17,426
11	\$6,333,000 @\$19,853	\$5,573,040 @\$17,470
12	\$6,348,000 @\$19,900	\$5,586,240 @\$17,512
15	\$6,364,000 @\$19,950	\$5,600,320 @\$17,556
16	\$6,380,000 @\$20,000	\$5,614,400 @\$17,600
17	\$6,396,000 @\$20,050	\$5,628,480 @\$17,644
18	\$6,428,000 @\$20,150	\$5,656,640 @\$17,732
19	\$6,444,000 @\$20,201	\$5,670,720 @\$17,777
20	\$6,460,000 @\$20,251	\$5,684,800 @\$17,821
21	\$6,477,000 @\$20,304	\$5,699,760 @\$17,868
22	\$6,493,000 @\$20,354	\$5,713,840 @\$17,912
23	\$6,509,000 @\$20,404	\$5,727,920 @\$17,956
25	\$6,525,000 @\$20,455	\$5,742,000 @\$18,000
26	\$6,542,000 @\$20,508	\$5,756,960 @\$18,047
27	\$6,558,000 @\$20,558	\$5,771,040 @\$18,091
29	\$6,607,000 @\$20,712	\$5,814,160 @\$18,226
30	\$6,624,000 @\$20,765	\$5,829,120 @\$18,273

E: 2房 319'		
樓層	訂價	折實價12%
7	\$10,148,000 @\$22,303	\$8,930,240 @\$19,627
8	\$10,199,000 @\$22,415	\$8,975,120 @\$19,726
9	\$10,225,000 @\$22,473	\$8,998,000 @\$19,776
10	\$10,250,000 @\$22,527	\$9,020,000 @\$19,824
11	\$10,276,000 @\$22,585	\$9,042,880 @\$19,874
12	\$10,301,000 @\$22,640	\$9,064,880 @\$19,923
15	\$10,327,000 @\$22,697	\$9,087,760 @\$19,973
16	\$10,353,000 @\$22,754	\$9,110,640 @\$20,023
17	\$10,379,000 @\$22,811	\$9,133,520 @\$20,074
18	\$10,431,000 @\$22,925	\$9,179,280 @\$20,174
19	\$10,457,000 @\$22,982	\$9,202,160 @\$20,225
20	\$10,483,000 @\$23,040	\$9,225,040 @\$20,275

J: 2房 414'		
樓層	訂價	折實價12%
7	\$8,306,000 @\$20,063	\$7,309,280 @\$17,655
8	\$8,347,000 @\$20,162	\$7,345,360 @\$17,742
9	\$8,368,000 @\$20,213	\$7,363,840 @\$17,787
10	\$8,389,000 @\$20,263	\$7,382,320 @\$17,832
11	\$8,410,000 @\$20,314	\$7,400,800 @\$17,876
12	\$8,431,000 @\$20,365	\$7,419,280 @\$17,921
15	\$8,452,000 @\$20,415	\$7,437,760 @\$17,966
G: 開放式 249'		
樓層	訂價	折實價12%
8	\$4,762,000 @\$19,124	\$4,190,560 @\$16,830
9	\$4,773,000 @\$19,169	\$4,200,240 @\$16,868
10	\$4,785,000 @\$19,217	\$4,210,800 @\$16,911
11	\$4,797,000 @\$19,265	\$4,221,360 @\$16,953
12	\$4,809,000 @\$19,313	\$4,231,920 @\$16,996
15	\$4,821,000 @\$19,361	\$4,242,480 @\$17,038
16	\$4,833,000 @\$19,410	\$4,253,040 @\$17,080
17	\$4,845,000 @\$19,458	\$4,263,600 @\$17,123

紅色為最高售價、最高平均呎價；藍色為最低售價、最低平均呎價
 以上的物業資料只供參考，一切以發展商最新公布為準，如有任何資料錯漏本網頁不會承擔任何責任。