

新盤價單表

Spring Garden

價單1號

以最高12%折扣計算

制作日期: 2025-10-27



A : 1房 292'		
樓層	訂價	折實價12%
7	\$9,101,000 @\$31,168	\$8,008,880 @\$27,428
8	\$9,154,000 @\$31,349	\$8,055,520 @\$27,587
12	\$9,462,000 @\$32,404	\$8,326,560 @\$28,516
15	\$9,490,000 @\$32,500	\$8,351,200 @\$28,600
16	\$9,519,000 @\$32,599	\$8,376,720 @\$28,687
23	\$10,021,000 @\$34,318	\$8,818,480 @\$30,200
25	\$10,051,000 @\$34,421	\$8,844,880 @\$30,291
B : 2房 398'		
樓層	訂價	折實價12%
7	\$12,772,000 @\$32,090	\$11,239,360 @\$28,240
8	\$12,850,000 @\$32,286	\$11,308,000 @\$28,412
12	\$13,598,000 @\$34,166	\$11,966,240 @\$30,066
15	\$13,638,000 @\$34,266	\$12,001,440 @\$30,154
16	\$13,679,000 @\$34,369	\$12,037,520 @\$30,245
23	\$14,205,000 @\$35,691	\$12,500,400 @\$31,408
25	\$14,248,000 @\$35,799	\$12,538,240 @\$31,503

C : 1房 278'		
樓層	訂價	折實價12%
7	\$9,248,000 @\$33,266	\$8,138,240 @\$29,274
8	\$9,304,000 @\$33,468	\$8,187,520 @\$29,452
12	\$9,557,000 @\$34,378	\$8,410,160 @\$30,252
15	\$9,585,000 @\$34,478	\$8,434,800 @\$30,341
16	\$9,614,000 @\$34,583	\$8,460,320 @\$30,433
17	\$9,643,000 @\$34,687	\$8,485,840 @\$30,525
23	\$9,846,000 @\$35,417	\$8,664,480 @\$31,167
25	\$9,876,000 @\$35,525	\$8,690,880 @\$31,262

D : 1房 282'		
樓層	訂價	折實價12%
7	\$9,248,000 @\$32,794	\$8,138,240 @\$28,859
8	\$9,304,000 @\$32,993	\$8,187,520 @\$29,034
12	\$9,557,000 @\$33,890	\$8,410,160 @\$29,823
15	\$9,585,000 @\$33,989	\$8,434,800 @\$29,911
16	\$9,614,000 @\$34,092	\$8,460,320 @\$30,001
17	\$9,643,000 @\$34,195	\$8,485,840 @\$30,092
23	\$9,846,000 @\$34,915	\$8,664,480 @\$30,725
25	\$9,876,000 @\$35,021	\$8,690,880 @\$30,819

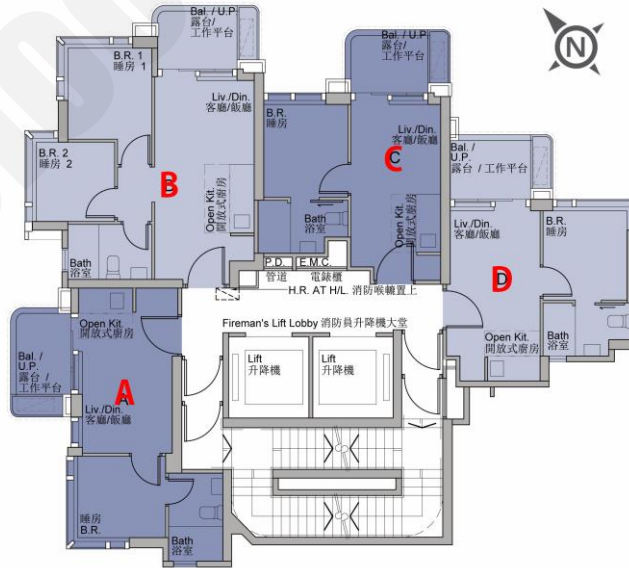

紅色為最高售價、最高平均呎價；藍色為最低售價、最低平均呎價
 以上的物業資料只供參考，一切以發展商最新公布為準，如有任何資料錯漏本網頁不會承擔任何責任。