

T1A C : 1房 319'		
樓層	訂價	折實價12%
2	\$7,637,000 @\$23,940	\$6,720,560 @\$21,068
3	\$7,754,000 @\$24,307	\$6,823,520 @\$21,390
5	\$7,872,000 @\$24,677	\$6,927,360 @\$21,716
6	\$7,952,000 @\$24,928	\$6,997,760 @\$21,937
7	\$8,031,000 @\$25,176	\$7,067,280 @\$22,154
8	\$8,154,000 @\$25,561	\$7,175,520 @\$22,494
9	\$8,195,000 @\$25,690	\$7,211,600 @\$22,607
10	\$8,236,000 @\$25,818	\$7,247,680 @\$22,720
11	\$8,278,000 @\$25,950	\$7,284,640 @\$22,836
12	\$8,319,000 @\$26,078	\$7,320,720 @\$22,949
15	\$8,361,000 @\$26,210	\$7,357,680 @\$23,065
16	\$8,403,000 @\$26,342	\$7,394,640 @\$23,181
18	\$8,530,000 @\$26,740	\$7,506,400 @\$23,531
19	\$8,573,000 @\$26,875	\$7,544,240 @\$23,650
20	\$8,616,000 @\$27,009	\$7,582,080 @\$23,768
21	\$8,660,000 @\$27,147	\$7,620,800 @\$23,890
22	\$8,703,000 @\$27,282	\$7,658,640 @\$24,008
23	\$8,746,000 @\$27,417	\$7,696,480 @\$24,127
25	\$8,790,000 @\$27,555	\$7,735,200 @\$24,248
26	\$8,833,000 @\$27,690	\$7,773,040 @\$24,367
27	\$8,878,000 @\$27,831	\$7,812,640 @\$24,491
28	\$8,966,000 @\$28,107	\$7,890,080 @\$24,734
29	\$9,056,000 @\$28,389	\$7,969,280 @\$24,982
30	\$9,147,000 @\$28,674	\$8,049,360 @\$25,233
31	\$9,238,000 @\$28,959	\$8,129,440 @\$25,484
32	\$9,331,000 @\$29,251	\$8,211,280 @\$25,741
33	\$9,424,000 @\$29,542	\$8,293,120 @\$25,997



T1A D : 2房 431'		
樓層	訂價	折實價12%
2	\$10,772,000 @\$24,993	\$9,479,360 @\$21,994
3	\$10,937,000 @\$25,376	\$9,624,560 @\$22,331
5	\$11,103,000 @\$25,761	\$9,770,640 @\$22,670
6	\$11,215,000 @\$26,021	\$9,869,200 @\$22,898
7	\$11,329,000 @\$26,285	\$9,969,520 @\$23,131
8	\$11,502,000 @\$26,687	\$10,121,760 @\$23,484
9	\$11,558,000 @\$26,817	\$10,171,040 @\$23,599
10	\$11,618,000 @\$26,956	\$10,223,840 @\$23,721
11	\$11,675,000 @\$27,088	\$10,274,000 @\$23,838
12	\$11,733,000 @\$27,223	\$10,325,040 @\$23,956
15	\$11,793,000 @\$27,362	\$10,377,840 @\$24,079
16	\$11,853,000 @\$27,501	\$10,430,640 @\$24,201
18	\$12,032,000 @\$27,916	\$10,588,160 @\$24,566
19	\$12,093,000 @\$28,058	\$10,641,840 @\$24,691
20	\$12,153,000 @\$28,197	\$10,694,640 @\$24,814
21	\$12,214,000 @\$28,339	\$10,748,320 @\$24,938
22	\$12,275,000 @\$28,480	\$10,802,000 @\$25,063
23	\$12,337,000 @\$28,624	\$10,856,560 @\$25,189
25	\$12,398,000 @\$28,766	\$10,910,240 @\$25,314
26	\$12,461,000 @\$28,912	\$10,965,680 @\$25,442
27	\$12,522,000 @\$29,053	\$11,019,360 @\$25,567
28	\$12,648,000 @\$29,346	\$11,130,240 @\$25,824
29	\$12,774,000 @\$29,638	\$11,241,120 @\$26,081
30	\$12,902,000 @\$29,935	\$11,353,760 @\$26,343
31	\$13,031,000 @\$30,234	\$11,467,280 @\$26,606
32	\$13,161,000 @\$30,536	\$11,581,680 @\$26,872
33	\$13,293,000 @\$30,842	\$11,697,840 @\$27,141
35	\$13,493,000 @\$31,306	\$11,873,840 @\$27,550

T1A E : 2房 453'		
樓層	訂價	折實價12%
2	\$11,363,000 @\$25,084	\$9,999,440 @\$22,074
3	\$11,536,000 @\$25,466	\$10,151,680 @\$22,410
5	\$11,711,000 @\$25,852	\$10,305,680 @\$22,750
6	\$11,830,000 @\$26,115	\$10,410,400 @\$22,981
7	\$11,949,000 @\$26,377	\$10,515,120 @\$23,212
8	\$12,131,000 @\$26,779	\$10,675,280 @\$23,566
9	\$12,191,000 @\$26,912	\$10,728,080 @\$23,682
10	\$12,253,000 @\$27,049	\$10,782,640 @\$23,803
11	\$12,315,000 @\$27,185	\$10,837,200 @\$23,923
12	\$12,377,000 @\$27,322	\$10,891,760 @\$24,044
15	\$12,439,000 @\$27,459	\$10,946,320 @\$24,164
16	\$12,502,000 @\$27,598	\$11,001,760 @\$24,286
18	\$12,691,000 @\$28,015	\$11,168,080 @\$24,654
19	\$12,755,000 @\$28,157	\$11,224,400 @\$24,778
20	\$12,819,000 @\$28,298	\$11,280,720 @\$24,902
21	\$12,883,000 @\$28,439	\$11,337,040 @\$25,027
22	\$12,947,000 @\$28,581	\$11,393,360 @\$25,151
23	\$13,012,000 @\$28,724	\$11,450,560 @\$25,277
25	\$13,078,000 @\$28,870	\$11,508,640 @\$25,405
26	\$13,143,000 @\$29,013	\$11,566,840 @\$25,532
27	\$13,208,000 @\$29,157	\$11,623,040 @\$25,658
28	\$13,340,000 @\$29,448	\$11,739,200 @\$25,914
29	\$13,473,000 @\$29,742	\$11,856,240 @\$26,173
30	\$13,608,000 @\$30,040	\$11,975,040 @\$26,435
31	\$13,745,000 @\$30,342	\$12,095,600 @\$26,701
32	\$13,882,000 @\$30,645	\$12,216,160 @\$26,967
33	\$14,021,000 @\$30,951	\$12,338,480 @\$27,237
35	\$14,231,000 @\$31,415	\$12,523,280 @\$27,645

紅色為最高售價、最高平均呎價；藍色為最低售價、最低平均呎價

以上的物業資料只供參考，一切以發展商最新公布為準，如有任何資料錯漏本網頁不會承擔任何責任。

新盤價單表

維港灣畔 1A期 迎海門

價單1號

以最高12%折扣計算

制作日期: 2025-11-06



T1B B : 2房 449'		
樓層	訂價	折實價12%
2	\$11,649,000 @\$25,944	\$10,251,120 @\$22,831
3	\$11,827,000 @\$26,341	\$10,407,760 @\$23,180
5	\$12,007,000 @\$26,742	\$10,566,160 @\$23,533
6	\$12,129,000 @\$27,013	\$10,673,520 @\$23,772
7	\$12,250,000 @\$27,283	\$10,780,000 @\$24,009
8	\$12,438,000 @\$27,702	\$10,945,440 @\$24,377
9	\$12,500,000 @\$27,840	\$11,000,000 @\$24,499
10	\$12,563,000 @\$27,980	\$11,055,440 @\$24,622
11	\$12,625,000 @\$28,118	\$11,110,000 @\$24,744
12	\$12,689,000 @\$28,261	\$11,166,320 @\$24,869
15	\$12,763,000 @\$28,403	\$11,222,640 @\$24,995
16	\$12,818,000 @\$28,548	\$11,279,840 @\$25,122
18	\$13,012,000 @\$28,980	\$11,450,560 @\$25,502
19	\$13,077,000 @\$29,125	\$11,507,760 @\$25,630
20	\$13,143,000 @\$29,272	\$11,565,840 @\$25,759
21	\$13,208,000 @\$29,416	\$11,623,040 @\$25,887
22	\$13,274,000 @\$29,563	\$11,681,120 @\$26,016
23	\$13,341,000 @\$29,713	\$11,740,080 @\$26,147
25	\$13,407,000 @\$29,860	\$11,798,160 @\$26,277
26	\$13,474,000 @\$30,009	\$11,857,120 @\$26,408
27	\$13,543,000 @\$30,163	\$11,917,840 @\$26,543
28	\$13,678,000 @\$30,463	\$12,036,640 @\$26,808
29	\$13,814,000 @\$30,766	\$12,156,320 @\$27,074
30	\$13,953,000 @\$31,076	\$12,278,640 @\$27,347
31	\$14,091,000 @\$31,383	\$12,400,080 @\$27,617
32	\$14,232,000 @\$31,697	\$12,524,160 @\$27,893
33	\$14,375,000 @\$32,016	\$12,650,000 @\$28,174
35	\$14,590,000 @\$32,494	\$12,839,200 @\$28,595

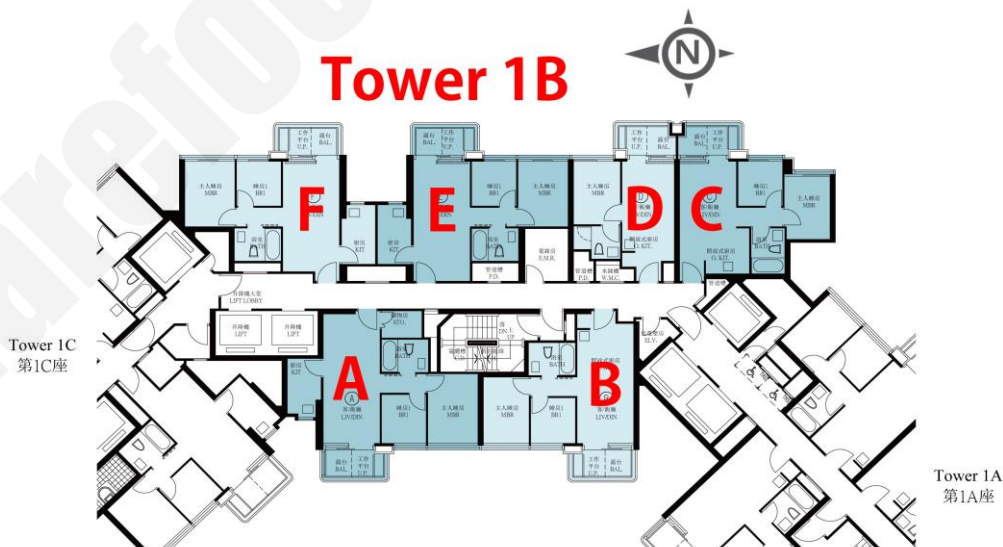

紅色為最高售價、最高平均呎價；藍色為最低售價、最低平均呎價

以上的物業資料只供參考，一切以發展商最新公布為準，如有任何資料錯漏本網頁不會承擔任何責任。

新盤價單表

維港灣畔 1A期 迎海門

價單1號

以最高12%折扣計算

制作日期: 2025-11-06



T1C G : 2房 513'		
樓層	訂價	折實價12%
2	\$14,397,000 @\$28,064	\$12,669,360 @\$24,697
3	\$14,616,000 @\$28,491	\$12,862,080 @\$25,072
5	\$14,839,000 @\$28,926	\$13,058,320 @\$25,455
6	\$14,989,000 @\$29,218	\$13,190,320 @\$25,712
7	\$15,140,000 @\$29,513	\$13,323,200 @\$25,971
8	\$15,371,000 @\$29,963	\$13,526,480 @\$26,367
9	\$15,448,000 @\$30,113	\$13,594,240 @\$26,499
10	\$15,525,000 @\$30,263	\$13,662,000 @\$26,632
11	\$15,604,000 @\$30,417	\$13,731,520 @\$26,767
12	\$15,682,000 @\$30,569	\$13,800,160 @\$26,901
15	\$15,761,000 @\$30,723	\$13,869,680 @\$27,036
16	\$15,840,000 @\$30,877	\$13,939,200 @\$27,172
18	\$16,080,000 @\$31,345	\$14,150,400 @\$27,584
19	\$16,162,000 @\$31,505	\$14,222,560 @\$27,724
20	\$16,243,000 @\$31,663	\$14,293,840 @\$27,863
21	\$16,323,000 @\$31,819	\$14,364,240 @\$28,000
22	\$16,405,000 @\$31,979	\$14,436,400 @\$28,141
23	\$16,487,000 @\$32,138	\$14,508,560 @\$28,282
25	\$16,570,000 @\$32,300	\$14,581,600 @\$28,424
26	\$16,653,000 @\$32,462	\$14,654,640 @\$28,567
27	\$16,736,000 @\$32,624	\$14,727,680 @\$28,709
28	\$16,903,000 @\$32,949	\$14,874,640 @\$28,995
29	\$17,072,000 @\$33,279	\$15,023,360 @\$29,285
30	\$17,243,000 @\$33,612	\$15,173,840 @\$29,579
31	\$17,415,000 @\$33,947	\$15,325,200 @\$29,874
32	\$17,589,000 @\$34,287	\$15,478,320 @\$30,172
33	\$17,765,000 @\$34,630	\$15,633,200 @\$30,474
35	\$18,032,000 @\$35,150	\$15,868,160 @\$30,932

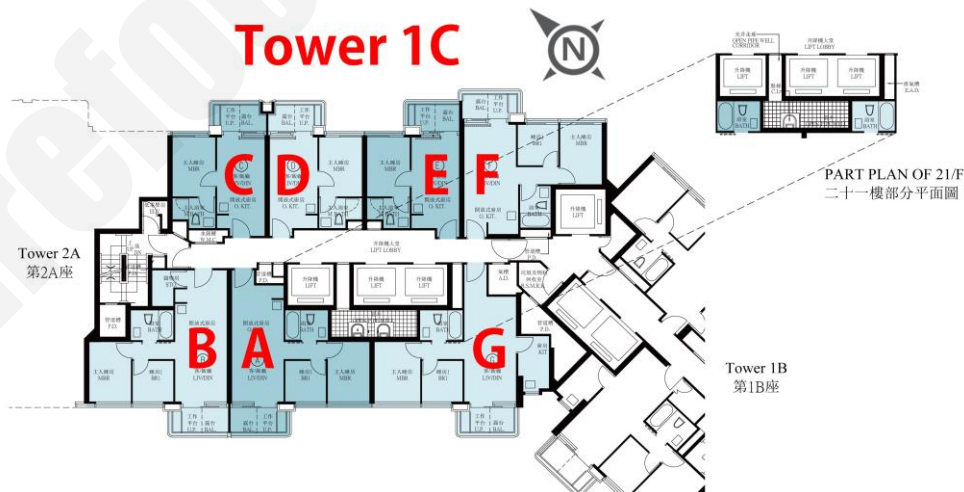

紅色為最高售價、最高平均呎價；藍色為最低售價、最低平均呎價

以上的物業資料只供參考，一切以發展商最新公布為準，如有任何資料錯漏本網頁不會承擔任何責任。