

# 新盤價單表

## 激晨 II

### 價單1號

以最高20%折扣計算

制作日期: 2025-07-21

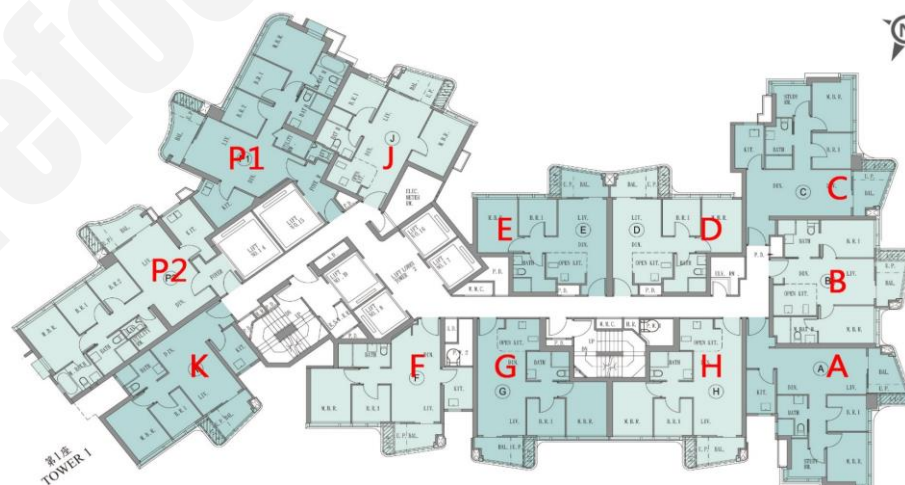

B : 2房 497/509'		
樓層	訂價	折實價20%
5	\$13,217,000 @\$25,967	\$10,573,600 @\$20,773
6	\$13,323,000 @\$26,175	\$10,658,400 @\$20,940
7	\$13,113,000 @\$26,384	\$10,490,400 @\$21,107
8	\$13,218,000 @\$26,596	\$10,574,400 @\$21,276
9	\$13,284,000 @\$26,728	\$10,627,200 @\$21,383
10	\$13,350,000 @\$26,861	\$10,680,000 @\$21,489

D : 2房 448'		
樓層	訂價	折實價20%
6	\$10,900,000 @\$24,330	\$8,720,000 @\$19,464
7	\$10,987,000 @\$24,525	\$8,789,600 @\$19,620
8	\$11,075,000 @\$24,721	\$8,860,000 @\$19,777
9	\$11,130,000 @\$24,844	\$8,904,000 @\$19,875
10	\$11,186,000 @\$24,969	\$8,948,800 @\$19,975
11	\$11,242,000 @\$25,094	\$8,993,600 @\$20,075
12	\$11,298,000 @\$25,219	\$9,038,400 @\$20,175
15	\$11,354,000 @\$25,344	\$9,083,200 @\$20,275
16	\$11,411,000 @\$25,471	\$9,128,800 @\$20,377
17	\$11,468,000 @\$25,598	\$9,174,400 @\$20,479
18	\$11,525,000 @\$25,725	\$9,220,000 @\$20,580
19	\$11,583,000 @\$25,855	\$9,266,400 @\$20,684
20	\$11,641,000 @\$25,984	\$9,312,800 @\$20,788
21	\$11,699,000 @\$26,114	\$9,359,200 @\$20,891
22	\$11,758,000 @\$26,246	\$9,406,400 @\$20,996
23	\$11,816,000 @\$26,375	\$9,452,800 @\$21,100
25	\$11,876,000 @\$26,509	\$9,500,800 @\$21,207
26	\$11,959,000 @\$26,694	\$9,567,200 @\$21,355
27	\$12,042,000 @\$26,879	\$9,633,600 @\$21,504
28	\$12,127,000 @\$27,069	\$9,701,600 @\$21,655
29	\$12,212,000 @\$27,259	\$9,769,600 @\$21,807
30	\$12,297,000 @\$27,449	\$9,837,600 @\$21,959

H : 2房 498/505'		
樓層	訂價	折實價20%
6	\$12,461,000 @\$24,675	\$9,968,800 @\$19,740
7	\$12,387,000 @\$24,873	\$9,909,600 @\$19,899
8	\$12,486,000 @\$25,072	\$9,988,800 @\$20,058
9	\$12,548,000 @\$25,197	\$10,038,400 @\$20,157
10	\$12,611,000 @\$25,323	\$10,088,800 @\$20,259
11	\$12,674,000 @\$25,450	\$10,139,200 @\$20,360
12	\$12,737,000 @\$25,576	\$10,189,600 @\$20,461
15	\$12,801,000 @\$25,705	\$10,240,800 @\$20,564
16	\$12,865,000 @\$25,833	\$10,292,000 @\$20,667
17	\$12,929,000 @\$25,962	\$10,343,200 @\$20,769
18	\$12,994,000 @\$26,092	\$10,395,200 @\$20,874
19	\$13,059,000 @\$26,223	\$10,447,200 @\$20,978
20	\$13,124,000 @\$26,353	\$10,499,200 @\$21,083
21	\$13,190,000 @\$26,486	\$10,552,000 @\$21,189
22	\$13,256,000 @\$26,618	\$10,604,800 @\$21,295
23	\$13,322,000 @\$26,751	\$10,657,600 @\$21,401
25	\$13,389,000 @\$26,886	\$10,711,200 @\$21,508

K : 2房 507'		
樓層	訂價	折實價20%
6	\$13,212,000 @\$26,059	\$10,569,600 @\$20,847
7	\$13,318,000 @\$26,268	\$10,654,400 @\$21,015
8	\$13,424,000 @\$26,477	\$10,739,200 @\$21,182
9	\$13,491,000 @\$26,609	\$10,792,800 @\$21,288
10	\$13,559,000 @\$26,744	\$10,847,200 @\$21,395
11	\$13,626,000 @\$26,876	\$10,900,800 @\$21,501
12	\$13,695,000 @\$27,012	\$10,956,000 @\$21,609
15	\$13,763,000 @\$27,146	\$11,010,400 @\$21,717
16	\$13,832,000 @\$27,282	\$11,065,600 @\$21,826
17	\$13,901,000 @\$27,418	\$11,120,800 @\$21,935
18	\$13,970,000 @\$27,554	\$11,176,000 @\$22,043
19	\$14,040,000 @\$27,692	\$11,232,000 @\$22,154
20	\$14,111,000 @\$27,832	\$11,288,800 @\$22,266
21	\$14,181,000 @\$27,970	\$11,344,800 @\$22,376
22	\$14,252,000 @\$28,110	\$11,401,600 @\$22,488
23	\$14,323,000 @\$28,250	\$11,458,400 @\$22,600
25	\$14,395,000 @\$28,393	\$11,516,000 @\$22,714

A : 2房 586'		
樓層	訂價	折實價20%
7	\$15,474,000 @\$26,406	\$12,379,200 @\$21,125
8	\$15,598,000 @\$26,618	\$12,478,400 @\$21,294
9	\$15,676,000 @\$26,751	\$12,540,800 @\$21,401
10	\$15,754,000 @\$26,884	\$12,603,200 @\$21,507
11	\$15,833,000 @\$27,019	\$12,666,400 @\$21,615
12	\$15,912,000 @\$27,154	\$12,729,600 @\$21,723
15	\$15,992,000 @\$27,290	\$12,793,600 @\$21,832
16	\$16,072,000 @\$27,427	\$12,857,600 @\$21,941
17	\$16,152,000 @\$27,563	\$12,921,600 @\$22,051
18	\$16,233,000 @\$27,701	\$12,986,400 @\$22,161
19	\$16,314,000 @\$27,840	\$13,051,200 @\$22,272
20	\$16,396,000 @\$27,980	\$13,116,800 @\$22,384

P1 : 3房 778'		
樓層	訂價	折實價20%
15	\$25,981,000 @\$33,395	\$20,784,800 @\$26,716
16	\$26,189,000 @\$33,662	\$20,951,200 @\$26,930
17	\$26,398,000 @\$33,931	\$21,118,400 @\$27,144

P2 : 3房 759'		
樓層	訂價	折實價20%
15	\$24,997,000 @\$32,934	\$19,997,600 @\$26,347
16	\$25,197,000 @\$33,198	\$20,157,600 @\$26,558
17	\$25,399,000 @\$33,464	\$20,319,200 @\$26,771

紅色為最高售價、最高平均呎價；藍色為最低售價、最低平均呎價

以上的物業資料只供參考，一切以發展商最新公布為準，如有任何資料錯漏本網頁不會承擔任何責任。