

T1 B : 2房 474'		
樓層	訂價	折實價15%
3	\$6,132,000 @\$12,937	\$5,212,200 @\$10,996
6	\$6,155,000 @\$12,985	\$5,231,750 @\$11,037
7	\$6,167,000 @\$13,011	\$5,241,950 @\$11,059
8	\$6,191,000 @\$13,061	\$5,262,350 @\$11,102
9	\$6,191,000 @\$13,061	\$5,262,350 @\$11,102
10	\$6,202,000 @\$13,084	\$5,271,700 @\$11,122
11	\$6,215,000 @\$13,112	\$5,282,750 @\$11,145
12	\$6,227,000 @\$13,137	\$5,292,950 @\$11,167
T1 D : 2房 380'/383'		
樓層	訂價	折實價15%
3	\$5,326,000 @\$13,906	\$4,527,100 @\$11,820
6	\$5,346,000 @\$13,958	\$4,544,100 @\$11,864
7	\$5,356,000 @\$13,984	\$4,552,600 @\$11,887
9	\$5,378,000 @\$14,042	\$4,571,300 @\$11,936
10	\$5,387,000 @\$14,065	\$4,578,950 @\$11,955
15	\$5,419,000 @\$14,149	\$4,606,150 @\$12,027
17	\$5,440,000 @\$14,204	\$4,624,000 @\$12,073
20	\$5,460,000 @\$14,256	\$4,641,000 @\$12,117
22	\$5,489,000 @\$14,332	\$4,665,650 @\$12,182
25	\$5,518,000 @\$14,407	\$4,690,300 @\$12,246
26	\$5,532,000 @\$14,444	\$4,702,200 @\$12,277
29	\$5,575,000 @\$14,556	\$4,738,750 @\$12,373
30	\$5,589,000 @\$14,593	\$4,750,650 @\$12,404
32	\$5,619,000 @\$14,671	\$4,776,150 @\$12,470
33	\$5,622,000 @\$14,795	\$4,778,700 @\$12,576

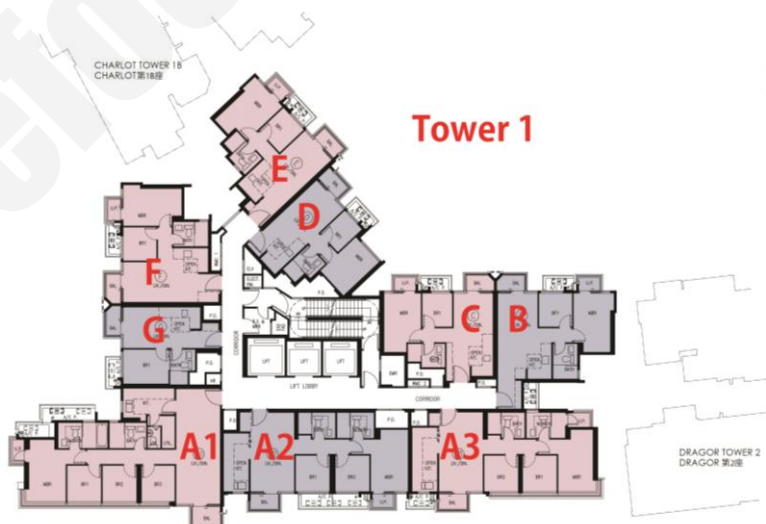

T1 E : 2房 431'		
樓層	訂價	折實價15%
3	\$5,764,000 @\$13,374	\$4,899,400 @\$11,368
6	\$5,786,000 @\$13,425	\$4,918,100 @\$11,411
7	\$5,796,000 @\$13,448	\$4,926,600 @\$11,431
9	\$5,819,000 @\$13,501	\$4,946,150 @\$11,476
10	\$5,831,000 @\$13,529	\$4,956,350 @\$11,500
12	\$5,853,000 @\$13,580	\$4,975,050 @\$11,543
15	\$5,864,000 @\$13,606	\$4,984,400 @\$11,565
17	\$5,887,000 @\$13,659	\$5,003,950 @\$11,610
18	\$5,909,000 @\$13,710	\$5,022,650 @\$11,653
21	\$5,925,000 @\$13,747	\$5,036,250 @\$11,685
22	\$5,940,000 @\$13,782	\$5,049,000 @\$11,715
25	\$5,971,000 @\$13,854	\$5,075,350 @\$11,776
26	\$5,987,000 @\$13,891	\$5,088,950 @\$11,807
28	\$6,033,000 @\$13,998	\$5,128,050 @\$11,898
29	\$6,033,000 @\$13,998	\$5,128,050 @\$11,898
31	\$6,065,000 @\$14,072	\$5,155,250 @\$11,961
32	\$6,080,000 @\$14,107	\$5,168,000 @\$11,991

T1 G : 1房 306'		
樓層	訂價	折實價15%
3	\$4,408,000 @\$14,405	\$3,746,800 @\$12,244
8	\$4,452,000 @\$14,549	\$3,784,200 @\$12,367
9	\$4,452,000 @\$14,549	\$3,784,200 @\$12,367
10	\$4,460,000 @\$14,575	\$3,791,000 @\$12,389
11	\$4,468,000 @\$14,601	\$3,797,800 @\$12,411
12	\$4,476,000 @\$14,627	\$3,804,600 @\$12,433
15	\$4,486,000 @\$14,660	\$3,813,100 @\$12,461
16	\$4,494,000 @\$14,686	\$3,819,900 @\$12,483
17	\$4,504,000 @\$14,719	\$3,828,400 @\$12,511
18	\$4,520,000 @\$14,771	\$3,842,000 @\$12,556
20	\$4,520,000 @\$14,771	\$3,842,000 @\$12,556
21	\$4,532,000 @\$14,810	\$3,852,200 @\$12,589

新盤價單表

Novoland 3A期

價單1號

以最高15%折扣計算

制作日期: 2025-06-25



T2 A1 : 3房連套房 474'		
樓層	訂價	折實價15%
3	\$8,712,000 @\$12,718	\$7,405,200 @\$10,811
6	\$8,739,000 @\$12,758	\$7,428,150 @\$10,844
7	\$8,752,000 @\$12,777	\$7,439,200 @\$10,860
9	\$8,779,000 @\$12,816	\$7,462,150 @\$10,894
10	\$8,793,000 @\$12,836	\$7,474,050 @\$10,911
12	\$8,820,000 @\$12,876	\$7,497,000 @\$10,945
15	\$8,833,000 @\$12,895	\$7,508,050 @\$10,961
17	\$8,860,000 @\$12,934	\$7,531,000 @\$10,994
20	\$8,887,000 @\$12,974	\$7,553,950 @\$11,028
22	\$8,925,000 @\$13,029	\$7,586,250 @\$11,075
23	\$8,944,000 @\$13,057	\$7,602,400 @\$11,098
26	\$8,980,000 @\$13,109	\$7,633,000 @\$11,143
27	\$8,999,000 @\$13,137	\$7,649,150 @\$11,167
29	\$9,049,000 @\$13,191	\$7,691,650 @\$11,212
30	\$9,068,000 @\$13,219	\$7,707,800 @\$11,236
32	\$9,106,000 @\$13,274	\$7,740,100 @\$11,283
33	\$9,125,000 @\$13,302	\$7,756,250 @\$11,306

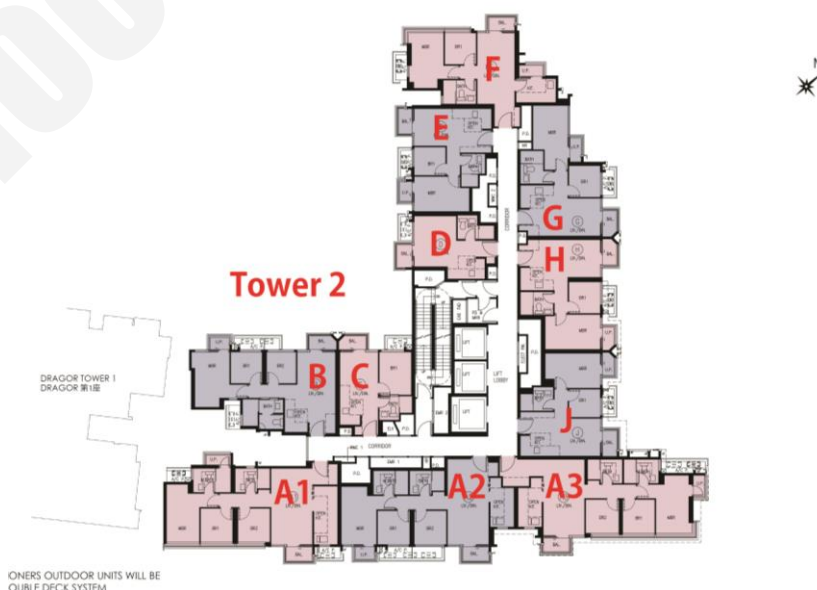

T2 B : 3房 544'		
樓層	訂價	折實價15%
3	\$7,153,000 @\$13,149	\$6,080,050 @\$11,177
8	\$7,221,000 @\$13,274	\$6,137,850 @\$11,283
9	\$7,221,000 @\$13,274	\$6,137,850 @\$11,283
11	\$7,249,000 @\$13,325	\$6,161,650 @\$11,327
12	\$7,264,000 @\$13,353	\$6,174,400 @\$11,350
16	\$7,292,000 @\$13,404	\$6,198,200 @\$11,394
18	\$7,333,000 @\$13,480	\$6,233,050 @\$11,458

T2 F : 2房 494'		
樓層	訂價	折實價15%
3	\$6,592,000 @\$13,344	\$5,603,200 @\$11,343
6	\$6,618,000 @\$13,397	\$5,625,300 @\$11,387
7	\$6,629,000 @\$13,419	\$5,634,650 @\$11,406
9	\$6,655,000 @\$13,472	\$5,656,750 @\$11,451
10	\$6,668,000 @\$13,498	\$5,667,800 @\$11,473
11	\$6,681,000 @\$13,524	\$5,678,850 @\$11,496

T2 D : 開放式 259'		
樓層	訂價	折實價15%
3	\$3,528,000 @\$13,622	\$2,998,800 @\$11,578
8	\$3,572,000 @\$13,792	\$3,036,200 @\$11,723
9	\$3,572,000 @\$13,792	\$3,036,200 @\$11,723
10	\$3,581,000 @\$13,826	\$3,043,850 @\$11,752
15	\$3,606,000 @\$13,923	\$3,065,100 @\$11,834
16	\$3,613,000 @\$13,950	\$3,071,050 @\$11,857
20	\$3,635,000 @\$14,035	\$3,089,750 @\$11,930

T2 G : 2房 446'		
樓層	訂價	折實價15%
3	\$5,489,000 @\$12,307	\$4,665,650 @\$10,461
6	\$5,511,000 @\$12,357	\$4,684,350 @\$10,503
8	\$5,542,000 @\$12,426	\$4,710,700 @\$10,562
9	\$5,542,000 @\$12,426	\$4,710,700 @\$10,562
11	\$5,564,000 @\$12,475	\$4,729,400 @\$10,604
15	\$5,586,000 @\$12,525	\$4,748,100 @\$10,646
16	\$5,596,000 @\$12,547	\$4,756,600 @\$10,665
18	\$5,628,000 @\$12,619	\$4,783,800 @\$10,726
20	\$5,628,000 @\$12,619	\$4,783,800 @\$10,726
21	\$5,644,000 @\$12,655	\$4,797,400 @\$10,757
22	\$5,658,000 @\$12,686	\$4,809,300 @\$10,783
25	\$5,687,000 @\$12,751	\$4,833,950 @\$10,838
26	\$5,702,000 @\$12,785	\$4,846,700 @\$10,867
27	\$5,716,000 @\$12,816	\$4,858,600 @\$10,894
28	\$5,747,000 @\$12,886	\$4,884,950 @\$10,953
30	\$5,761,000 @\$12,917	\$4,896,850 @\$10,979
31	\$5,776,000 @\$12,951	\$4,909,600 @\$11,008
32	\$5,792,000 @\$12,987	\$4,923,200 @\$11,039
33	\$5,807,000 @\$13,020	\$4,935,950 @\$11,067

紅色為最高售價、最高平均呎價；藍色為最低售價、最低平均呎價。
以上的物業資料只供參考，一切以發展商最新公布為準，如有任何資料錯漏本網頁不會承擔任何責任。