

新盤價單表

Sierra Sea 1B期

價單1號

以最高15%折扣計算

制作日期: 2025-05-08



1座B: 3房 807'		
樓層	訂價	折實價15%
G2	\$10,867,000 @\$13,466	\$9,236,950 @\$11,446
1	\$11,009,000 @\$13,642	\$9,357,650 @\$11,598

2座GF: 2房 444'		
樓層	訂價	折實價15%
G2	\$4,968,000 @\$11,189	\$4,222,800 @\$9,511
3	\$5,167,000 @\$11,637	\$4,391,950 @\$9,892
5	\$5,227,000 @\$11,773	\$4,442,950 @\$10,007
6	\$5,279,000 @\$11,890	\$4,487,150 @\$10,106
7	\$5,327,000 @\$11,998	\$4,527,950 @\$10,198
8	\$5,425,000 @\$12,218	\$4,611,250 @\$10,386
9	\$5,425,000 @\$12,218	\$4,611,250 @\$10,386
10	\$5,473,000 @\$12,327	\$4,652,050 @\$10,478
11	\$5,522,000 @\$12,437	\$4,693,700 @\$10,571
12	\$5,573,000 @\$12,552	\$4,737,050 @\$10,669
15	\$5,622,000 @\$12,662	\$4,778,700 @\$10,763
16	\$5,673,000 @\$12,777	\$4,822,050 @\$10,860

2座H: 2房 444'		
樓層	訂價	折實價15%
G2	\$4,968,000 @\$11,189	\$4,222,800 @\$9,511
3	\$5,167,000 @\$11,637	\$4,391,950 @\$9,892
5	\$5,227,000 @\$11,773	\$4,442,950 @\$10,007
6	\$5,279,000 @\$11,890	\$4,487,150 @\$10,106
7	\$5,327,000 @\$11,998	\$4,527,950 @\$10,198
8	\$5,425,000 @\$12,218	\$4,611,250 @\$10,386
9	\$5,425,000 @\$12,218	\$4,611,250 @\$10,386
10	\$5,473,000 @\$12,327	\$4,652,050 @\$10,478
11	\$5,522,000 @\$12,437	\$4,693,700 @\$10,571
12	\$5,573,000 @\$12,552	\$4,737,050 @\$10,669
15	\$5,622,000 @\$12,662	\$4,778,700 @\$10,763
16	\$5,673,000 @\$12,777	\$4,822,050 @\$10,860

2座J: 1房 302'		
樓層	訂價	折實價15%
G2	\$3,753,000 @\$12,427	\$3,190,050 @\$10,563
5	\$3,926,000 @\$13,000	\$3,337,100 @\$11,050
6	\$3,958,000 @\$13,106	\$3,364,300 @\$11,140
7	\$3,989,000 @\$13,209	\$3,390,650 @\$11,227

Tower1

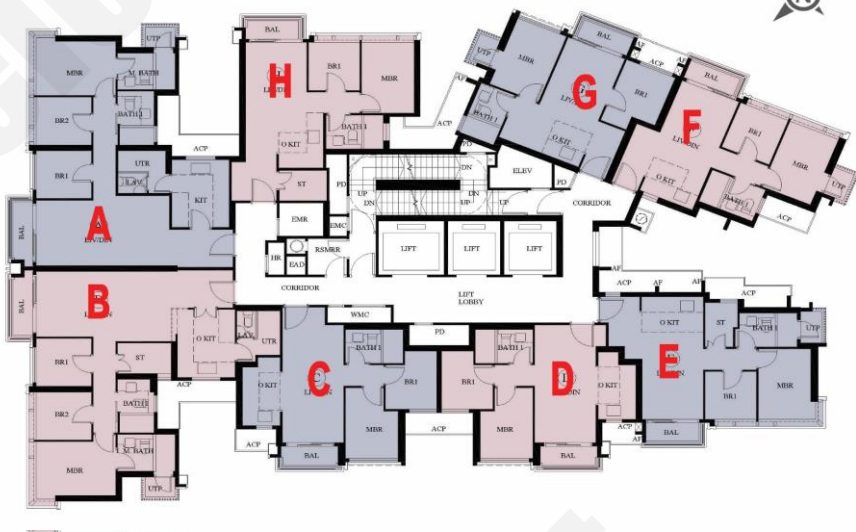

Tower2

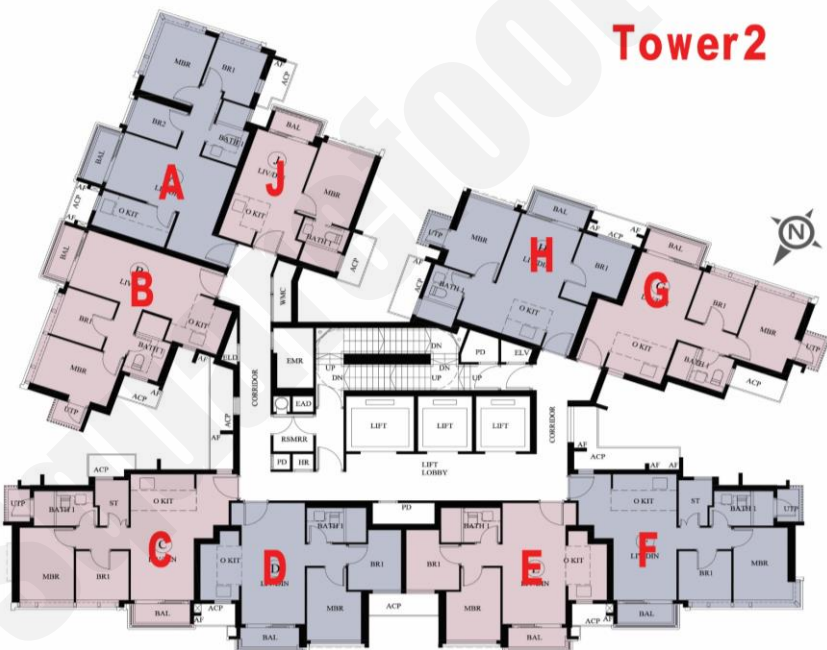

紅色為最高售價、最高平均呎價；藍色為最低售價、最低平均呎價

以上的物業資料只供參考，一切以發展商最新公布為準，如有任何資料錯漏本網頁不會承擔任何責任。

新盤價單表

Sierra Sea 1B期

價單1號

以最高15%折扣計算

制作日期: 2025-05-08



Tower 3

3座E: 2房 434'		
樓層	訂價	折實價15%
1	\$5,227,000 @\$12,044	\$4,442,950 @\$10,237
2	\$5,274,000 @\$12,152	\$4,482,900 @\$10,329
3	\$5,322,000 @\$12,263	\$4,523,700 @\$10,423
5	\$5,371,000 @\$12,376	\$4,565,350 @\$10,519
6	\$5,420,000 @\$12,488	\$4,607,000 @\$10,615
7	\$5,469,000 @\$12,601	\$4,648,650 @\$10,711
8	\$5,569,000 @\$12,832	\$4,733,650 @\$10,907
9	\$5,569,000 @\$12,832	\$4,733,650 @\$10,907
10	\$5,620,000 @\$12,949	\$4,777,000 @\$11,007
11	\$5,681,000 @\$13,090	\$4,828,850 @\$11,126
12	\$5,744,000 @\$13,235	\$4,882,400 @\$11,250
15	\$5,807,000 @\$13,380	\$4,935,950 @\$11,373

3座F: 2房 492'		
樓層	訂價	折實價15%
1	\$5,884,000 @\$11,959	\$5,001,400 @\$10,165
2	\$5,954,000 @\$12,102	\$5,060,900 @\$10,286
3	\$6,014,000 @\$12,224	\$5,111,900 @\$10,390
5	\$6,069,000 @\$12,335	\$5,158,650 @\$10,485
6	\$6,125,000 @\$12,449	\$5,206,250 @\$10,582
7	\$6,180,000 @\$12,561	\$5,253,000 @\$10,677
8	\$6,293,000 @\$12,791	\$5,349,050 @\$10,872
9	\$6,293,000 @\$12,791	\$5,349,050 @\$10,872
10	\$6,351,000 @\$12,909	\$5,398,350 @\$10,972
11	\$6,407,000 @\$13,022	\$5,445,950 @\$11,069
12	\$6,465,000 @\$13,140	\$5,495,250 @\$11,169
15	\$6,524,000 @\$13,260	\$5,545,400 @\$11,271
17	\$6,582,000 @\$13,378	\$5,594,700 @\$11,371
18	\$6,701,000 @\$13,620	\$5,695,850 @\$11,577

3座G: 2房 444'		
樓層	訂價	折實價15%
G2	\$5,095,000 @\$11,475	\$4,330,750 @\$9,754
1	\$5,173,000 @\$11,651	\$4,397,050 @\$9,903
2	\$5,246,000 @\$11,815	\$4,459,100 @\$10,043
3	\$5,315,000 @\$11,971	\$4,517,750 @\$10,175
5	\$5,380,000 @\$12,117	\$4,573,000 @\$10,300
6	\$5,428,000 @\$12,225	\$4,613,800 @\$10,391
7	\$5,478,000 @\$12,338	\$4,656,300 @\$10,487
8	\$5,579,000 @\$12,565	\$4,742,150 @\$10,681
9	\$5,579,000 @\$12,565	\$4,742,150 @\$10,681
10	\$5,629,000 @\$12,678	\$4,784,650 @\$10,776
11	\$5,680,000 @\$12,793	\$4,828,000 @\$10,874
12	\$5,731,000 @\$12,908	\$4,871,350 @\$10,972
15	\$5,782,000 @\$13,023	\$4,914,700 @\$11,069
17	\$5,834,000 @\$13,140	\$4,958,900 @\$11,169
18	\$5,940,000 @\$13,378	\$5,049,000 @\$11,372
19	\$5,940,000 @\$13,378	\$5,049,000 @\$11,372
20	\$6,005,000 @\$13,525	\$5,104,250 @\$11,496

3座A: 3房 523'		
樓層	訂價	折實價15%
G2	\$6,319,000 @\$12,082	\$5,371,150 @\$10,270
3	\$6,558,000 @\$12,539	\$5,574,300 @\$10,658
5	\$6,618,000 @\$12,654	\$5,625,300 @\$10,756
8	\$6,862,000 @\$13,120	\$5,832,700 @\$11,152
9	\$6,862,000 @\$13,120	\$5,832,700 @\$11,152
10	\$6,925,000 @\$13,241	\$5,886,250 @\$11,255
11	\$6,987,000 @\$13,359	\$5,938,950 @\$11,356

3座J: 1房 302'		
樓層	訂價	折實價15%
G2	\$3,530,000 @\$11,689	\$3,000,500 @\$9,935
3	\$3,856,000 @\$12,768	\$3,277,600 @\$10,853
5	\$3,929,000 @\$13,010	\$3,339,650 @\$11,058

3座H: 2房 444'		
樓層	訂價	折實價15%
G2	\$4,962,000 @\$11,176	\$4,217,700 @\$9,499
3	\$5,251,000 @\$11,827	\$4,463,350 @\$10,053
5	\$5,325,000 @\$11,993	\$4,526,250 @\$10,194
6	\$5,384,000 @\$12,126	\$4,576,400 @\$10,307
7	\$5,442,000 @\$12,257	\$4,625,700 @\$10,418
8	\$5,562,000 @\$12,527	\$4,727,700 @\$10,648
9	\$5,562,000 @\$12,527	\$4,727,700 @\$10,648
10	\$5,622,000 @\$12,662	\$4,778,700 @\$10,763
11	\$5,673,000 @\$12,777	\$4,822,050 @\$10,860
12	\$5,725,000 @\$12,894	\$4,866,250 @\$10,960
15	\$5,775,000 @\$13,007	\$4,908,750 @\$11,056
17	\$5,828,000 @\$13,126	\$4,953,800 @\$11,157

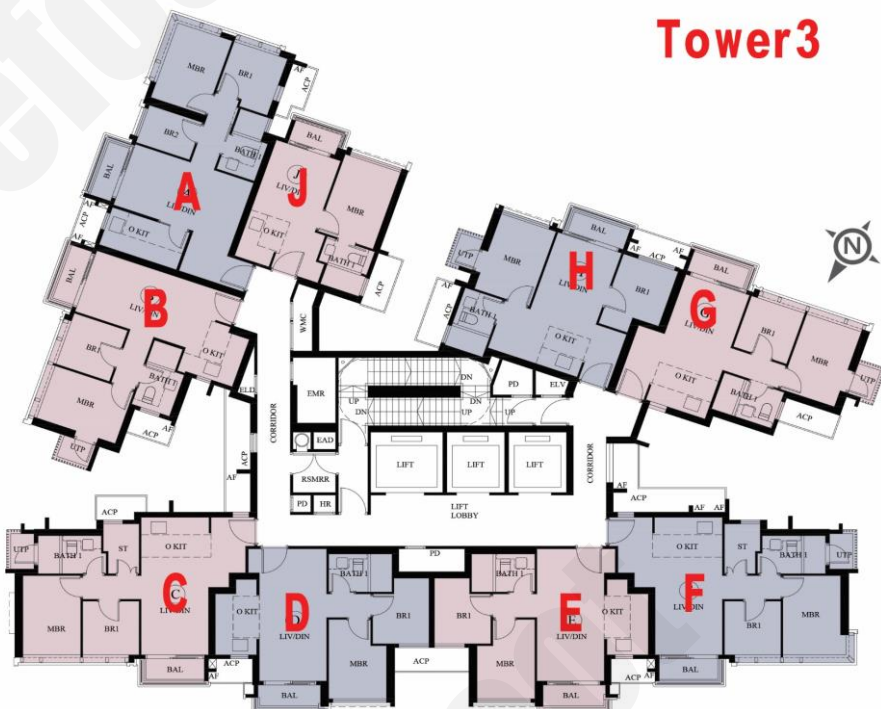

紅色為最高售價、最高平均呎價；藍色為最低售價、最低平均呎價

以上的物業資料只供參考，一切以發展商最新公布為準，如有任何資料錯漏本網頁不會承擔任何責任。

新盤價單表

Sierra Sea 1B期

價單1號

以最高15%折扣計算

制作日期: 2025-05-08



Tower 5

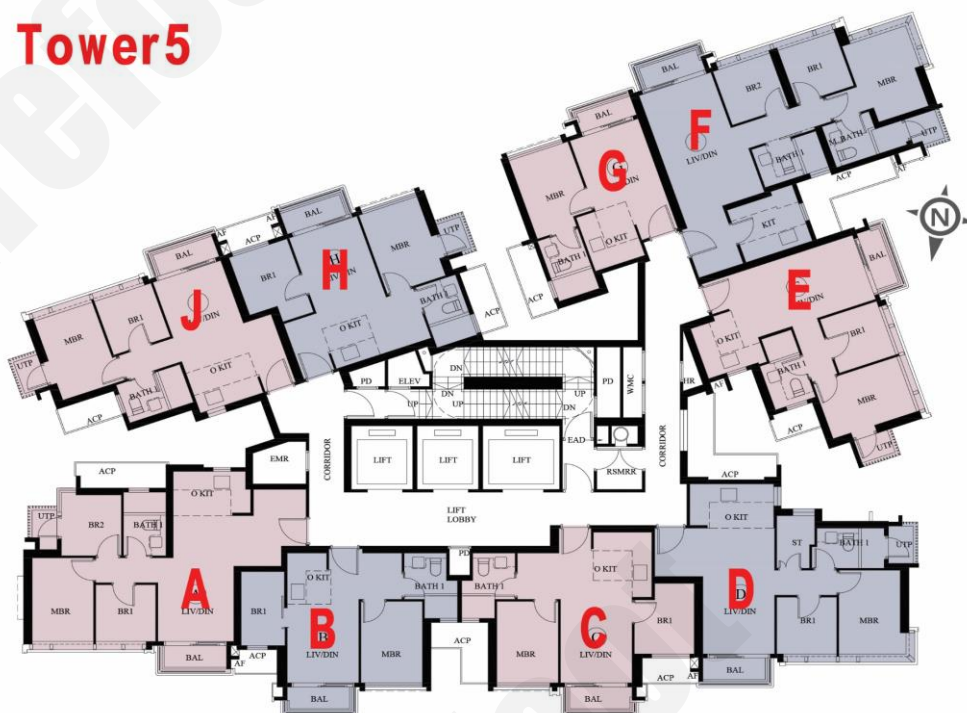

5座A: 3房 571'		
樓層	訂價	折實價15%
1	\$6,451,000 @\$11,298	\$5,483,350 @\$9,603
5	\$6,655,000 @\$11,655	\$5,656,750 @\$9,907
6	\$6,715,000 @\$11,760	\$5,707,750 @\$9,996
8	\$6,901,000 @\$12,086	\$5,865,850 @\$10,273
9	\$6,901,000 @\$12,086	\$5,865,850 @\$10,273
10	\$6,964,000 @\$12,196	\$5,919,400 @\$10,367
11	\$7,026,000 @\$12,305	\$5,972,100 @\$10,459
12	\$7,089,000 @\$12,415	\$6,025,650 @\$10,553
15	\$7,153,000 @\$12,527	\$6,080,050 @\$10,648

5座B: 1房 381'		
樓層	訂價	折實價15%
1	\$4,621,000 @\$12,129	\$3,927,850 @\$10,309
5	\$4,748,000 @\$12,462	\$4,035,800 @\$10,593
6	\$4,792,000 @\$12,577	\$4,073,200 @\$10,691
7	\$4,835,000 @\$12,690	\$4,109,750 @\$10,787
8	\$4,924,000 @\$12,924	\$4,185,400 @\$10,985
9	\$4,924,000 @\$12,924	\$4,185,400 @\$10,985
10	\$4,968,000 @\$13,039	\$4,222,800 @\$11,083
11	\$5,013,000 @\$13,157	\$4,261,050 @\$11,184
12	\$5,059,000 @\$13,278	\$4,300,150 @\$11,286
15	\$5,104,000 @\$13,396	\$4,338,400 @\$11,387
17	\$5,149,000 @\$13,514	\$4,376,650 @\$11,487
18	\$5,242,000 @\$13,759	\$4,455,700 @\$11,695

5座F: 3房 653'		
樓層	訂價	折實價15%
G2	\$7,782,000 @\$11,917	\$6,614,700 @\$10,130
3	\$8,119,000 @\$12,433	\$6,901,150 @\$10,568
5	\$8,218,000 @\$12,585	\$6,985,300 @\$10,697
6	\$8,309,000 @\$12,724	\$7,062,650 @\$10,816
7	\$8,385,000 @\$12,841	\$7,127,250 @\$10,915
8	\$8,538,000 @\$13,075	\$7,257,300 @\$11,114
9	\$8,538,000 @\$13,075	\$7,257,300 @\$11,114

5座C: 2房 433'/435'		
樓層	訂價	折實價15%
G2	\$5,096,000 @\$11,715	\$4,331,600 @\$9,958
3	\$5,245,000 @\$12,113	\$4,458,250 @\$10,296
5	\$5,292,000 @\$12,222	\$4,498,200 @\$10,388
6	\$5,340,000 @\$12,333	\$4,539,000 @\$10,483
7	\$5,388,000 @\$12,443	\$4,579,800 @\$10,577
8	\$5,487,000 @\$12,672	\$4,663,950 @\$10,771
9	\$5,487,000 @\$12,672	\$4,663,950 @\$10,771
10	\$5,538,000 @\$12,790	\$4,707,300 @\$10,871
11	\$5,598,000 @\$12,928	\$4,758,300 @\$10,989
12	\$5,660,000 @\$13,072	\$4,811,000 @\$11,111
15	\$5,722,000 @\$13,215	\$4,863,700 @\$11,233
17	\$5,785,000 @\$13,360	\$4,917,250 @\$11,356
18	\$5,912,000 @\$13,654	\$5,025,200 @\$11,606

5座D: 2房 519'		
樓層	訂價	折實價15%
G2	\$5,881,000 @\$11,331	\$4,998,850 @\$9,632
3	\$6,128,000 @\$11,807	\$5,208,800 @\$10,036
5	\$6,184,000 @\$11,915	\$5,256,400 @\$10,128
6	\$6,240,000 @\$12,023	\$5,304,000 @\$10,220
7	\$6,296,000 @\$12,131	\$5,351,600 @\$10,311
8	\$6,412,000 @\$12,355	\$5,450,200 @\$10,501
9	\$6,412,000 @\$12,355	\$5,450,200 @\$10,501
10	\$6,469,000 @\$12,464	\$5,498,650 @\$10,595
11	\$6,528,000 @\$12,578	\$5,548,800 @\$10,691
12	\$6,587,000 @\$12,692	\$5,598,950 @\$10,788
15	\$6,646,000 @\$12,805	\$5,649,100 @\$10,885
17	\$6,707,000 @\$12,923	\$5,700,950 @\$10,984
18	\$6,827,000 @\$13,154	\$5,802,950 @\$11,181

5座E: 2房 461'		
樓層	訂價	折實價15%
G2	\$5,175,000 @\$11,226	\$4,398,750 @\$9,542
3	\$5,400,000 @\$11,714	\$4,590,000 @\$9,957
5	\$5,459,000 @\$11,842	\$4,640,150 @\$10,065
6	\$5,508,000 @\$11,948	\$4,681,800 @\$10,156
7	\$5,548,000 @\$12,035	\$4,715,800 @\$10,230
8	\$5,629,000 @\$12,210	\$4,784,650 @\$10,379
9	\$5,629,000 @\$12,210	\$4,784,650 @\$10,379
10	\$5,669,000 @\$12,297	\$4,818,650 @\$10,453
11	\$5,721,000 @\$12,410	\$4,862,850 @\$10,548
12	\$5,772,000 @\$12,521	\$4,906,200 @\$10,643
15	\$5,825,000 @\$12,636	\$4,951,250 @\$10,740

紅色為最高售價、最高平均呎價；藍色為最低售價、最低平均呎價

以上的物業資料只供參考，一切以發展商最新公布為準，如有任何資料錯漏本網頁不會承擔任何責任。