

# 新盤價單表

Yoho West Parkside

價單1號

以最高5%折扣加現金回贈4%計算

制作日期: 2025-02-26



A1 : 3房 679'		
樓層	訂價	折實價5%加現金回贈4%
5	\$8,162,000 @\$12,021	\$7,443,744 @\$10,963
6	\$8,186,500 @\$12,057	\$7,466,088 @\$10,996
7	\$8,211,200 @\$12,093	\$7,488,614 @\$11,029
8	\$8,235,900 @\$12,129	\$7,511,141 @\$11,062
9	\$8,260,600 @\$12,166	\$7,533,667 @\$11,095
10	\$8,285,500 @\$12,203	\$7,556,376 @\$11,129
11	\$8,310,400 @\$12,239	\$7,579,085 @\$11,162
12	\$8,335,400 @\$12,276	\$7,601,885 @\$11,196
35	\$11,410,900 @\$16,805	\$10,406,741 @\$15,327
A2 : 3房 521'		
樓層	訂價	折實價5%加現金回贈4%
5	\$6,143,800 @\$11,792	\$5,603,146 @\$10,755
6	\$6,162,200 @\$11,828	\$5,619,926 @\$10,787
7	\$6,180,800 @\$11,863	\$5,636,890 @\$10,819
8	\$6,199,300 @\$11,899	\$5,653,762 @\$10,852
9	\$6,218,100 @\$11,935	\$5,670,907 @\$10,885
10	\$6,236,700 @\$11,971	\$5,687,870 @\$10,917
11	\$6,255,600 @\$12,007	\$5,705,107 @\$10,950
12	\$6,274,300 @\$12,043	\$5,722,162 @\$10,983
45	\$8,923,400 @\$17,127	\$8,138,141 @\$15,620
B1 : 3房 592'		
樓層	訂價	折實價5%加現金回贈4%
5	\$6,972,500 @\$11,778	\$6,358,920 @\$10,741
6	\$6,993,400 @\$11,813	\$6,377,981 @\$10,774
7	\$7,014,500 @\$11,849	\$6,397,224 @\$10,806
8	\$7,035,500 @\$11,884	\$6,416,376 @\$10,838
9	\$7,056,800 @\$11,920	\$6,435,802 @\$10,871
10	\$7,078,000 @\$11,956	\$6,455,136 @\$10,904
11	\$7,099,300 @\$11,992	\$6,474,562 @\$10,937
12	\$7,120,600 @\$12,028	\$6,493,987 @\$10,970

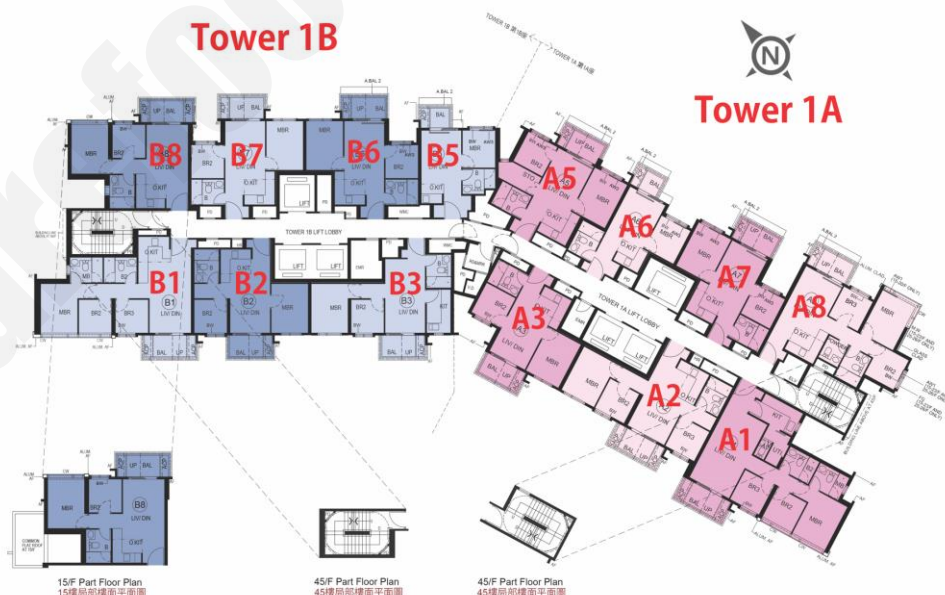

A3 : 2房 410'		
樓層	訂價	折實價5%加現金回贈4%
5	\$5,135,700 @\$12,526	\$4,683,758 @\$11,424
6	\$5,151,200 @\$12,564	\$4,697,894 @\$11,458
7	\$5,166,700 @\$12,602	\$4,712,030 @\$11,493
8	\$5,182,100 @\$12,639	\$4,726,075 @\$11,527
9	\$5,197,800 @\$12,678	\$4,740,394 @\$11,562
10	\$5,213,500 @\$12,716	\$4,754,712 @\$11,597
11	\$5,229,200 @\$12,754	\$4,769,030 @\$11,632
12	\$5,244,800 @\$12,792	\$4,783,258 @\$11,666
35	\$7,129,400 @\$17,389	\$6,502,013 @\$15,859
A6 : 1房 303'		
樓層	訂價	折實價5%加現金回贈4%
5	\$3,316,600 @\$10,946	\$3,024,739 @\$9,983
6	\$3,326,500 @\$10,979	\$3,033,768 @\$10,012
7	\$3,336,400 @\$11,011	\$3,042,797 @\$10,042
8	\$3,345,100 @\$11,040	\$3,050,731 @\$10,068
9	\$3,360,000 @\$11,089	\$3,064,320 @\$10,113
10	\$3,373,500 @\$11,134	\$3,076,632 @\$10,154
11	\$3,393,900 @\$11,201	\$3,095,237 @\$10,215
12	\$3,421,300 @\$11,291	\$3,120,226 @\$10,298
15	\$3,462,800 @\$11,428	\$3,158,074 @\$10,423
16	\$3,504,800 @\$11,567	\$3,196,378 @\$10,549
17	\$3,558,200 @\$11,743	\$3,245,078 @\$10,710
18	\$3,601,300 @\$11,885	\$3,284,386 @\$10,840
19	\$3,645,200 @\$12,030	\$3,324,422 @\$10,972
20	\$3,682,000 @\$12,152	\$3,357,984 @\$11,082

A5 : 2房 447'		
樓層	訂價	折實價5%加現金回贈4%
5	\$4,741,400 @\$10,607	\$4,324,157 @\$9,674
6	\$4,755,600 @\$10,639	\$4,337,107 @\$9,703
7	\$4,770,000 @\$10,671	\$4,350,240 @\$9,732
8	\$4,784,400 @\$10,703	\$4,363,373 @\$9,761
9	\$4,803,500 @\$10,746	\$4,380,792 @\$9,800
10	\$4,822,900 @\$10,789	\$4,398,485 @\$9,840
11	\$4,852,000 @\$10,855	\$4,425,024 @\$9,899
12	\$4,891,100 @\$10,942	\$4,460,683 @\$9,979
15	\$4,950,400 @\$11,075	\$4,514,765 @\$10,100
16	\$5,010,600 @\$11,209	\$4,569,667 @\$10,223
17	\$5,087,000 @\$11,380	\$4,639,344 @\$10,379
18	\$5,148,700 @\$11,518	\$4,695,614 @\$10,505
19	\$5,211,300 @\$11,658	\$4,752,706 @\$10,632
20	\$5,263,900 @\$11,776	\$4,800,677 @\$10,740
21	\$5,295,700 @\$11,847	\$5,030,915 @\$11,255
22	\$5,317,000 @\$11,895	\$5,051,150 @\$11,300
23	\$5,327,500 @\$11,918	\$5,061,125 @\$11,322
25	\$5,332,900 @\$11,930	\$5,066,255 @\$11,334
26	\$5,338,300 @\$11,943	\$5,071,385 @\$11,345
27	\$5,343,600 @\$11,954	\$5,076,420 @\$11,357
28	\$5,348,900 @\$11,966	\$5,081,455 @\$11,368
29	\$5,354,300 @\$11,978	\$5,086,585 @\$11,379
30	\$5,365,000 @\$12,002	\$5,096,750 @\$11,402
31	\$5,375,800 @\$12,026	\$5,107,010 @\$11,425
32	\$5,386,500 @\$12,050	\$5,117,175 @\$11,448
33	\$5,397,300 @\$12,074	\$5,127,435 @\$11,471
35	\$5,413,400 @\$12,111	\$5,142,730 @\$11,505
36	\$5,429,700 @\$12,147	\$5,158,215 @\$11,540

A7 : 2房 411'		
樓層	訂價	折實價5%加現金回贈4%
5	\$4,358,100 @\$10,604	\$3,974,587 @\$9,671
6	\$4,371,300 @\$10,636	\$3,986,626 @\$9,700
7	\$4,384,400 @\$10,668	\$3,998,573 @\$9,729
8	\$4,410,900 @\$10,732	\$4,022,741 @\$9,788
9	\$4,415,400 @\$10,743	\$4,026,845 @\$9,798
10	\$4,433,100 @\$10,786	\$4,042,987 @\$9,837
11	\$4,459,900 @\$10,851	\$4,067,429 @\$9,896
12	\$4,495,700 @\$10,938	\$4,100,078 @\$9,976
15	\$4,550,400 @\$11,072	\$4,149,965 @\$10,097
16	\$4,605,600 @\$11,206	\$4,200,307 @\$10,220
17	\$4,675,800 @\$11,377	\$4,264,330 @\$10,375
18	\$4,732,600 @\$11,515	\$4,316,131 @\$10,502
19	\$4,790,000 @\$11,655	\$4,368,480 @\$10,629
20	\$4,838,500 @\$11,773	\$4,412,712 @\$10,737
21	\$4,867,700 @\$11,844	\$4,624,315 @\$11,251
22	\$4,887,200 @\$11,891	\$4,642,840 @\$11,296
23	\$4,896,900 @\$11,915	\$4,652,055 @\$11,319
25	\$4,901,900 @\$11,927	\$4,656,805 @\$11,330
26	\$4,906,700 @\$11,938	\$4,661,365 @\$11,342
27	\$4,911,600 @\$11,950	\$4,666,020 @\$11,353
28	\$4,916,600 @\$11,963	\$4,670,770 @\$11,364
29	\$4,921,500 @\$11,974	\$4,675,425 @\$11,376
30	\$4,931,400 @\$11,999	\$4,684,830 @\$11,399
31	\$4,941,200 @\$12,022	\$4,694,140 @\$11,421
32	\$4,951,100 @\$12,046	\$4,703,545 @\$11,444
33	\$4,961,000 @\$12,071	\$4,712,950 @\$11,467
35	\$4,975,900 @\$12,107	\$4,727,105 @\$11,501
36	\$4,990,800 @\$12,143	\$4,741,260 @\$11,536

紅色為最高售價、最高平均呎價；藍色為最低售價、最低平均呎價  
以上的物業資料只供參考，一切以發展商最新公布為準，如有任何資料錯漏本網頁不會承擔任何責任。