

新盤價單表

黃金海灣珀岸

價單1號

以最高12%折扣計算

制作日期: 2025-01-07



第1座(1A) G: 1房 312'		
樓層	訂價	折實價12%
5	\$3,234,000 @\$10,365	\$2,845,920 @\$9,122
6	\$3,280,000 @\$10,513	\$2,886,400 @\$9,251
7	\$3,325,000 @\$10,657	\$2,926,000 @\$9,378
8	\$3,394,000 @\$10,878	\$2,966,720 @\$9,573
9	\$3,417,000 @\$10,952	\$3,006,960 @\$9,638
10	\$3,501,000 @\$11,221	\$3,080,880 @\$9,875
11	\$3,548,000 @\$11,372	\$3,122,240 @\$10,007
12	\$3,595,000 @\$11,522	\$3,163,600 @\$10,140
15	\$3,644,000 @\$11,679	\$3,206,720 @\$10,278
16	\$3,692,000 @\$11,833	\$3,248,960 @\$10,413

第1座(1A) K: 1房 318'		
樓層	訂價	折實價12%
5	\$3,273,000 @\$10,292	\$2,880,240 @\$9,057
6	\$3,319,000 @\$10,437	\$2,920,720 @\$9,185
7	\$3,366,000 @\$10,585	\$2,962,080 @\$9,315
8	\$3,436,000 @\$10,805	\$3,023,680 @\$9,508
9	\$3,460,000 @\$10,881	\$3,044,800 @\$9,575
10	\$3,543,000 @\$11,142	\$3,117,840 @\$9,805
11	\$3,592,000 @\$11,296	\$3,160,960 @\$9,940
12	\$3,641,000 @\$11,450	\$3,204,080 @\$10,076
15	\$3,690,000 @\$11,604	\$3,247,200 @\$10,211
16	\$3,739,000 @\$11,758	\$3,290,320 @\$10,347
17	\$3,843,000 @\$12,085	\$3,381,840 @\$10,635
18	\$3,919,000 @\$12,324	\$3,448,720 @\$10,845
19	\$3,945,000 @\$12,406	\$3,471,600 @\$10,917
20	\$3,997,000 @\$12,569	\$3,517,360 @\$11,061
21	\$4,085,000 @\$12,846	\$3,594,800 @\$11,304
22	\$4,138,000 @\$13,013	\$3,641,440 @\$11,451
23	\$4,191,000 @\$13,179	\$3,688,080 @\$11,598
25	\$4,244,000 @\$13,346	\$3,734,720 @\$11,744
26	\$4,299,000 @\$13,519	\$3,783,120 @\$11,897

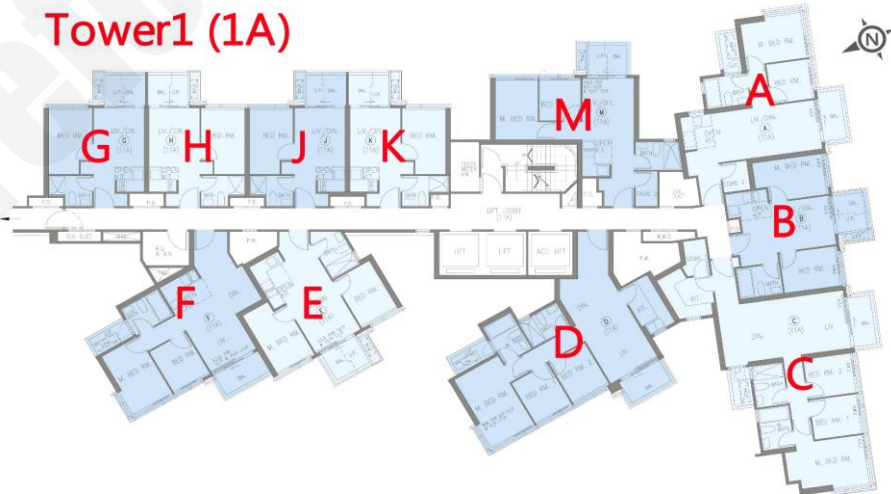

紅色為最高售價、最高平均呎價；藍色為最低售價、最低平均呎價

新盤價單表

黃金海灣珀岸

價單1號

以最高12%折扣計算

制作日期: 2025-01-07



Tower1 (1B)



第1座(1B) E : 2房 460'		
樓層	訂價	折實價12%
5	\$5,588,000 @\$12,148	\$4,917,440 @\$10,690
6	\$5,656,000 @\$12,296	\$4,977,280 @\$10,820

第1座(1B) F : 2房 441'		
樓層	訂價	折實價12%
5	\$4,445,000 @\$10,079	\$3,911,600 @\$8,870
6	\$4,509,000 @\$10,224	\$3,967,920 @\$8,998
7	\$4,573,000 @\$10,370	\$4,024,240 @\$9,125
8	\$4,668,000 @\$10,585	\$4,107,840 @\$9,315
9	\$4,701,000 @\$10,660	\$4,136,880 @\$9,381
10	\$4,816,000 @\$10,921	\$4,238,080 @\$9,610
11	\$4,882,000 @\$11,070	\$4,296,160 @\$9,742
12	\$4,949,000 @\$11,222	\$4,355,120 @\$9,876
15	\$5,016,000 @\$11,374	\$4,414,080 @\$10,009
16	\$5,083,000 @\$11,526	\$4,473,040 @\$10,143

第1座(1B) G : 1房 304/309'		
樓層	訂價	折實價12%
5	\$2,942,000 @\$9,521	\$2,588,960 @\$8,379
6	\$2,988,000 @\$9,670	\$2,629,440 @\$8,510
7	\$3,033,000 @\$9,816	\$2,669,040 @\$8,638
8	\$3,101,000 @\$10,036	\$2,728,880 @\$8,831
9	\$3,124,000 @\$10,110	\$2,749,120 @\$8,897
10	\$3,224,000 @\$10,434	\$2,837,120 @\$9,182
11	\$3,270,000 @\$10,583	\$2,877,600 @\$9,313
12	\$3,318,000 @\$10,738	\$2,919,840 @\$9,449
15	\$3,366,000 @\$10,893	\$2,962,080 @\$9,586
16	\$3,414,000 @\$11,049	\$3,004,320 @\$9,723
17	\$3,485,000 @\$11,278	\$3,066,800 @\$9,925
18	\$3,513,000 @\$11,369	\$3,091,440 @\$10,005
19	\$3,533,000 @\$11,434	\$3,109,040 @\$10,062
20	\$3,582,000 @\$11,592	\$3,152,160 @\$10,201
21	\$3,702,000 @\$11,981	\$3,257,760 @\$10,543
22	\$3,774,000 @\$12,414	\$3,321,120 @\$10,925
23	\$3,825,000 @\$12,582	\$3,366,000 @\$11,072
25	\$3,876,000 @\$12,750	\$3,410,880 @\$11,220

第1座(1B) J : 1房 307'		
樓層	訂價	折實價12%
5	\$3,143,000 @\$10,238	\$2,765,840 @\$9,009
6	\$3,188,000 @\$10,384	\$2,805,440 @\$9,138
7	\$3,232,000 @\$10,528	\$2,844,160 @\$9,264
8	\$3,299,000 @\$10,746	\$2,903,120 @\$9,456
9	\$3,322,000 @\$10,821	\$2,923,360 @\$9,522
10	\$3,402,000 @\$11,081	\$2,993,760 @\$9,752
11	\$3,449,000 @\$11,235	\$3,035,120 @\$9,886
12	\$3,495,000 @\$11,384	\$3,075,600 @\$10,018
15	\$3,542,000 @\$11,537	\$3,116,960 @\$10,153
16	\$3,590,000 @\$11,694	\$3,159,200 @\$10,291

紅色為最高售價、最高平均呎價；藍色為最低售價、最低平均呎價

新盤價單表

黃金海灣珀岸

價單1號

以最高12%折扣計算

制作日期: 2025-01-07



第2座 A : 3房 651'		
樓層	訂價	折實價12%
5	\$7,134,000 @\$10,959	\$6,277,920 @\$9,644
6	\$7,213,000 @\$11,080	\$6,347,440 @\$9,750
7	\$7,293,000 @\$11,203	\$6,417,840 @\$9,858
8	\$7,414,000 @\$11,389	\$6,524,320 @\$10,022
9	\$7,455,000 @\$11,452	\$6,560,400 @\$10,077

第2座 D : 2房 447'		
樓層	訂價	折實價12%
5	\$4,666,000 @\$10,438	\$4,106,080 @\$9,186
6	\$4,727,000 @\$10,575	\$4,159,760 @\$9,306
7	\$4,791,000 @\$10,718	\$4,216,080 @\$9,432
8	\$4,885,000 @\$10,928	\$4,298,800 @\$9,617
9	\$4,918,000 @\$11,002	\$4,327,840 @\$9,682
10	\$5,034,000 @\$11,262	\$4,429,920 @\$9,910
11	\$5,099,000 @\$11,407	\$4,487,120 @\$10,038
12	\$5,165,000 @\$11,555	\$4,545,200 @\$10,168
15	\$5,232,000 @\$11,705	\$4,604,160 @\$10,300
16	\$5,299,000 @\$11,855	\$4,663,120 @\$10,432
17	\$5,468,000 @\$12,233	\$4,811,840 @\$10,765
18	\$5,572,000 @\$12,465	\$4,903,360 @\$10,969
19	\$5,606,000 @\$12,541	\$4,933,280 @\$11,036
20	\$5,676,000 @\$12,698	\$4,994,880 @\$11,174
21	\$5,899,000 @\$13,197	\$5,191,120 @\$11,613
22	\$5,970,000 @\$13,356	\$5,253,600 @\$11,753
23	\$6,043,000 @\$13,519	\$5,317,840 @\$11,897
25	\$6,116,000 @\$13,682	\$5,382,080 @\$12,040

Tower 2

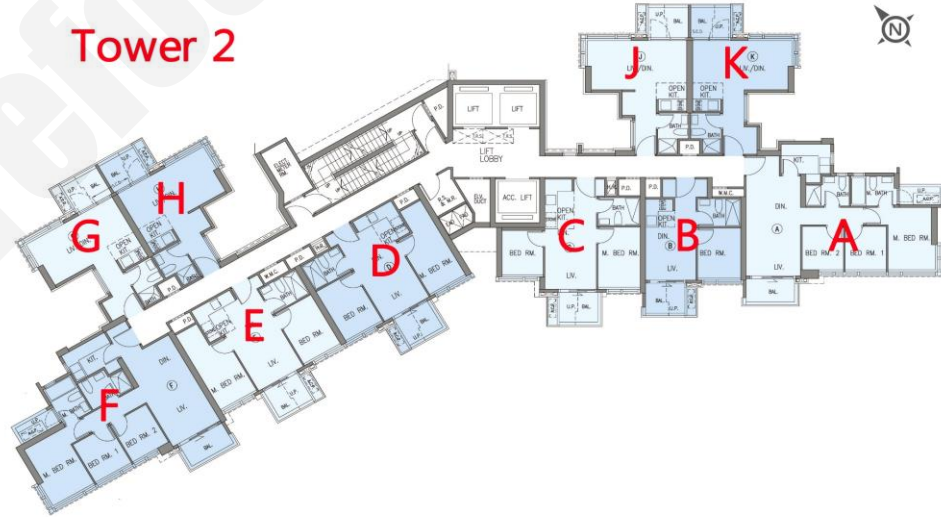

第2座 G : 開放式 306'		
樓層	訂價	折實價12%
5	\$2,898,000 @\$9,471	\$2,550,240 @\$8,334
6	\$2,927,000 @\$9,565	\$2,575,760 @\$8,418
7	\$2,977,000 @\$9,729	\$2,619,760 @\$8,561
8	\$3,027,000 @\$9,892	\$2,663,760 @\$8,705
9	\$3,038,000 @\$9,928	\$2,673,440 @\$8,737
10	\$3,083,000 @\$10,075	\$2,713,040 @\$8,866
11	\$3,114,000 @\$10,176	\$2,740,320 @\$8,955
12	\$3,145,000 @\$10,278	\$2,767,600 @\$9,044
15	\$3,197,000 @\$10,448	\$2,813,360 @\$9,194
16	\$3,228,000 @\$10,549	\$2,840,640 @\$9,283
17	\$3,294,000 @\$10,765	\$2,898,720 @\$9,473
18	\$3,348,000 @\$10,941	\$2,946,240 @\$9,628
19	\$3,359,000 @\$10,977	\$2,955,920 @\$9,660
20	\$3,392,000 @\$11,085	\$2,984,960 @\$9,755
21	\$3,477,000 @\$11,363	\$3,059,760 @\$9,999
22	\$3,510,000 @\$11,471	\$3,088,800 @\$10,094
23	\$3,543,000 @\$11,578	\$3,117,840 @\$10,189
25	\$3,576,000 @\$11,686	\$3,146,880 @\$10,284

第2座 H : 開放式 305'		
樓層	訂價	折實價12%
5	\$2,820,000 @\$9,246	\$2,481,600 @\$8,136
6	\$2,850,000 @\$9,344	\$2,508,000 @\$8,223
7	\$2,899,000 @\$9,505	\$2,551,120 @\$8,364
8	\$2,949,000 @\$9,669	\$2,595,120 @\$8,509
9	\$2,959,000 @\$9,702	\$2,603,920 @\$8,537
10	\$3,005,000 @\$9,852	\$2,644,400 @\$8,670
11	\$3,035,000 @\$9,951	\$2,670,800 @\$8,757
12	\$3,066,000 @\$10,052	\$2,698,080 @\$8,846
15	\$3,118,000 @\$10,223	\$2,743,840 @\$8,996
16	\$3,150,000 @\$10,328	\$2,772,000 @\$9,089
17	\$3,216,000 @\$10,544	\$2,830,080 @\$9,279
18	\$3,269,000 @\$10,718	\$2,876,720 @\$9,432
19	\$3,280,000 @\$10,754	\$2,886,400 @\$9,464
20	\$3,313,000 @\$10,862	\$2,915,440 @\$9,559
21	\$3,398,000 @\$11,141	\$2,990,240 @\$9,804
22	\$3,431,000 @\$11,249	\$3,019,280 @\$9,899
23	\$3,464,000 @\$11,357	\$3,048,320 @\$9,994
25	\$3,497,000 @\$11,466	\$3,077,360 @\$10,090

紅色為最高售價、最高平均呎價；藍色為最低售價、最低平均呎價