

新盤價單表

Beacon Peak 1期

價單1號

以最高6%折扣計算

制作日期: 2025-07-30



T2 A: 3房 945'		
樓層	訂價	折實價6%
6	\$16,776,800 @\$17,753	\$15,770,192 @\$16,688
7	\$17,392,000 @\$18,404	\$16,348,480 @\$17,300
8	\$17,995,200 @\$19,043	\$16,915,488 @\$17,900
9	\$18,900,000 @\$20,000	\$17,766,000 @\$18,800
10	\$19,603,700 @\$20,745	\$18,427,478 @\$19,500
11	\$20,307,400 @\$21,489	\$19,088,956 @\$20,200
12	\$21,011,200 @\$22,234	\$19,750,528 @\$20,900
15	\$21,916,000 @\$23,192	\$20,601,040 @\$21,800
16	\$22,820,700 @\$24,149	\$21,451,458 @\$22,700

T2 D: 2房 724'		
樓層	訂價	折實價6%
6	\$13,555,700 @\$18,723	\$12,742,358 @\$17,600
7	\$13,632,800 @\$18,830	\$12,814,832 @\$17,700
8	\$13,825,300 @\$19,096	\$12,995,782 @\$17,950
9	\$14,480,000 @\$20,000	\$13,611,200 @\$18,800
10	\$15,096,200 @\$20,851	\$14,190,428 @\$19,600
11	\$15,635,300 @\$21,596	\$14,697,182 @\$20,300
12	\$16,097,400 @\$22,234	\$15,131,556 @\$20,900
15	\$16,790,600 @\$23,191	\$15,783,164 @\$21,800
16	\$17,483,800 @\$24,149	\$16,434,772 @\$22,700

T5 A: 3房 985'		
樓層	訂價	折實價6%
6	\$17,918,600 @\$18,191	\$16,843,484 @\$17,100
7	\$18,233,000 @\$18,511	\$17,139,020 @\$17,400
8	\$18,652,100 @\$18,936	\$17,532,974 @\$17,800
9	\$19,228,500 @\$19,521	\$18,074,790 @\$18,350
10	\$19,804,800 @\$20,106	\$18,616,512 @\$18,900
11	\$20,538,300 @\$20,851	\$19,306,002 @\$19,600
12	\$21,376,600 @\$21,702	\$20,094,004 @\$20,400

T5 B: 2房 726'/728'		
樓層	訂價	折實價6%
6	\$13,320,900 @\$18,298	\$12,521,646 @\$17,200
7	\$13,630,600 @\$18,723	\$12,812,764 @\$17,600
8	\$14,327,700 @\$19,681	\$13,468,038 @\$18,500
9	\$14,714,900 @\$20,213	\$13,832,006 @\$19,000
10	\$15,137,900 @\$20,851	\$14,229,626 @\$19,600
11	\$15,601,300 @\$21,489	\$14,665,222 @\$20,200
12	\$16,141,900 @\$22,234	\$15,173,386 @\$20,900

T5 F: 3房 768'		
樓層	訂價	折實價6%
11	\$14,624,700 @\$19,043	\$13,747,218 @\$17,900
12	\$15,237,400 @\$19,840	\$14,323,156 @\$18,650
15	\$15,850,200 @\$20,638	\$14,899,188 @\$19,400
16	\$16,258,700 @\$21,170	\$15,283,178 @\$19,900
17	\$16,748,900 @\$21,808	\$15,743,966 @\$20,500
18	\$17,320,900 @\$22,553	\$16,281,646 @\$21,200

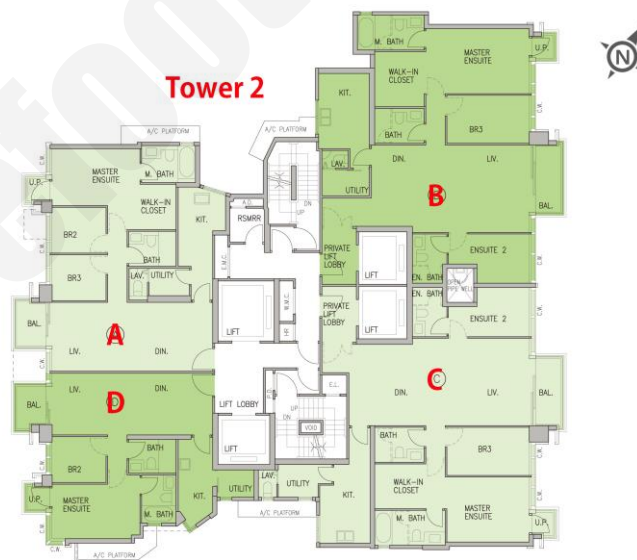

新盤價單表

Beacon Peak 1期

價單1號

以最高6%折扣計算

制作日期: 2025-07-30



T6 C: 3房 768'		
樓層	訂價	折實價6%
10	\$13,797,900 @\$17,966	\$12,970,026 @\$16,888
11	\$14,052,800 @\$18,298	\$13,209,632 @\$17,200
12	\$14,257,000 @\$18,564	\$13,401,580 @\$17,450
15	\$14,461,300 @\$18,830	\$13,593,622 @\$17,700
16	\$14,665,500 @\$19,096	\$13,785,570 @\$17,950
17	\$14,869,800 @\$19,362	\$13,977,612 @\$18,200
18	\$15,237,400 @\$19,840	\$14,323,156 @\$18,650
19	\$15,441,700 @\$20,106	\$14,515,198 @\$18,900
20	\$15,646,000 @\$20,372	\$14,707,240 @\$19,150
21	\$15,891,100 @\$20,692	\$14,937,634 @\$19,450
22	\$16,136,200 @\$21,011	\$15,168,028 @\$19,750
23	\$16,381,300 @\$21,330	\$15,398,422 @\$20,050
25	\$16,626,400 @\$21,649	\$15,628,816 @\$20,350
26	\$16,871,500 @\$21,968	\$15,859,210 @\$20,650
T6 D: 2房 712'		
樓層	訂價	折實價6%
10	\$12,117,700 @\$17,019	\$11,390,638 @\$15,998
11	\$12,763,000 @\$17,926	\$11,997,220 @\$16,850
12	\$12,914,500 @\$18,138	\$12,139,630 @\$17,050
15	\$13,066,000 @\$18,351	\$12,282,040 @\$17,250
16	\$13,217,400 @\$18,564	\$12,424,356 @\$17,450
17	\$13,368,900 @\$18,777	\$12,566,766 @\$17,650
18	\$13,596,200 @\$19,096	\$12,780,428 @\$17,950
19	\$13,785,500 @\$19,362	\$12,958,370 @\$18,200
20	\$14,050,600 @\$19,734	\$13,207,564 @\$18,550
21	\$14,240,000 @\$20,000	\$13,385,600 @\$18,800
22	\$14,429,400 @\$20,266	\$13,563,636 @\$19,050
23	\$14,694,500 @\$20,638	\$13,812,830 @\$19,400
25	\$14,959,600 @\$21,011	\$14,062,024 @\$19,750
26	\$15,224,700 @\$21,383	\$14,311,218 @\$20,100

