

新盤價單表

上然 2期

價單1號

以最高16%折扣計算

制作日期: 2025-03-24



6座A2 : 1房 367'		
樓層	訂價	折實價16%
1	\$4,760,000 @\$12,970	\$3,998,400 @\$10,895
2	\$4,871,000 @\$13,272	\$4,091,640 @\$11,149
3	\$4,904,000 @\$13,362	\$4,119,360 @\$11,224
5	\$4,985,000 @\$13,583	\$4,187,400 @\$11,410
6	\$5,020,000 @\$13,678	\$4,216,800 @\$11,490
7	\$5,054,000 @\$13,771	\$4,245,360 @\$11,568
8	\$5,123,000 @\$13,959	\$4,303,320 @\$11,726
9	\$5,158,000 @\$14,054	\$4,332,720 @\$11,806
10	\$5,194,000 @\$14,153	\$4,362,960 @\$11,888
11	\$5,229,000 @\$14,248	\$4,392,360 @\$11,968
12	\$5,301,000 @\$14,444	\$4,452,840 @\$12,133
15	\$5,338,000 @\$14,545	\$4,483,920 @\$12,218

6座A7 : 1房 278'/319'/323'		
樓層	訂價	折實價16%
1	\$4,048,000 @\$14,561	\$3,400,320 @\$12,231
2	\$4,155,000 @\$13,025	\$3,490,200 @\$10,941
3	\$4,184,000 @\$13,116	\$3,514,560 @\$11,017
5	\$4,213,000 @\$13,207	\$3,538,920 @\$11,094
6	\$4,241,000 @\$13,295	\$3,562,440 @\$11,168
7	\$4,271,000 @\$13,389	\$3,587,640 @\$11,247
8	\$4,329,000 @\$13,571	\$3,636,360 @\$11,399
9	\$4,359,000 @\$13,665	\$3,661,560 @\$11,478
10	\$4,388,000 @\$13,755	\$3,685,920 @\$11,555
11	\$4,419,000 @\$13,853	\$3,711,960 @\$11,636
12	\$4,479,000 @\$14,041	\$3,762,360 @\$11,794
15	\$4,522,000 @\$14,000	\$3,798,480 @\$11,760

6座D3 : 2房 465'		
樓層	訂價	折實價16%
1	\$6,075,000 @\$13,065	\$5,103,000 @\$10,974
2	\$6,234,000 @\$13,406	\$5,236,560 @\$11,261
3	\$6,277,000 @\$13,499	\$5,272,680 @\$11,339
5	\$6,320,000 @\$13,591	\$5,308,800 @\$11,417
6	\$6,363,000 @\$13,684	\$5,344,920 @\$11,494
7	\$6,407,000 @\$13,778	\$5,381,880 @\$11,574
8	\$6,494,000 @\$13,966	\$5,454,960 @\$11,731

6座D5 : 2房 445'		
樓層	訂價	折實價16%
1	\$5,458,000 @\$12,265	\$4,584,720 @\$10,303
2	\$5,602,000 @\$12,589	\$4,705,680 @\$10,575
3	\$5,640,000 @\$12,674	\$4,737,600 @\$10,646
5	\$5,678,000 @\$12,760	\$4,769,520 @\$10,718
6	\$5,717,000 @\$12,847	\$4,802,280 @\$10,792
7	\$5,757,000 @\$12,937	\$4,835,880 @\$10,867

6座C6 : 1房 381'		
樓層	訂價	折實價16%
1	\$3,180,000 @\$12,927	\$2,671,200 @\$10,859
2	\$3,263,000 @\$13,264	\$2,740,920 @\$11,142

6座A1 : 1房 344'/350'		
樓層	訂價	折實價16%
2	\$4,360,000 @\$12,457	\$3,662,400 @\$10,464
3	\$4,391,000 @\$12,765	\$3,688,440 @\$10,722
5	\$4,421,000 @\$12,852	\$3,713,640 @\$10,795
6	\$4,451,000 @\$12,939	\$3,738,840 @\$10,869
7	\$4,482,000 @\$13,029	\$3,764,880 @\$10,944

6座C7 : 開放式 248'		
樓層	訂價	折實價16%
3	\$3,288,000 @\$13,258	\$2,761,920 @\$11,137
5	\$3,310,000 @\$13,347	\$2,780,400 @\$11,211
6	\$3,333,000 @\$13,440	\$2,799,720 @\$11,289
7	\$3,355,000 @\$13,528	\$2,818,200 @\$11,364
8	\$3,401,000 @\$13,714	\$2,856,840 @\$11,520
9	\$3,425,000 @\$13,810	\$2,877,000 @\$11,601
10	\$3,448,000 @\$13,903	\$2,896,320 @\$11,679
11	\$3,472,000 @\$14,000	\$2,916,480 @\$11,760
12	\$3,520,000 @\$14,194	\$2,956,800 @\$11,923
15	\$3,544,000 @\$14,290	\$2,976,960 @\$12,004

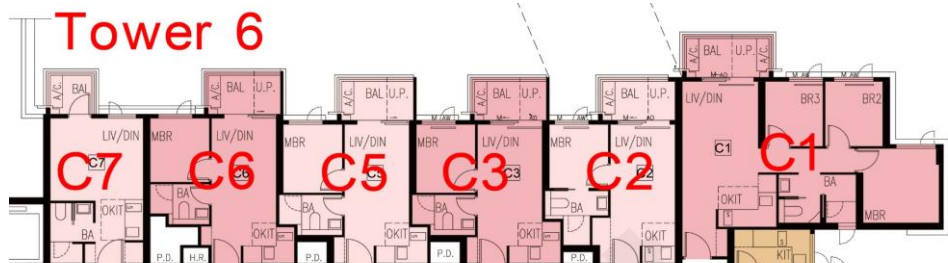

紅色為最高售價、最高平均呎價；藍色為最低售價、最低平均呎價



7座B5: 2房 436/441'		
樓層	訂價	折實價16%
1	\$6,132,000 @\$13,905	\$5,150,880 @\$11,680
2	\$6,271,000 @\$14,383	\$5,267,640 @\$12,082
3	\$6,314,000 @\$14,482	\$5,303,760 @\$12,165
5	\$6,357,000 @\$14,580	\$5,339,880 @\$12,247
6	\$6,401,000 @\$14,681	\$5,376,840 @\$12,332
7	\$6,444,000 @\$14,780	\$5,412,960 @\$12,415
8	\$6,532,000 @\$14,982	\$5,486,880 @\$12,585
9	\$6,577,000 @\$15,085	\$5,524,680 @\$12,671
10	\$6,622,000 @\$15,188	\$5,562,480 @\$12,758
11	\$6,667,000 @\$15,291	\$5,600,280 @\$12,845
12	\$6,759,000 @\$15,502	\$5,677,560 @\$13,022
15	\$6,805,000 @\$15,608	\$5,716,200 @\$13,111

7座B6: 1房 302'		
樓層	訂價	折實價16%
1	\$4,192,000 @\$13,881	\$3,521,280 @\$11,660
2	\$4,303,000 @\$14,248	\$3,614,520 @\$11,969
3	\$4,333,000 @\$14,348	\$3,639,720 @\$12,052
5	\$4,363,000 @\$14,447	\$3,664,920 @\$12,135
6	\$4,392,000 @\$14,543	\$3,689,280 @\$12,216
7	\$4,422,000 @\$14,642	\$3,714,480 @\$12,300
8	\$4,483,000 @\$14,844	\$3,765,720 @\$12,469
9	\$4,514,000 @\$14,947	\$3,791,760 @\$12,555
10	\$4,545,000 @\$15,050	\$3,817,800 @\$12,642
11	\$4,576,000 @\$15,152	\$3,843,840 @\$12,728
12	\$4,639,000 @\$15,361	\$3,896,760 @\$12,903
15	\$4,670,000 @\$15,464	\$3,922,800 @\$12,989

7座A8: 2房 422'		
樓層	訂價	折實價16%
2	\$5,690,000 @\$13,483	\$4,779,600 @\$11,326
3	\$5,979,000 @\$14,168	\$5,022,360 @\$11,901
5	\$6,138,000 @\$14,545	\$5,155,920 @\$12,218
6	\$6,179,000 @\$14,642	\$5,190,360 @\$12,299
7	\$6,222,000 @\$14,744	\$5,226,480 @\$12,385
8	\$6,307,000 @\$14,945	\$5,297,880 @\$12,554

7座A9: 1房 309'		
樓層	訂價	折實價16%
2	\$4,071,000 @\$13,175	\$3,419,640 @\$11,067
3	\$4,278,000 @\$13,845	\$3,593,520 @\$11,630
5	\$4,391,000 @\$14,210	\$3,688,440 @\$11,937
6	\$4,421,000 @\$14,307	\$3,713,640 @\$12,018
7	\$4,452,000 @\$14,408	\$3,739,680 @\$12,103

7座B3: 2房 471'		
樓層	訂價	折實價16%
2	\$6,464,000 @\$13,724	\$5,429,760 @\$11,528
3	\$6,666,000 @\$14,153	\$5,599,440 @\$11,888
5	\$6,841,000 @\$14,524	\$5,746,440 @\$12,201
6	\$6,889,000 @\$14,626	\$5,786,760 @\$12,286
7	\$6,935,000 @\$14,724	\$5,825,400 @\$12,368
8	\$7,030,000 @\$14,926	\$5,905,200 @\$12,538
9	\$7,079,000 @\$15,030	\$5,946,360 @\$12,625

7座A1: 3房 655'		
樓層	訂價	折實價16%
2	\$8,910,000 @\$13,603	\$7,484,400 @\$11,427
3	\$9,145,000 @\$13,962	\$7,681,800 @\$11,728
5	\$9,208,000 @\$14,058	\$7,734,720 @\$11,809
6	\$9,271,000 @\$14,154	\$7,787,640 @\$11,890
7	\$9,561,000 @\$14,597	\$8,031,240 @\$12,261
8	\$9,879,000 @\$15,082	\$8,298,360 @\$12,669
9	\$9,947,000 @\$15,186	\$8,355,480 @\$12,756
10	\$10,015,000 @\$15,290	\$8,412,600 @\$12,844
11	\$10,084,000 @\$15,395	\$8,470,560 @\$12,932
12	\$10,222,000 @\$15,606	\$8,586,480 @\$13,109

7座A10: 3房 723'		
樓層	訂價	折實價16%
2	\$10,276,000 @\$14,213	\$8,631,840 @\$11,939
3	\$10,547,000 @\$14,588	\$8,859,480 @\$12,254
5	\$10,877,000 @\$15,044	\$9,136,680 @\$12,637
6	\$11,165,000 @\$15,443	\$9,378,600 @\$12,972
7	\$11,242,000 @\$15,549	\$9,443,280 @\$13,061
8	\$11,396,000 @\$15,762	\$9,572,640 @\$13,240
9	\$11,475,000 @\$15,871	\$9,639,000 @\$13,332
10	\$11,553,000 @\$15,979	\$9,704,520 @\$13,423
11	\$11,632,000 @\$16,089	\$9,770,880 @\$13,514
12	\$11,792,000 @\$16,310	\$9,905,280 @\$13,700

7座C5: 1房 305'		
樓層	訂價	折實價16%
2	\$4,155,000 @\$13,623	\$3,490,200 @\$11,443
3	\$4,265,000 @\$13,984	\$3,582,600 @\$11,746
5	\$4,294,000 @\$14,079	\$3,606,960 @\$11,826
6	\$4,323,000 @\$14,174	\$3,631,320 @\$11,906
7	\$4,353,000 @\$14,272	\$3,656,520 @\$11,989
8	\$4,413,000 @\$14,469	\$3,706,920 @\$12,154
9	\$4,442,000 @\$14,564	\$3,731,280 @\$12,234
10	\$4,473,000 @\$14,666	\$3,757,320 @\$12,319
11	\$4,504,000 @\$14,767	\$3,783,360 @\$12,404
12	\$4,565,000 @\$14,967	\$3,834,600 @\$12,572
15	\$4,597,000 @\$15,072	\$3,861,480 @\$12,661

7座D5: 1房 327/367'		
樓層	訂價	折實價16%
2	\$4,858,000 @\$14,856	\$4,080,720 @\$12,479
3	\$4,966,000 @\$15,531	\$4,171,440 @\$13,366
5	\$5,048,000 @\$13,755	\$4,240,320 @\$11,554
6	\$5,083,000 @\$13,850	\$4,269,720 @\$11,634
7	\$5,117,000 @\$13,943	\$4,298,280 @\$11,712
8	\$5,188,000 @\$14,136	\$4,357,920 @\$11,874
9	\$5,223,000 @\$14,232	\$4,387,320 @\$11,955
10	\$5,259,000 @\$14,330	\$4,417,560 @\$12,037
11	\$5,295,000 @\$14,428	\$4,447,800 @\$12,119
12	\$5,367,000 @\$14,624	\$4,508,280 @\$12,284

紅色為最高售價、最高平均呎價；藍色為最低售價、最低平均呎價