

A7 : 1房 310'		
樓層	訂價	折實價16%
1	\$3,570,000 @\$11,516	\$2,998,800 @\$9,674
2	\$3,570,000 @\$11,516	\$2,998,800 @\$9,674
3	\$3,570,000 @\$11,516	\$2,998,800 @\$9,674
5	\$3,710,000 @\$11,968	\$3,116,400 @\$10,053
6	\$3,760,000 @\$12,129	\$3,158,400 @\$10,188
7	\$3,796,000 @\$12,245	\$3,188,640 @\$10,286
8	\$3,841,000 @\$12,390	\$3,226,440 @\$10,408
9	\$3,879,000 @\$12,513	\$3,258,360 @\$10,511
10	\$3,905,000 @\$12,597	\$3,280,200 @\$10,581
11	\$3,932,000 @\$12,684	\$3,302,880 @\$10,654
12	\$3,958,000 @\$12,768	\$3,324,720 @\$10,725
15	\$3,985,000 @\$12,855	\$3,347,400 @\$10,798
16	\$4,011,000 @\$12,939	\$3,369,240 @\$10,869
17	\$4,039,000 @\$13,029	\$3,392,760 @\$10,944
18	\$4,086,000 @\$13,181	\$3,432,240 @\$11,072
19	\$4,114,000 @\$13,271	\$3,455,760 @\$11,148

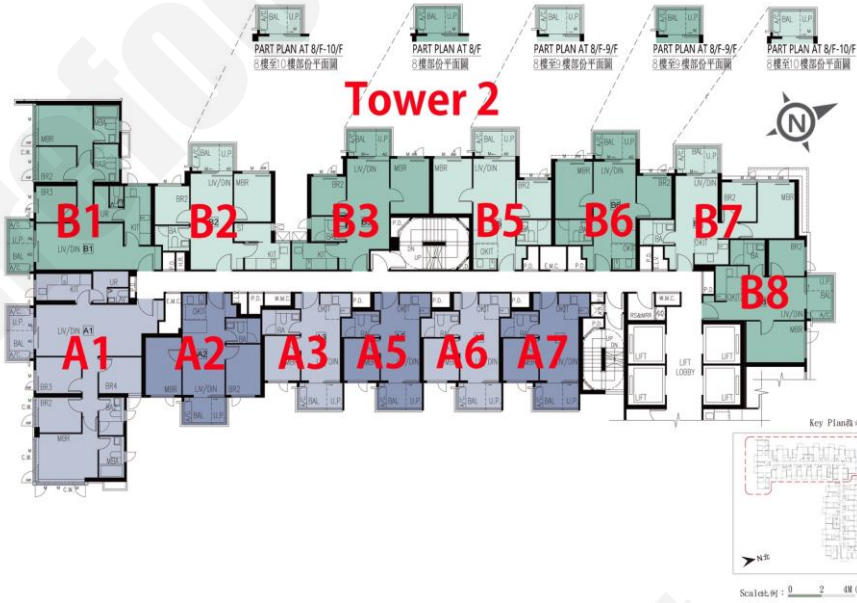

B3 : 2房 475'		
樓層	訂價	折實價16%
1	\$5,642,000 @\$11,878	\$4,739,280 @\$9,977
2	\$5,791,000 @\$12,192	\$4,864,440 @\$10,241
3	\$5,971,000 @\$12,571	\$5,015,640 @\$10,559
5	\$6,128,000 @\$12,901	\$5,147,520 @\$10,837
6	\$6,188,000 @\$13,027	\$5,197,920 @\$10,943
B5 : 2房 435'		
樓層	訂價	折實價16%
1	\$4,760,000 @\$10,943	\$3,998,400 @\$9,192
2	\$4,760,000 @\$10,943	\$3,998,400 @\$9,192
3	\$4,760,000 @\$10,943	\$3,998,400 @\$9,192
5	\$4,905,000 @\$11,276	\$4,120,200 @\$9,472
6	\$5,020,000 @\$11,540	\$4,216,800 @\$9,694
7	\$5,108,000 @\$11,743	\$4,290,720 @\$9,864
8	\$5,204,000 @\$11,963	\$4,371,360 @\$10,049

B1 : 3房 713'		
樓層	訂價	折實價16%
2	\$9,550,000 @\$13,394	\$8,022,000 @\$11,251
3	\$9,802,000 @\$13,748	\$8,233,680 @\$11,548
5	\$9,869,000 @\$13,842	\$8,289,960 @\$11,627
B7 : 2房 239'/248'		
樓層	訂價	折實價16%
2	\$2,833,000 @\$11,423	\$2,379,720 @\$9,596
3	\$2,942,000 @\$11,863	\$2,471,280 @\$9,965
5	\$3,010,000 @\$12,137	\$2,528,400 @\$10,195
6	\$3,220,000 @\$12,984	\$2,704,800 @\$10,906
7	\$3,250,000 @\$13,598	\$2,730,000 @\$11,423

B8 : 2房 434'		
樓層	訂價	折實價16%
8	\$5,709,000 @\$13,154	\$4,795,560 @\$11,050
9	\$5,748,000 @\$13,244	\$4,828,320 @\$11,125
10	\$5,788,000 @\$13,336	\$4,861,920 @\$11,203
A1 : 4房 873'		
樓層	訂價	折實價16%
2	\$11,771,000 @\$13,483	\$9,887,640 @\$11,326
3	\$12,073,000 @\$13,829	\$10,141,320 @\$11,617

紅色為最高售價、最高平均呎價；藍色為最低售價、最低平均呎價  
 以上的物業資料只供參考，一切以發展商最新公布為準，如有任何資料錯漏本網頁不會承擔任何責任。

新盤價單表

上然 1期

價單1號

以最高16%折扣計算

制作日期: 2025-05-07

D1 : 3房 654'		
樓層	訂價	折實價16%
1	\$8,332,000 @\$12,740	\$6,998,880 @\$10,702
2	\$8,551,000 @\$13,075	\$7,182,840 @\$10,983
3	\$8,634,000 @\$13,202	\$7,252,560 @\$11,090
D3 : 2房 443'/444'		
樓層	訂價	折實價16%
1	\$5,857,000 @\$13,191	\$4,919,880 @\$11,081
2	\$6,010,000 @\$13,536	\$5,048,400 @\$11,370
3	\$6,052,000 @\$13,631	\$5,083,680 @\$11,450
5	\$6,092,000 @\$13,721	\$5,117,280 @\$11,525
6	\$6,135,000 @\$13,818	\$5,153,400 @\$11,607
7	\$6,177,000 @\$13,912	\$5,188,680 @\$11,686
8	\$6,230,000 @\$14,032	\$5,233,200 @\$11,786
9	\$6,273,000 @\$14,128	\$5,269,320 @\$11,868
10	\$6,316,000 @\$14,225	\$5,305,440 @\$11,949
11	\$6,359,000 @\$14,322	\$5,341,560 @\$12,031
12	\$6,403,000 @\$14,421	\$5,378,520 @\$12,114
15	\$6,446,000 @\$14,518	\$5,414,640 @\$12,195
16	\$6,491,000 @\$14,619	\$5,452,440 @\$12,280
17	\$6,535,000 @\$14,718	\$5,489,400 @\$12,364
18	\$6,596,000 @\$14,889	\$5,540,640 @\$12,507

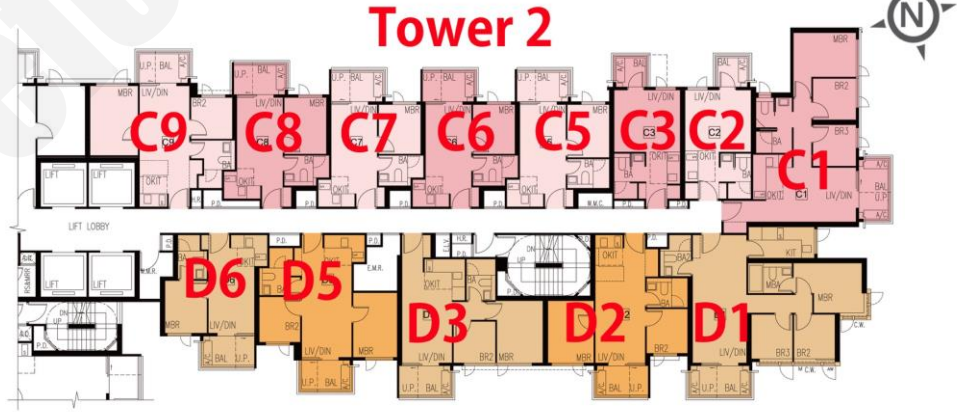

C3 : 開放式 244'		
樓層	訂價	折實價16%
2	\$3,052,000 @\$12,508	\$2,563,680 @\$10,507
3	\$3,121,000 @\$12,791	\$2,621,640 @\$10,744
5	\$3,144,000 @\$12,885	\$2,640,960 @\$10,824
C7 : 1房 301'		
樓層	訂價	折實價16%
2	\$4,030,000 @\$13,389	\$3,385,200 @\$11,247
3	\$4,121,000 @\$13,691	\$3,461,640 @\$11,500
5	\$4,150,000 @\$13,787	\$3,486,000 @\$11,581
6	\$4,177,000 @\$13,877	\$3,508,680 @\$11,657
7	\$4,205,000 @\$13,970	\$3,532,200 @\$11,735
8	\$4,242,000 @\$14,093	\$3,563,280 @\$11,838
9	\$4,272,000 @\$14,193	\$3,588,480 @\$11,922
10	\$4,301,000 @\$14,289	\$3,612,840 @\$12,003
11	\$4,330,000 @\$14,385	\$3,637,200 @\$12,084
12	\$4,360,000 @\$14,485	\$3,662,400 @\$12,167

C9 : 2房 467'		
樓層	訂價	折實價16%
2	\$5,694,000 @\$12,193	\$4,782,960 @\$10,242
3	\$5,842,000 @\$12,510	\$4,907,280 @\$10,508
5	\$5,883,000 @\$12,597	\$4,941,720 @\$10,582
6	\$5,923,000 @\$12,683	\$4,975,320 @\$10,654
7	\$5,964,000 @\$12,771	\$5,009,760 @\$10,728
C6 : 1房 301'		
樓層	訂價	折實價16%
15	\$4,390,000 @\$14,585	\$3,687,600 @\$12,251
16	\$4,420,000 @\$14,684	\$3,712,800 @\$12,335
17	\$4,451,000 @\$14,787	\$3,738,840 @\$12,421
18	\$4,503,000 @\$14,960	\$3,782,520 @\$12,567