

新盤價單表

海德園 1期

價單1號

以最高15%折扣計算

制作日期: 2025-08-26



Tower 2
第2座

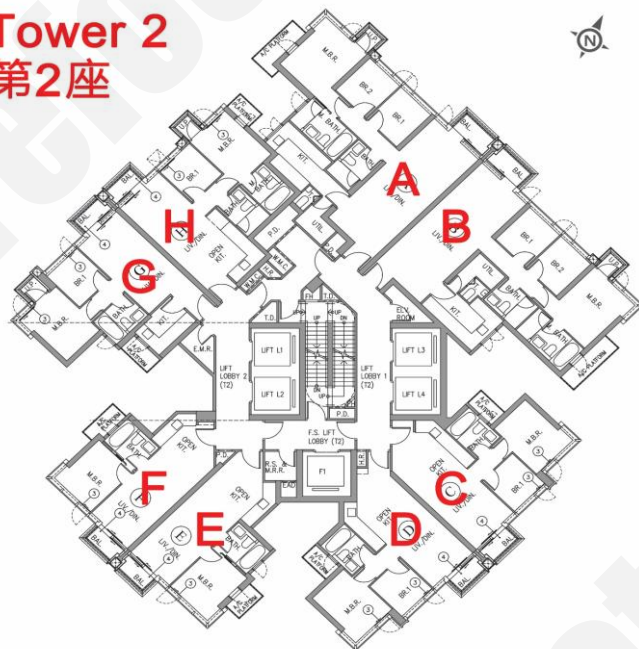

2座B: 3房 899'		
樓層	訂價	折實價15%
5	\$20,241,000 @\$22,515	\$17,204,850 @\$19,138
6	\$20,347,000 @\$22,633	\$17,294,950 @\$19,238
7	\$20,449,000 @\$22,746	\$17,381,650 @\$19,334
8	\$20,602,000 @\$22,917	\$17,511,700 @\$19,479
9	\$20,654,000 @\$22,974	\$17,555,900 @\$19,528
10	\$20,757,000 @\$23,089	\$17,643,450 @\$19,626
11	\$20,861,000 @\$23,205	\$17,731,850 @\$19,724
12	\$20,965,000 @\$23,320	\$17,820,250 @\$19,822
13	\$21,070,000 @\$23,437	\$17,909,500 @\$19,922
15	\$21,260,000 @\$23,648	\$18,071,000 @\$20,101
16	\$21,451,000 @\$23,861	\$18,233,350 @\$20,282
17	\$21,730,000 @\$24,171	\$18,470,500 @\$20,546
18	\$22,154,000 @\$24,643	\$18,830,900 @\$20,946
19	\$22,298,000 @\$24,803	\$18,953,300 @\$21,083
20	\$22,587,000 @\$25,125	\$19,198,950 @\$21,356
21	\$22,881,000 @\$25,452	\$19,448,850 @\$21,634

2座F: 1房 418'		
樓層	訂價	折實價15%
5	\$7,538,000 @\$18,033	\$6,407,300 @\$15,328
6	\$7,569,000 @\$18,108	\$6,433,650 @\$15,392
7	\$7,606,000 @\$18,196	\$6,465,100 @\$15,467
8	\$7,663,000 @\$18,333	\$6,513,550 @\$15,583
9	\$7,683,000 @\$18,380	\$6,530,550 @\$15,623
10	\$7,721,000 @\$18,471	\$6,562,850 @\$15,701
11	\$7,756,000 @\$18,555	\$6,592,600 @\$15,772
12	\$7,791,000 @\$18,639	\$6,622,350 @\$15,843
13	\$7,822,000 @\$18,713	\$6,648,700 @\$15,906
15	\$7,853,000 @\$18,787	\$6,675,050 @\$15,969
16	\$7,885,000 @\$18,864	\$6,702,250 @\$16,034
17	\$7,916,000 @\$18,938	\$6,728,600 @\$16,097
18	\$7,964,000 @\$19,053	\$6,769,400 @\$16,195
19	\$7,979,000 @\$19,089	\$6,782,150 @\$16,225
20	\$8,011,000 @\$19,165	\$6,809,350 @\$16,290
33	\$8,404,000 @\$20,105	\$7,143,400 @\$17,089
35	\$8,438,000 @\$20,187	\$7,172,300 @\$17,159
36	\$8,472,000 @\$20,268	\$7,201,200 @\$17,228
37	\$8,506,000 @\$20,349	\$7,230,100 @\$17,297
38	\$8,557,000 @\$20,471	\$7,273,450 @\$17,401

2座C: 2房 522'		
樓層	訂價	折實價15%
10	\$9,777,000 @\$18,730	\$8,310,450 @\$15,920
11	\$9,821,000 @\$18,814	\$8,347,850 @\$15,992
12	\$9,865,000 @\$18,898	\$8,385,250 @\$16,064
13	\$9,905,000 @\$18,975	\$8,419,250 @\$16,129
15	\$9,944,000 @\$19,050	\$8,452,400 @\$16,192
16	\$9,984,000 @\$19,126	\$8,486,400 @\$16,257
17	\$10,024,000 @\$19,203	\$8,520,400 @\$16,323
18	\$10,084,000 @\$19,318	\$8,571,400 @\$16,420
19	\$10,104,000 @\$19,356	\$8,588,400 @\$16,453
20	\$10,145,000 @\$19,435	\$8,623,250 @\$16,520
28	\$10,453,000 @\$20,025	\$8,885,050 @\$17,021
29	\$10,474,000 @\$20,065	\$8,902,900 @\$17,055
30	\$10,516,000 @\$20,146	\$8,938,600 @\$17,124
31	\$10,558,000 @\$20,226	\$8,974,300 @\$17,192
32	\$10,600,000 @\$20,307	\$9,010,000 @\$17,261
33	\$10,642,000 @\$20,387	\$9,045,700 @\$17,329
35	\$10,685,000 @\$20,469	\$9,082,250 @\$17,399
36	\$10,728,000 @\$20,552	\$9,118,800 @\$17,469
37	\$10,771,000 @\$20,634	\$9,155,350 @\$17,539
38	\$10,835,000 @\$20,757	\$9,209,750 @\$17,643

2座H: 2房 573'		
樓層	訂價	折實價15%
10	\$11,669,000 @\$20,365	\$9,918,650 @\$17,310
11	\$11,727,000 @\$20,466	\$9,967,950 @\$17,396
12	\$11,786,000 @\$20,569	\$10,018,100 @\$17,484
13	\$11,845,000 @\$20,672	\$10,068,250 @\$17,571
15	\$11,904,000 @\$20,775	\$10,118,400 @\$17,659
16	\$11,964,000 @\$20,880	\$10,169,400 @\$17,748
17	\$12,023,000 @\$20,983	\$10,219,550 @\$17,835
18	\$12,114,000 @\$21,141	\$10,296,900 @\$17,970
19	\$12,144,000 @\$21,194	\$10,322,400 @\$18,015
20	\$12,205,000 @\$21,300	\$10,374,250 @\$18,105
21	\$12,266,000 @\$21,407	\$10,426,100 @\$18,196
22	\$12,327,000 @\$21,513	\$10,477,950 @\$18,286
23	\$12,389,000 @\$21,621	\$10,530,650 @\$18,378
25	\$12,450,000 @\$21,728	\$10,582,500 @\$18,469

紅色為最高售價、最高平均呎價；藍色為最低售價、最低平均呎價

新盤價單表

海德園 1期

價單1號

以最高15%折扣計算

制作日期: 2025-08-26



Tower 3
第3座

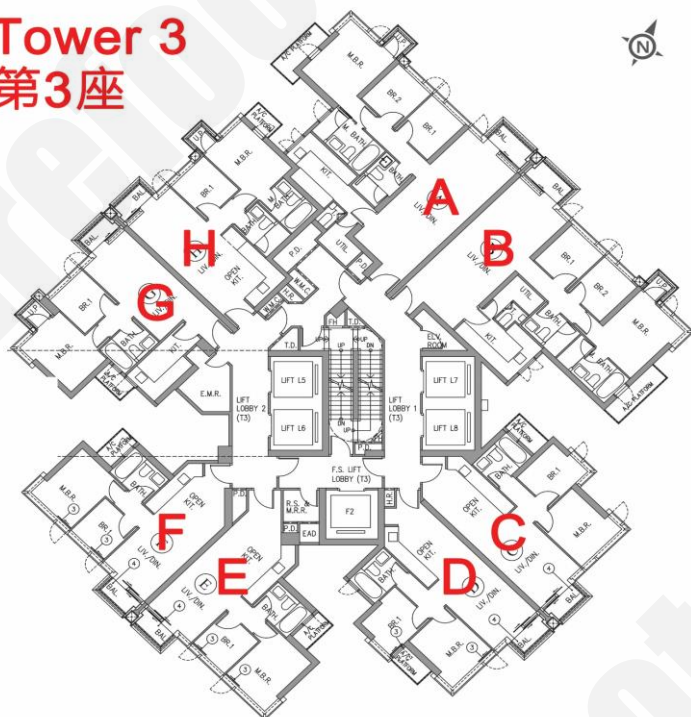

3座F: 2房 512'		
樓層	訂價	折實價15%
5	\$9,275,000 @\$18,115	\$7,883,750 @\$15,398
6	\$9,308,000 @\$18,180	\$7,911,800 @\$15,453
7	\$9,354,000 @\$18,270	\$7,950,900 @\$15,529
8	\$9,410,000 @\$18,379	\$7,998,500 @\$15,622
9	\$9,429,000 @\$18,416	\$8,014,650 @\$15,654
10	\$9,476,000 @\$18,508	\$8,054,600 @\$15,732
11	\$9,519,000 @\$18,592	\$8,091,150 @\$15,803
12	\$9,562,000 @\$18,676	\$8,127,700 @\$15,874
13	\$9,600,000 @\$18,750	\$8,160,000 @\$15,938
15	\$9,638,000 @\$18,824	\$8,192,300 @\$16,001
16	\$9,677,000 @\$18,900	\$8,225,450 @\$16,065
17	\$9,716,000 @\$18,977	\$8,258,600 @\$16,130
18	\$9,774,000 @\$19,090	\$8,307,900 @\$16,226
19	\$9,793,000 @\$19,127	\$8,324,050 @\$16,258
20	\$9,833,000 @\$19,205	\$8,358,050 @\$16,324
33	\$10,315,000 @\$20,146	\$8,767,750 @\$17,125
35	\$10,356,000 @\$20,227	\$8,802,600 @\$17,193
36	\$10,398,000 @\$20,309	\$8,838,300 @\$17,262
37	\$10,439,000 @\$20,389	\$8,873,150 @\$17,330
38	\$10,502,000 @\$20,512	\$8,926,700 @\$17,435

3座G: 2房 554'		
樓層	訂價	折實價15%
16	\$11,331,000 @\$20,453	\$9,631,350 @\$17,385
17	\$11,387,000 @\$20,554	\$9,678,950 @\$17,471
18	\$11,473,000 @\$20,709	\$9,752,050 @\$17,603
19	\$11,502,000 @\$20,762	\$9,776,700 @\$17,647
20	\$11,559,000 @\$20,865	\$9,825,150 @\$17,735
25	\$11,792,000 @\$21,285	\$10,023,200 @\$18,092
26	\$11,851,000 @\$21,392	\$10,073,350 @\$18,183
27	\$11,910,000 @\$21,498	\$10,123,500 @\$18,273
28	\$12,026,000 @\$21,708	\$10,222,100 @\$18,451
29	\$12,065,000 @\$21,778	\$10,255,250 @\$18,511

3座D: 2房 538'		
樓層	訂價	折實價15%
10	\$10,136,000 @\$18,840	\$8,615,600 @\$16,014
11	\$10,182,000 @\$18,926	\$8,654,700 @\$16,087
12	\$10,227,000 @\$19,009	\$8,692,950 @\$16,158
13	\$10,268,000 @\$19,086	\$8,727,800 @\$16,223
15	\$10,309,000 @\$19,162	\$8,762,650 @\$16,287
16	\$10,351,000 @\$19,240	\$8,798,350 @\$16,354
17	\$10,392,000 @\$19,316	\$8,833,200 @\$16,419
18	\$10,454,000 @\$19,431	\$8,885,900 @\$16,517
19	\$10,475,000 @\$19,470	\$8,903,750 @\$16,550
20	\$10,517,000 @\$19,548	\$8,939,450 @\$16,616
28	\$10,837,000 @\$20,143	\$9,211,450 @\$17,122
29	\$10,858,000 @\$20,182	\$9,229,300 @\$17,155
30	\$10,902,000 @\$20,264	\$9,266,700 @\$17,224
31	\$10,946,000 @\$20,346	\$9,304,100 @\$17,294
32	\$10,989,000 @\$20,426	\$9,340,650 @\$17,362
33	\$11,033,000 @\$20,507	\$9,378,050 @\$17,431
35	\$11,077,000 @\$20,589	\$9,415,450 @\$17,501
36	\$11,122,000 @\$20,673	\$9,453,700 @\$17,572
37	\$11,166,000 @\$20,755	\$9,491,100 @\$17,641
38	\$11,233,000 @\$20,879	\$9,548,050 @\$17,747

紅色為最高售價、最高平均呎價；藍色為最低售價、最低平均呎價