

新盤價單表

柏蔚森II

價單1號

以最高6%折扣計算

制作日期: 2024-09-30



E: 2房 383'/384'		
樓層	訂價	折實價6%
1	\$7,635,000 @\$19,883	\$6,260,700 @\$16,304
2	\$7,643,000 @\$19,904	\$6,267,260 @\$16,321
3	\$7,639,000 @\$19,945	\$6,263,980 @\$16,355
5	\$7,676,000 @\$20,042	\$6,294,320 @\$16,434
6	\$7,715,000 @\$20,144	\$6,326,300 @\$16,518
7	\$7,754,000 @\$20,245	\$6,358,280 @\$16,601
8	\$7,792,000 @\$20,345	\$6,389,440 @\$16,683
9	\$7,831,000 @\$20,446	\$6,421,420 @\$16,766
10	\$8,067,000 @\$21,063	\$6,614,940 @\$17,271
11	\$8,228,000 @\$21,483	\$6,746,960 @\$17,616
12	\$8,392,000 @\$21,911	\$6,881,440 @\$17,967
15	\$8,560,000 @\$22,350	\$7,019,200 @\$18,327

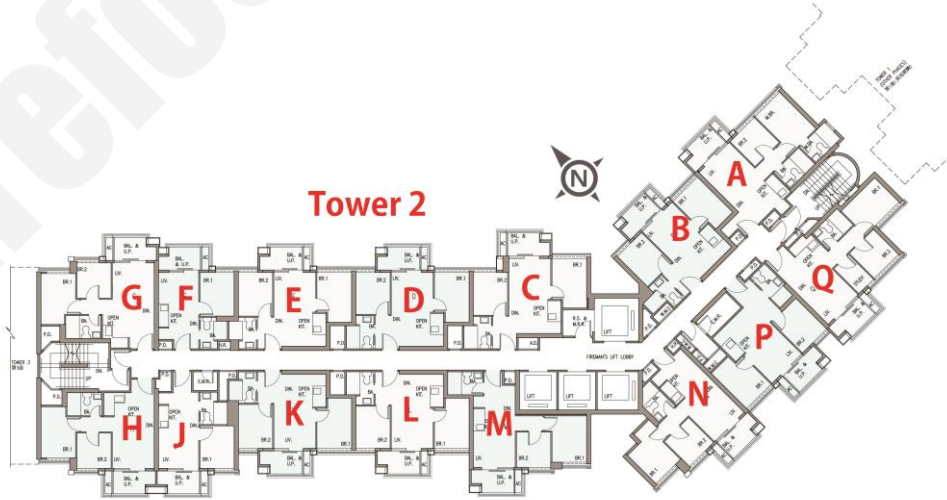

F: 1房 262'		
樓層	訂價	折實價6%
1	\$5,339,000 @\$20,378	\$4,377,980 @\$16,710
2	\$5,343,000 @\$20,393	\$4,381,260 @\$16,722
3	\$5,434,000 @\$20,740	\$4,455,880 @\$17,007
5	\$5,460,000 @\$20,840	\$4,477,200 @\$17,089
6	\$5,487,000 @\$20,943	\$4,499,340 @\$17,173
7	\$5,517,000 @\$21,057	\$4,523,940 @\$17,267
8	\$5,543,000 @\$21,156	\$4,545,260 @\$17,348
9	\$5,571,000 @\$21,263	\$4,568,220 @\$17,436
10	\$5,739,000 @\$21,905	\$4,705,980 @\$17,962
11	\$5,852,000 @\$22,336	\$4,798,640 @\$18,315
12	\$5,970,000 @\$22,786	\$4,895,400 @\$18,685
15	\$6,090,000 @\$23,244	\$4,993,800 @\$19,060
16	\$6,210,000 @\$23,702	\$5,092,200 @\$19,436

新盤價單表

柏蔚森II

價單1號

以最高6%/18%折扣計算

制作日期: 2024-09-30

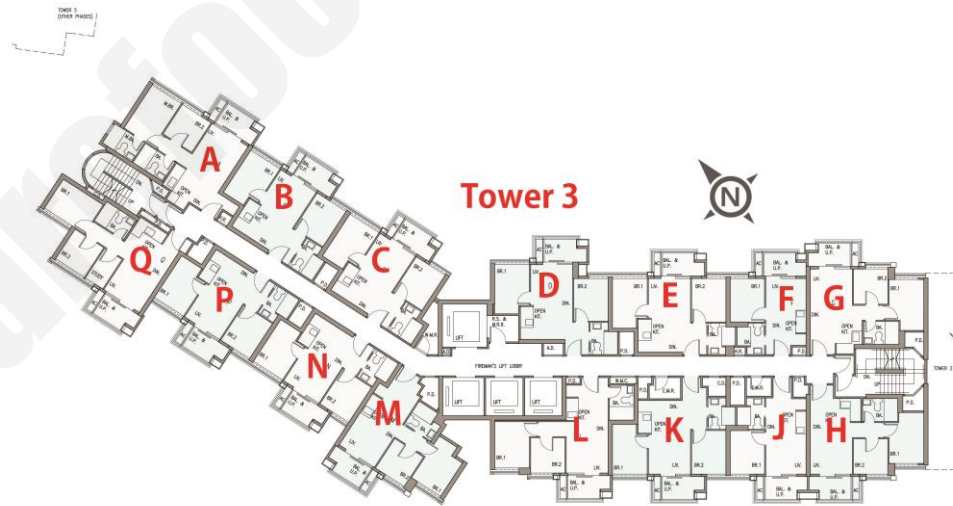

A: 2房 450'/451'		
樓層	訂價	折實價6%
1	\$9,501,000 @\$21,113	\$8,930,940 @\$19,847
2	\$9,542,000 @\$21,204	\$8,969,480 @\$19,932
3	\$9,573,000 @\$21,226	\$8,998,620 @\$19,953
5	\$9,582,000 @\$21,246	\$9,007,080 @\$19,971
6	\$9,678,000 @\$21,459	\$9,097,320 @\$20,171
7	\$9,775,000 @\$21,674	\$9,188,500 @\$20,374
8	\$9,873,000 @\$21,891	\$9,280,620 @\$20,578
9	\$9,971,000 @\$22,109	\$9,372,740 @\$20,782
10	\$10,370,000 @\$22,993	\$9,747,800 @\$21,614
11	\$10,475,000 @\$23,226	\$9,846,500 @\$21,833
12	\$10,579,000 @\$23,457	\$9,944,260 @\$22,049
15	\$10,685,000 @\$23,692	\$10,043,900 @\$22,270
16	\$10,898,000 @\$24,164	\$10,244,120 @\$22,714
17	\$11,226,000 @\$24,891	\$10,552,440 @\$23,398
18	\$11,563,000 @\$25,639	\$10,869,220 @\$24,100

B: 2房 383'		
樓層	訂價	折實價6%/18%
1	\$7,803,000 @\$20,373	\$6,398,460 @\$16,706
2	\$7,906,000 @\$20,642	\$6,482,920 @\$16,927
3	\$7,945,000 @\$20,744	\$7,468,300 @\$19,499
5	\$7,984,000 @\$20,846	\$7,504,960 @\$19,595
6	\$8,024,000 @\$20,950	\$7,542,560 @\$19,693
7	\$8,064,000 @\$21,055	\$7,580,160 @\$19,792
8	\$8,104,000 @\$21,159	\$7,617,760 @\$19,890
9	\$8,145,000 @\$21,266	\$7,656,300 @\$19,990
10	\$8,471,000 @\$22,117	\$6,946,220 @\$18,136
11	\$8,641,000 @\$22,561	\$8,122,540 @\$21,208
12	\$8,813,000 @\$23,010	\$8,284,220 @\$21,630
15	\$8,990,000 @\$23,473	\$8,450,600 @\$22,064
16	\$9,169,000 @\$23,940	\$8,618,860 @\$22,504
17	\$9,445,000 @\$24,661	\$8,878,300 @\$23,181
18	\$9,728,000 @\$25,399	\$9,144,320 @\$23,876

N: 2房 383'		
樓層	訂價	折實價6%
1	\$7,615,000 @\$19,883	\$7,158,100 @\$18,690
2	\$7,631,000 @\$19,924	\$7,173,140 @\$18,729
3	\$7,653,000 @\$19,982	\$7,193,820 @\$18,783
5	\$7,676,000 @\$20,042	\$7,215,440 @\$18,839
6	\$7,701,000 @\$20,107	\$7,238,940 @\$18,901
7	\$7,723,000 @\$20,164	\$7,259,620 @\$18,955
8	\$7,746,000 @\$20,225	\$7,281,240 @\$19,011
9	\$7,823,000 @\$20,426	\$7,353,620 @\$19,200
10	\$7,902,000 @\$20,632	\$7,427,880 @\$19,394
11	\$7,981,000 @\$20,838	\$7,502,140 @\$19,588
12	\$8,060,000 @\$21,044	\$7,576,400 @\$19,782
15	\$8,141,000 @\$21,256	\$7,652,540 @\$19,981

C: 2房 392'		
樓層	訂價	折實價6%
1	\$7,795,000 @\$19,885	\$7,327,300 @\$18,692
2	\$7,857,000 @\$20,043	\$7,385,580 @\$18,841
3	\$7,897,000 @\$20,145	\$7,423,180 @\$18,937
5	\$7,936,000 @\$20,245	\$7,459,840 @\$19,030
6	\$7,975,000 @\$20,344	\$7,496,500 @\$19,124
7	\$8,015,000 @\$20,446	\$7,534,100 @\$19,220
8	\$8,054,000 @\$20,546	\$7,570,760 @\$19,313

D: 2房 396'		
樓層	訂價	折實價6%
1	\$7,874,000 @\$19,884	\$7,401,560 @\$18,691
2	\$7,882,000 @\$19,904	\$7,409,080 @\$18,710
3	\$7,898,000 @\$19,944	\$7,424,120 @\$18,748
5	\$7,937,000 @\$20,043	\$7,460,780 @\$18,840
6	\$7,978,000 @\$20,146	\$7,499,320 @\$18,938
7	\$8,017,000 @\$20,245	\$7,535,980 @\$19,030
8	\$8,057,000 @\$20,346	\$7,573,580 @\$19,125

P: 2房 383'		
樓層	訂價	折實價6%/18%
1	\$7,615,000 @\$19,883	\$7,158,100 @\$18,690
2	\$7,631,000 @\$19,924	\$7,173,140 @\$18,729
3	\$7,653,000 @\$19,982	\$6,275,460 @\$16,385
5	\$7,676,000 @\$20,042	\$6,294,320 @\$16,434
6	\$7,701,000 @\$20,107	\$6,314,820 @\$16,488
7	\$7,723,000 @\$20,164	\$6,332,860 @\$16,535
8	\$7,876,000 @\$20,564	\$6,458,320 @\$16,862
9	\$7,956,000 @\$20,773	\$7,478,640 @\$19,526
10	\$8,035,000 @\$20,979	\$7,552,900 @\$19,720
11	\$8,117,000 @\$21,193	\$7,629,980 @\$19,922
12	\$8,197,000 @\$21,402	\$7,705,180 @\$20,118
15	\$8,280,000 @\$21,619	\$7,783,200 @\$20,322

E: 2房 383'		
樓層	訂價	折實價6%/18%
1	\$7,615,000 @\$19,883	\$7,158,100 @\$18,690
2	\$7,623,000 @\$19,903	\$7,165,620 @\$18,709
3	\$7,639,000 @\$19,945	\$6,263,980 @\$16,355
5	\$7,676,000 @\$20,042	\$6,294,320 @\$16,434
6	\$7,715,000 @\$20,144	\$6,326,300 @\$16,518
7	\$7,754,000 @\$20,245	\$6,358,280 @\$16,601
8	\$7,792,000 @\$20,345	\$6,389,440 @\$16,683
9	\$7,831,000 @\$20,446	\$6,421,420 @\$16,766
10	\$8,067,000 @\$21,063	\$6,614,940 @\$17,271
11	\$8,228,000 @\$21,483	\$7,734,320 @\$20,194
12	\$8,392,000 @\$21,911	\$7,888,480 @\$20,597
15	\$8,560,000 @\$22,350	\$8,046,400 @\$21,009

F: 1房 262'		
樓層	訂價	折實價6%/18%
1	\$5,212,000 @\$19,893	\$4,899,280 @\$18,700
2	\$5,214,000 @\$19,901	\$4,275,480 @\$16,319
3	\$5,330,000 @\$20,344	\$4,370,600 @\$16,682
5	\$5,357,000 @\$20,447	\$4,392,740 @\$16,766
6	\$5,382,000 @\$20,542	\$4,413,240 @\$16,844
7	\$5,409,000 @\$20,645	\$4,435,380 @\$16,929
8	\$5,436,000 @\$20,748	\$4,457,520 @\$17,013
9	\$5,463,000 @\$20,851	\$4,479,660 @\$17,098
10	\$5,628,000 @\$21,481	\$4,614,960 @\$17,614
11	\$5,741,000 @\$21,912	\$5,396,540 @\$20,597
12	\$5,854,000 @\$22,344	\$5,502,760 @\$21,003
15	\$5,973,000 @\$22,798	\$5,614,620 @\$21,430
16	\$6,092,000 @\$23,252	\$5,726,480 @\$21,857

G: 2房 392'		
樓層	訂價	折實價6%/18%
1	\$7,795,000 @\$19,885	\$7,327,300 @\$18,692
2	\$7,802,000 @\$19,903	\$7,333,880 @\$18,709
3	\$7,818,000 @\$19,944	\$7,348,920 @\$18,747
5	\$7,857,000 @\$20,043	\$7,385,580 @\$18,841
6	\$7,897,000 @\$20,145	\$7,423,180 @\$18,937
7	\$7,936,000 @\$20,245	\$7,459,840 @\$19,030
8	\$7,975,000 @\$20,344	\$7,496,500 @\$19,124
9	\$8,015,000 @\$20,446	\$7,534,100 @\$19,220
10	\$8,175,000 @\$20,855	\$7,684,500 @\$19,603
11	\$8,340,000 @\$21,276	\$7,839,600 @\$20,000
12	\$8,507,000 @\$21,702	\$7,996,580 @\$20,399
15	\$8,676,000 @\$22,133	\$8,155,440 @\$20,805

H: 2房 385'		
樓層	訂價	折實價6%/18%
1	\$7,656,000 @\$19,886	\$7,196,640 @\$18,693
2	\$7,678,000 @\$19,943	\$6,295,960 @\$16,353
3	\$7,718,000 @\$20,047	\$6,328,760 @\$16,438
5	\$7,756,000 @\$20,145	\$6,359,920 @\$16,519
6	\$7,795,000 @\$20,247	\$6,391,900 @\$16,602
7	\$7,832,000 @\$20,343	\$6,422,240 @\$16,681
8	\$8,069,000 @\$20,958	\$6,616,580 @\$17,186

J: 1房 283'		
樓層	訂價	折實價6%/18%
1	\$5,626,000 @\$19,880	\$5,288,440 @\$18,687
2	\$5,671,000 @\$20,039	\$4,650,220 @\$16,432
3	\$5,701,000 @\$20,145	\$4,674,820 @\$16,519
5	\$5,729,000 @\$20,244	\$4,697,780 @\$16,600
6	\$5,757,000 @\$20,343	\$4,720,740 @\$16,681
7	\$5,786,000 @\$20,445	\$4,744,520 @\$16,765
8	\$5,959,000 @\$21,057	\$4,886,380 @\$17,266

以上的物業資料只供參考，一切以發展商最新公布為準，如有任何資料錯漏本網頁不會承擔任何責任。
紅色為最高售價、最高平均呎價；藍色為最低售價、最低平均呎價

新盤價單表

柏蔚森II

價單1號

以最高6%/18%折扣計算

制作日期: 2024-09-30



Q : 2房 443'		
樓層	訂價	折實價6%/18%
1	\$8,809,000 @\$19,885	\$8,280,460 @\$18,692
2	\$8,826,000 @\$19,923	\$8,296,440 @\$18,728
3	\$8,853,000 @\$19,984	\$8,321,820 @\$18,785
5	\$8,880,000 @\$20,045	\$8,347,200 @\$18,842
6	\$8,906,000 @\$20,104	\$8,371,640 @\$18,898
7	\$8,932,000 @\$20,163	\$7,324,240 @\$16,533
8	\$9,112,000 @\$20,569	\$8,565,280 @\$19,335
9	\$9,203,000 @\$20,774	\$8,650,820 @\$19,528
10	\$9,295,000 @\$20,982	\$8,737,300 @\$19,723
11	\$9,389,000 @\$21,194	\$8,825,660 @\$19,922
12	\$9,481,000 @\$21,402	\$8,912,140 @\$20,118

