

Tower 1A



T1A A : 2房 493'		
樓層	訂價	折實價10%
2	\$9,806,000 @\$19,890	\$8,825,400 @\$17,901
3	\$9,982,000 @\$20,247	\$8,983,800 @\$18,223
5	\$10,132,000 @\$20,552	\$9,118,800 @\$18,497
6	\$10,263,000 @\$20,817	\$9,236,700 @\$18,736
7	\$10,437,000 @\$21,170	\$9,393,300 @\$19,053
8	\$10,553,000 @\$21,406	\$9,497,700 @\$19,285
9	\$10,647,000 @\$21,596	\$9,582,300 @\$19,437
10	\$10,723,000 @\$21,751	\$9,650,700 @\$19,575
11	\$10,776,000 @\$21,858	\$9,698,400 @\$19,672
12	\$10,830,000 @\$21,968	\$9,747,000 @\$19,771
15	\$10,885,000 @\$22,079	\$9,796,500 @\$19,871
22	\$11,273,000 @\$22,866	\$10,145,700 @\$20,580
23	\$11,328,000 @\$22,978	\$10,195,200 @\$20,680
25	\$11,385,000 @\$23,093	\$10,246,500 @\$20,784
10	\$9,609,000 @\$25,287	\$9,128,500 @\$24,023
T1A F : 2房 447'		
樓層	訂價	折實價10%
2	\$9,024,000 @\$20,188	\$8,121,600 @\$18,169
3	\$9,184,000 @\$20,546	\$8,265,600 @\$18,491
5	\$9,320,000 @\$20,850	\$8,388,000 @\$18,765
6	\$9,440,000 @\$21,119	\$8,496,000 @\$19,007
7	\$9,599,000 @\$21,474	\$8,639,100 @\$19,327
8	\$9,705,000 @\$21,711	\$8,734,500 @\$19,540
9	\$9,793,000 @\$21,908	\$8,813,700 @\$19,717
10	\$9,862,000 @\$22,063	\$8,875,800 @\$19,856
11	\$9,910,000 @\$22,170	\$8,919,000 @\$19,953
12	\$9,960,000 @\$22,282	\$8,964,000 @\$20,054
15	\$10,010,000 @\$22,394	\$9,009,000 @\$20,154
T1A GF : 2房 437'		
樓層	訂價	折實價10%
2	\$8,620,000 @\$19,725	\$7,758,000 @\$17,753
3	\$8,776,000 @\$20,082	\$7,898,400 @\$18,074
5	\$8,908,000 @\$20,384	\$8,017,200 @\$18,346
6	\$9,025,000 @\$20,652	\$8,122,500 @\$18,587
7	\$9,178,000 @\$21,002	\$8,260,200 @\$18,902
8	\$9,279,000 @\$21,233	\$8,351,100 @\$19,110
9	\$9,364,000 @\$21,428	\$8,427,600 @\$19,285
10	\$9,429,000 @\$21,577	\$8,486,100 @\$19,419
11	\$9,477,000 @\$21,686	\$8,529,300 @\$19,518
12	\$9,525,000 @\$21,796	\$8,572,500 @\$19,617
15	\$9,573,000 @\$21,906	\$8,615,700 @\$19,716



T1A B : 1房 305'		
樓層	訂價	折實價10%
2	\$5,637,000 @\$18,482	\$5,073,300 @\$16,634
3	\$5,677,000 @\$18,613	\$5,109,300 @\$16,752
5	\$5,717,000 @\$18,744	\$5,145,300 @\$16,870
6	\$5,757,000 @\$18,875	\$5,181,300 @\$16,988
7	\$5,798,000 @\$19,010	\$5,218,200 @\$17,109
8	\$5,839,000 @\$19,144	\$5,255,100 @\$17,230
9	\$5,880,000 @\$19,279	\$5,292,000 @\$17,351
10	\$5,922,000 @\$19,416	\$5,329,800 @\$17,475
11	\$5,952,000 @\$19,515	\$5,356,800 @\$17,563
12	\$5,982,000 @\$19,613	\$5,383,800 @\$17,652
15	\$6,012,000 @\$19,711	\$5,410,800 @\$17,740
22	\$6,226,000 @\$20,413	\$5,603,400 @\$18,372
23	\$6,257,000 @\$20,515	\$5,631,300 @\$18,463
25	\$6,288,000 @\$20,616	\$5,659,200 @\$18,555
26	\$6,352,000 @\$20,826	\$5,716,800 @\$18,744
27	\$6,415,000 @\$21,033	\$5,773,500 @\$18,930
28	\$6,479,000 @\$21,243	\$5,831,100 @\$19,118
29	\$6,544,000 @\$21,456	\$5,889,600 @\$19,310

T1A C : 1房 305'		
樓層	訂價	折實價10%
2	\$5,699,000 @\$18,685	\$5,129,100 @\$16,817
3	\$5,740,000 @\$18,820	\$5,166,000 @\$16,938
5	\$5,780,000 @\$18,951	\$5,202,000 @\$17,056
6	\$5,822,000 @\$19,089	\$5,239,800 @\$17,180
7	\$5,863,000 @\$19,223	\$5,276,700 @\$17,301
8	\$5,904,000 @\$19,357	\$5,313,600 @\$17,422
9	\$5,945,000 @\$19,492	\$5,350,500 @\$17,543
10	\$5,987,000 @\$19,630	\$5,388,300 @\$17,667
11	\$6,017,000 @\$19,728	\$5,415,300 @\$17,755
12	\$6,047,000 @\$19,826	\$5,442,300 @\$17,844
15	\$6,078,000 @\$19,928	\$5,470,200 @\$17,935
22	\$6,295,000 @\$20,639	\$5,665,500 @\$18,575
23	\$6,326,000 @\$20,741	\$5,693,400 @\$18,667
25	\$6,357,000 @\$20,843	\$5,721,300 @\$18,758
26	\$6,422,000 @\$21,056	\$5,779,800 @\$18,950
27	\$6,485,000 @\$21,262	\$5,836,500 @\$19,136
28	\$6,550,000 @\$21,475	\$5,895,000 @\$19,328
29	\$6,616,000 @\$21,692	\$5,954,400 @\$19,523

T1A D : 1房 305'		
樓層	訂價	折實價10%
2	\$5,762,000 @\$18,892	\$5,185,800 @\$17,003
3	\$5,803,000 @\$19,026	\$5,222,700 @\$17,124
5	\$5,844,000 @\$19,161	\$5,259,600 @\$17,245
6	\$5,885,000 @\$19,295	\$5,296,500 @\$17,366
7	\$5,926,000 @\$19,430	\$5,333,400 @\$17,487
8	\$5,968,000 @\$19,567	\$5,371,200 @\$17,610
9	\$6,010,000 @\$19,705	\$5,409,000 @\$17,734
10	\$6,053,000 @\$19,846	\$5,447,700 @\$17,861
11	\$6,083,000 @\$19,944	\$5,474,700 @\$17,950
12	\$6,114,000 @\$20,046	\$5,502,600 @\$18,041
15	\$6,144,000 @\$20,144	\$5,529,600 @\$18,130
T1A E : 1房 301'		
樓層	訂價	折實價10%
2	\$5,744,000 @\$19,083	\$5,169,600 @\$17,175
3	\$5,784,000 @\$19,216	\$5,205,600 @\$17,294
5	\$5,825,000 @\$19,352	\$5,242,500 @\$17,417
6	\$5,866,000 @\$19,488	\$5,279,400 @\$17,540
7	\$5,907,000 @\$19,625	\$5,316,300 @\$17,662
8	\$5,948,000 @\$19,761	\$5,353,200 @\$17,785
9	\$5,990,000 @\$19,900	\$5,391,000 @\$17,910
10	\$6,033,000 @\$20,043	\$5,429,700 @\$18,039
11	\$6,063,000 @\$20,143	\$5,456,700 @\$18,129
12	\$6,094,000 @\$20,246	\$5,484,600 @\$18,221
15	\$6,124,000 @\$20,346	\$5,511,600 @\$18,311

紅色為最高售價、最高平均呎價；藍色為最低售價、最低平均呎價
 以上的物業資料只供參考，一切以發展商最新公布為準，如有任何資料錯漏本網頁不會承擔任何責任。

新盤價單表

維港·雙鑽

價單1號

以最高10%折扣計算

制作日期: 2024-09-05



Tower 1B

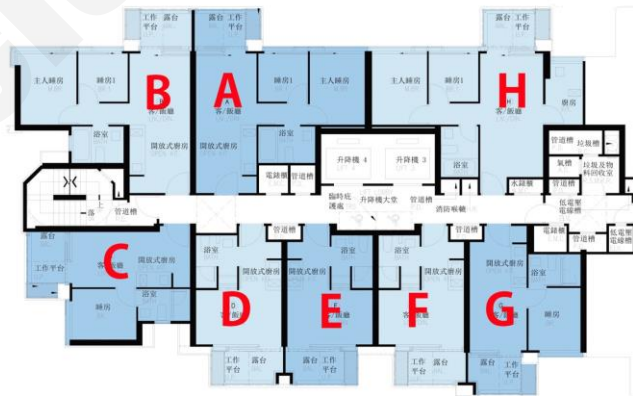

TOWER 1A
第1座

T1B A : 2房 440'		
樓層	訂價	折實價10%
2	\$8,839,000 @\$20,089	\$7,955,100 @\$18,080
3	\$9,005,000 @\$20,466	\$8,104,500 @\$18,419
5	\$9,156,000 @\$20,809	\$8,240,400 @\$18,728
6	\$9,292,000 @\$21,118	\$8,362,800 @\$19,006
7	\$9,465,000 @\$21,511	\$8,518,500 @\$19,360
8	\$9,587,000 @\$21,789	\$8,628,300 @\$19,610
9	\$9,687,000 @\$22,016	\$8,718,300 @\$19,814
10	\$9,756,000 @\$22,173	\$8,780,400 @\$19,955
11	\$9,805,000 @\$22,284	\$8,824,500 @\$20,056
12	\$9,854,000 @\$22,395	\$8,868,600 @\$20,156
15	\$9,904,000 @\$22,509	\$8,913,600 @\$20,258

T1B E : 開放式 247'		
樓層	訂價	折實價10%
2	\$4,482,000 @\$18,146	\$4,033,800 @\$16,331
3	\$4,515,000 @\$18,279	\$4,063,500 @\$16,451
5	\$4,546,000 @\$18,405	\$4,091,400 @\$16,564
6	\$4,578,000 @\$18,534	\$4,120,200 @\$16,681
7	\$4,610,000 @\$18,664	\$4,149,000 @\$16,798
8	\$4,643,000 @\$18,798	\$4,178,700 @\$16,918
9	\$4,676,000 @\$18,931	\$4,208,400 @\$17,038
10	\$4,709,000 @\$19,065	\$4,238,100 @\$17,158
11	\$4,733,000 @\$19,162	\$4,259,700 @\$17,246
12	\$4,756,000 @\$19,255	\$4,280,400 @\$17,330
15	\$4,780,000 @\$19,352	\$4,302,000 @\$17,417
22	\$4,950,000 @\$20,040	\$4,455,000 @\$18,036
23	\$4,976,000 @\$20,146	\$4,478,400 @\$18,131
25	\$5,000,000 @\$20,243	\$4,500,000 @\$18,219
26	\$5,050,000 @\$20,445	\$4,545,000 @\$18,401
27	\$5,100,000 @\$20,648	\$4,590,000 @\$18,583
28	\$5,152,000 @\$20,858	\$4,636,800 @\$18,772
29	\$5,204,000 @\$21,069	\$4,683,600 @\$18,962

T1B G : 1房 300'		
樓層	訂價	折實價10%
2	\$5,578,000 @\$18,593	\$5,020,200 @\$16,734
3	\$5,617,000 @\$18,723	\$5,055,300 @\$16,851
5	\$5,657,000 @\$18,857	\$5,091,300 @\$16,971
6	\$5,697,000 @\$18,990	\$5,127,300 @\$17,091
7	\$5,737,000 @\$19,123	\$5,163,300 @\$17,211
8	\$5,777,000 @\$19,257	\$5,199,300 @\$17,331
9	\$5,818,000 @\$19,393	\$5,236,200 @\$17,454
10	\$5,859,000 @\$19,530	\$5,273,100 @\$17,577
11	\$5,888,000 @\$19,627	\$5,299,200 @\$17,664
12	\$5,918,000 @\$19,727	\$5,326,200 @\$17,754
15	\$5,948,000 @\$19,827	\$5,353,200 @\$17,844
22	\$6,160,000 @\$20,533	\$5,544,000 @\$18,480
23	\$6,190,000 @\$20,633	\$5,571,000 @\$18,570
25	\$6,222,000 @\$20,740	\$5,599,800 @\$18,666
26	\$6,284,000 @\$20,947	\$5,655,600 @\$18,852
27	\$6,347,000 @\$21,157	\$5,712,300 @\$19,041
28	\$6,410,000 @\$21,367	\$5,769,000 @\$19,230
29	\$6,475,000 @\$21,583	\$5,827,500 @\$19,425

紅色為最高售價、最高平均呎價；藍色為最低售價、最低平均呎價
 以上的物業資料只供參考，一切以發展商最新公布為準，如有任何資料錯漏本網頁不會承擔任何責任。