

新盤價單表

柏蔚森 III

價單1號

以最高18%折扣計算
制作日期: 2024-07-15

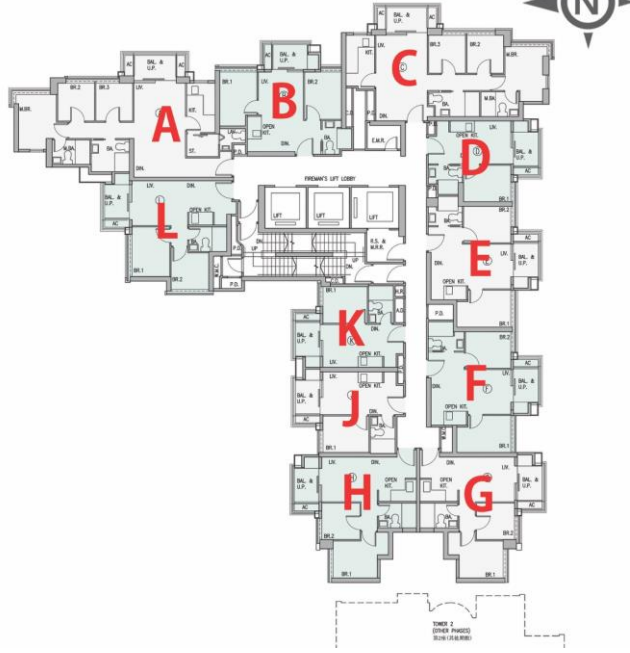

C: 3房 579'		
樓層	訂價	折實價18%
2	\$14,279,000 @\$24,661	\$11,708,780 @\$20,222
3	\$14,351,000 @\$24,786	\$11,767,820 @\$20,324
5	\$14,423,000 @\$24,910	\$11,826,860 @\$20,426
6	\$14,495,000 @\$25,035	\$11,885,900 @\$20,528

D: 1房 263'		
樓層	訂價	折實價18%
2	\$5,642,000 @\$21,452	\$4,626,440 @\$17,591
3	\$5,659,000 @\$21,517	\$4,640,380 @\$17,644
5	\$5,676,000 @\$21,582	\$4,654,320 @\$17,697
6	\$5,695,000 @\$21,654	\$4,669,900 @\$17,756
7	\$5,712,000 @\$21,719	\$4,683,840 @\$17,809
8	\$5,728,000 @\$21,779	\$4,696,960 @\$17,859

E: 2房 383'		
樓層	訂價	折實價18%
2	\$8,139,000 @\$21,251	\$6,673,980 @\$17,426
3	\$8,163,000 @\$21,313	\$6,693,660 @\$17,477
5	\$8,187,000 @\$21,376	\$6,713,340 @\$17,528
6	\$8,212,000 @\$21,441	\$6,733,840 @\$17,582
7	\$8,236,000 @\$21,504	\$6,753,520 @\$17,633
8	\$8,263,000 @\$21,574	\$6,775,660 @\$17,691

H: 2房 394'		
樓層	訂價	折實價18%
2	\$7,967,000 @\$20,221	\$6,532,940 @\$16,581
3	\$7,990,000 @\$20,279	\$6,551,800 @\$16,629
5	\$8,014,000 @\$20,340	\$6,571,480 @\$16,679
6	\$8,037,000 @\$20,398	\$6,590,340 @\$16,727
7	\$8,063,000 @\$20,464	\$6,611,660 @\$16,781
8	\$8,087,000 @\$20,525	\$6,631,340 @\$16,831
9	\$8,110,000 @\$20,584	\$6,650,200 @\$16,879
10	\$8,274,000 @\$21,000	\$6,784,680 @\$17,220
11	\$8,439,000 @\$21,419	\$6,919,980 @\$17,563
12	\$8,607,000 @\$21,845	\$7,057,740 @\$17,913
15	\$8,634,000 @\$21,914	\$7,079,880 @\$17,969
16	\$8,659,000 @\$21,977	\$7,100,380 @\$18,021
17	\$8,685,000 @\$22,043	\$7,121,700 @\$18,075

L: 2房 390'		
樓層	訂價	折實價18%
2	\$8,006,000 @\$20,528	\$6,564,920 @\$16,833
3	\$8,030,000 @\$20,590	\$6,584,600 @\$16,884
5	\$8,053,000 @\$20,649	\$6,603,460 @\$16,932
6	\$8,079,000 @\$20,715	\$6,624,780 @\$16,987
7	\$8,103,000 @\$20,777	\$6,644,460 @\$17,037
8	\$8,128,000 @\$20,841	\$6,664,960 @\$17,090
9	\$8,152,000 @\$20,903	\$6,684,640 @\$17,140
10	\$8,175,000 @\$20,962	\$6,703,500 @\$17,188
11	\$8,200,000 @\$21,026	\$6,724,000 @\$17,241
12	\$8,224,000 @\$21,087	\$6,743,680 @\$17,291
15	\$8,251,000 @\$21,156	\$6,765,820 @\$17,348
16	\$8,275,000 @\$21,218	\$6,785,500 @\$17,399
17	\$8,300,000 @\$21,282	\$6,806,000 @\$17,451

A: 3房 666'		
樓層	訂價	折實價18%
3	\$16,782,000 @\$25,198	\$13,761,240 @\$20,663
5	\$16,867,000 @\$25,326	\$13,830,940 @\$20,767
6	\$16,951,000 @\$25,452	\$13,899,820 @\$20,871

B: 2房 382'		
樓層	訂價	折實價18%
3	\$9,467,000 @\$24,783	\$7,762,940 @\$20,322
5	\$9,514,000 @\$24,906	\$7,801,480 @\$20,423
6	\$9,563,000 @\$25,034	\$7,841,660 @\$20,528

J: 1房 261'		
樓層	訂價	折實價18%
3	\$5,292,000 @\$20,276	\$4,339,440 @\$16,626
5	\$5,308,000 @\$20,337	\$4,352,560 @\$16,676
6	\$5,325,000 @\$20,402	\$4,366,500 @\$16,730
7	\$5,341,000 @\$20,464	\$4,379,620 @\$16,780
8	\$5,357,000 @\$20,525	\$4,392,740 @\$16,830
9	\$5,373,000 @\$20,586	\$4,405,860 @\$16,881
10	\$5,479,000 @\$20,992	\$4,492,780 @\$17,214
11	\$5,590,000 @\$21,418	\$4,583,800 @\$17,562
12	\$5,702,000 @\$21,847	\$4,675,640 @\$17,914
15	\$5,719,000 @\$21,912	\$4,689,580 @\$17,968
16	\$5,736,000 @\$21,977	\$4,703,520 @\$18,021
17	\$5,753,000 @\$22,042	\$4,717,460 @\$18,075

K: 1房 260'		
樓層	訂價	折實價18%
3	\$5,213,000 @\$20,050	\$4,274,660 @\$16,441
5	\$5,234,000 @\$20,131	\$4,291,880 @\$16,507
6	\$5,250,000 @\$20,192	\$4,305,000 @\$16,558
7	\$5,265,000 @\$20,250	\$4,317,300 @\$16,605
8	\$5,281,000 @\$20,312	\$4,330,420 @\$16,655
9	\$5,297,000 @\$20,373	\$4,343,540 @\$16,706
10	\$5,403,000 @\$20,781	\$4,430,460 @\$17,040
11	\$5,512,000 @\$21,200	\$4,519,840 @\$17,384
12	\$5,621,000 @\$21,619	\$4,609,220 @\$17,728
15	\$5,639,000 @\$21,688	\$4,623,980 @\$17,785
16	\$5,654,000 @\$21,746	\$4,636,280 @\$17,832
17	\$5,671,000 @\$21,812	\$4,650,220 @\$17,885

紅色為最高售價、最高平均呎價；藍色為最低售價、最低平均呎價
以上的物業資料只供參考，一切以發展商最新公布為準，如有任何資料錯漏本網頁不會承擔任何責任。