

新盤價單表

恒珀

價單1號

以最高16%折扣計算

制作日期: 2024-06-19

B : 1房 262'/300'		
樓層	訂價	折實價16%
5	\$6,755,000 @\$25,782	\$5,674,200 @\$21,657
6	\$6,110,000 @\$20,367	\$5,132,400 @\$17,108
7	\$6,146,000 @\$20,487	\$5,162,640 @\$17,209
8	\$6,220,000 @\$20,733	\$5,224,800 @\$17,416
9	\$6,256,000 @\$20,853	\$5,255,040 @\$17,517
10	\$6,293,000 @\$20,977	\$5,286,120 @\$17,620
11	\$6,329,000 @\$21,097	\$5,316,360 @\$17,721
12	\$6,366,000 @\$21,220	\$5,347,440 @\$17,825
15	\$6,402,000 @\$21,340	\$5,377,680 @\$17,926
16	\$6,439,000 @\$21,463	\$5,408,760 @\$18,029
17	\$6,476,000 @\$21,587	\$5,439,840 @\$18,133
19	\$6,878,000 @\$22,927	\$5,777,520 @\$19,258
20	\$7,061,000 @\$23,537	\$5,931,240 @\$19,771
21	\$7,244,000 @\$24,147	\$6,084,960 @\$20,283
25	\$7,793,000 @\$25,977	\$6,546,120 @\$21,820
27	\$8,232,000 @\$27,440	\$6,914,880 @\$23,050

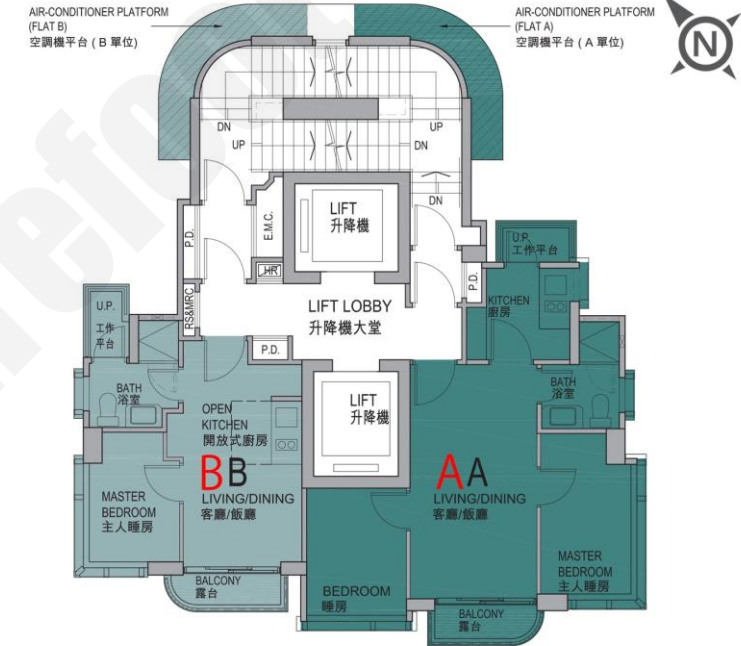

A : 2房 442'/462'		
樓層	訂價	折實價16%
6	\$9,522,000 @\$20,610	\$7,998,480 @\$17,313
7	\$9,578,000 @\$20,732	\$8,045,520 @\$17,415
8	\$9,690,000 @\$20,974	\$8,139,600 @\$17,618
9	\$9,748,000 @\$21,100	\$8,188,320 @\$17,724
10	\$9,804,000 @\$21,221	\$8,235,360 @\$17,825
11	\$9,860,000 @\$21,342	\$8,282,400 @\$17,927
12	\$9,916,000 @\$21,463	\$8,329,440 @\$18,029
15	\$9,972,000 @\$21,584	\$8,376,480 @\$18,131
16	\$10,029,000 @\$21,708	\$8,424,360 @\$18,235
17	\$10,085,000 @\$21,829	\$8,471,400 @\$18,336
19	\$10,649,000 @\$23,050	\$8,945,160 @\$19,362
20	\$10,930,000 @\$23,658	\$9,181,200 @\$19,873
21	\$11,212,000 @\$24,268	\$9,418,080 @\$20,385
27	\$12,290,000 @\$27,805	\$10,323,600 @\$23,357
25	\$7,793,000 @\$25,977	\$6,546,120 @\$21,820
27	\$8,232,000 @\$27,440	\$6,914,880 @\$23,050

紅色為最高售價、最高平均呎價；藍色為最低售價、最低平均呎價
以上的物業資料只供參考，一切以發展商最新公布為準，如有任何資料錯漏本網頁不會承擔任何責任。