

新盤價單表

尚逸

價單1號

以最高9%折扣計算

制作日期: 2024-06-20

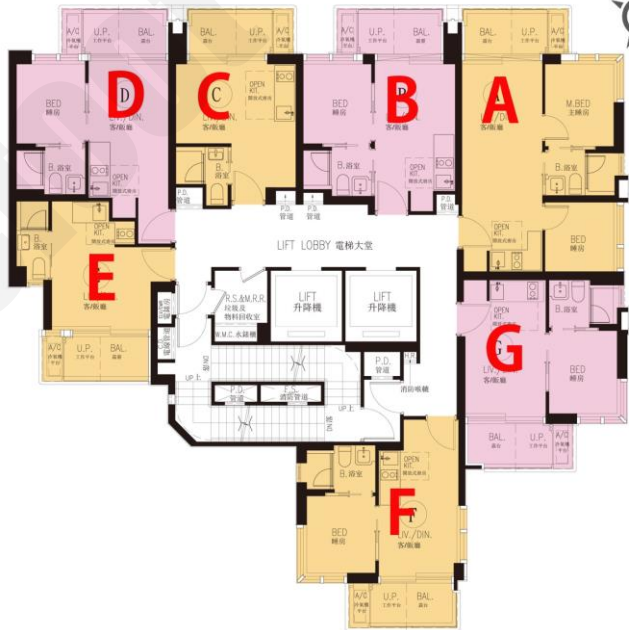

A : 2房 389'/492'		
樓層	訂價	折實價9%
6	\$7,912,000 @\$20,339	\$7,199,920 @\$18,509
7	\$8,142,700 @\$20,932	\$7,409,857 @\$19,048
8	\$8,307,700 @\$21,357	\$7,560,007 @\$19,434
12	\$8,677,500 @\$22,307	\$7,896,525 @\$20,300
15	\$8,746,900 @\$22,486	\$7,959,679 @\$20,462
29	\$13,831,700 @\$28,113	\$12,586,847 @\$25,583

B : 1房 268'		
樓層	訂價	折實價9%
6	\$5,380,800 @\$20,078	\$4,896,528 @\$18,271
7	\$5,523,600 @\$20,610	\$5,026,476 @\$18,756
8	\$5,580,800 @\$20,824	\$5,078,528 @\$18,950
12	\$5,838,200 @\$21,784	\$5,312,762 @\$19,824
15	\$5,886,000 @\$21,963	\$5,356,260 @\$19,986

C : 開放式/3房 215'/474'		
樓層	訂價	折實價9%
6	\$4,498,200 @\$20,922	\$4,093,362 @\$19,039
8	\$4,589,600 @\$21,347	\$4,176,536 @\$19,426
9	\$4,682,700 @\$21,780	\$4,261,257 @\$19,820
10	\$4,720,200 @\$21,954	\$4,295,382 @\$19,979
11	\$4,758,000 @\$22,130	\$4,329,780 @\$20,139
29	\$13,119,200 @\$27,678	\$11,938,472 @\$25,187

D : 1房 286'		
樓層	訂價	折實價9%
6	\$5,473,600 @\$19,138	\$4,980,976 @\$17,416
7	\$5,676,600 @\$19,848	\$5,165,706 @\$18,062
8	\$5,737,700 @\$20,062	\$5,221,307 @\$18,256
9	\$5,861,600 @\$20,495	\$5,334,056 @\$18,651
10	\$5,911,500 @\$20,670	\$5,379,465 @\$18,809
11	\$5,961,700 @\$20,845	\$5,425,147 @\$18,969

E : 開放式 213'		
樓層	訂價	折實價9%
6	\$4,260,400 @\$20,002	\$3,876,964 @\$18,202
8	\$4,477,300 @\$21,020	\$4,074,343 @\$19,128
9	\$4,523,200 @\$21,236	\$4,116,112 @\$19,324
10	\$4,560,300 @\$21,410	\$4,149,873 @\$19,483
11	\$4,597,700 @\$21,585	\$4,183,907 @\$19,643
12	\$4,635,400 @\$21,762	\$4,218,214 @\$19,804
15	\$4,673,500 @\$21,941	\$4,252,885 @\$19,967
17	\$4,769,700 @\$22,393	\$4,340,427 @\$20,378
18	\$4,818,600 @\$22,623	\$4,384,926 @\$20,587
19	\$4,867,900 @\$22,854	\$4,429,789 @\$20,797
20	\$4,917,800 @\$23,088	\$4,475,198 @\$21,010
21	\$4,968,100 @\$23,324	\$4,520,971 @\$21,225
22	\$5,018,900 @\$23,563	\$4,567,199 @\$21,442
23	\$5,070,300 @\$23,804	\$4,613,973 @\$21,662
25	\$5,122,200 @\$24,048	\$4,661,202 @\$21,884

G : 1房 275'/277'		
樓層	訂價	折實價9%
6	\$5,499,700 @\$19,855	\$5,004,727 @\$18,068
7	\$5,518,200 @\$20,066	\$5,021,562 @\$18,260
8	\$5,576,900 @\$20,280	\$5,074,979 @\$18,454
9	\$5,756,000 @\$20,931	\$5,237,960 @\$19,047
10	\$5,833,800 @\$21,214	\$5,308,758 @\$19,305
11	\$5,882,100 @\$21,389	\$5,352,711 @\$19,464

F : 1房 278'		
樓層	訂價	折實價9%
7	\$5,578,400 @\$20,066	\$5,076,344 @\$18,260
8	\$5,637,700 @\$20,279	\$5,130,307 @\$18,454
9	\$5,697,700 @\$20,495	\$5,184,907 @\$18,651
10	\$5,836,900 @\$20,996	\$5,311,579 @\$19,106
11	\$5,885,800 @\$21,172	\$5,356,078 @\$19,266
12	\$5,935,000 @\$21,349	\$5,400,850 @\$19,428

紅色為最高售價、最高平均呎價；藍色為最低售價、最低平均呎價
 以上的物業資料只供參考，一切以發展商最新公布為準，如有任何資料錯漏本網頁不會承擔任何責任。