

Tower 1A

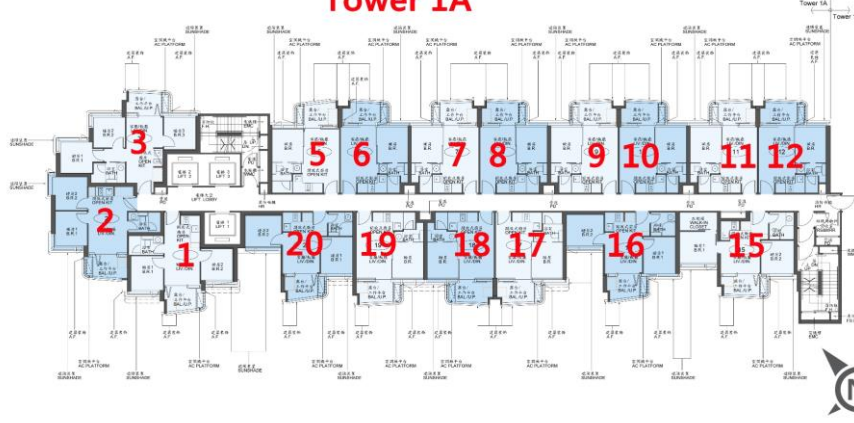

T1A 1 : 2房 344'		
樓層	訂價	折實價10%
3	\$5,816,000 @\$16,907	\$5,234,400 @\$15,216
5	\$5,834,000 @\$16,959	\$5,250,600 @\$15,263
6	\$5,853,000 @\$17,015	\$5,267,700 @\$15,313
7	\$5,872,000 @\$17,070	\$5,284,800 @\$15,363
8	\$5,890,000 @\$17,122	\$5,301,000 @\$15,410
9	\$5,909,000 @\$17,177	\$5,318,100 @\$15,460
10	\$5,965,000 @\$17,340	\$5,368,500 @\$15,606
11	\$6,002,000 @\$17,448	\$5,401,800 @\$15,703
12	\$6,021,000 @\$17,503	\$5,418,900 @\$15,753
15	\$6,039,000 @\$17,555	\$5,435,100 @\$15,800
16	\$6,058,000 @\$17,610	\$5,452,200 @\$15,849
17	\$6,076,000 @\$17,663	\$5,468,400 @\$15,897
18	\$6,114,000 @\$17,773	\$5,502,600 @\$15,996
19	\$6,151,000 @\$17,881	\$5,535,900 @\$16,093
20	\$6,188,000 @\$17,988	\$5,569,200 @\$16,190
21	\$6,225,000 @\$18,096	\$5,602,500 @\$16,286
22	\$6,262,000 @\$18,203	\$5,635,800 @\$16,383
23	\$6,300,000 @\$18,314	\$5,670,000 @\$16,483
25	\$6,337,000 @\$18,422	\$5,703,300 @\$16,579
26	\$6,374,000 @\$18,529	\$5,736,600 @\$16,676
27	\$6,411,000 @\$18,637	\$5,769,900 @\$16,773
28	\$6,448,000 @\$18,744	\$5,803,200 @\$16,870
T1A 3 : 3房 425'		
樓層	訂價	折實價10%
6	\$7,007,000 @\$16,487	\$6,306,300 @\$14,838
7	\$7,030,000 @\$16,541	\$6,327,000 @\$14,887
8	\$7,052,000 @\$16,593	\$6,346,800 @\$14,934
19	\$7,249,000 @\$17,056	\$6,524,100 @\$15,351
20	\$7,270,000 @\$17,106	\$6,543,000 @\$15,395

T1A 10 : 1房 264'		
樓層	訂價	折實價10%
3	\$4,403,000 @\$16,678	\$3,962,700 @\$15,010
5	\$4,431,000 @\$16,784	\$3,987,900 @\$15,106
6	\$4,446,000 @\$16,841	\$4,001,400 @\$15,157
7	\$4,460,000 @\$16,894	\$4,014,000 @\$15,205
8	\$4,474,000 @\$16,947	\$4,026,600 @\$15,252
9	\$4,488,000 @\$17,000	\$4,039,200 @\$15,300
10	\$4,531,000 @\$17,163	\$4,077,900 @\$15,447
11	\$4,559,000 @\$17,269	\$4,103,100 @\$15,542
12	\$4,574,000 @\$17,326	\$4,116,600 @\$15,593
15	\$4,588,000 @\$17,379	\$4,129,200 @\$15,641
16	\$4,602,000 @\$17,432	\$4,141,800 @\$15,689
17	\$4,616,000 @\$17,485	\$4,154,400 @\$15,736
18	\$4,631,000 @\$17,542	\$4,167,900 @\$15,788
19	\$4,645,000 @\$17,595	\$4,180,500 @\$15,835
20	\$4,659,000 @\$17,648	\$4,193,100 @\$15,883
21	\$4,673,000 @\$17,701	\$4,205,700 @\$15,931
22	\$4,688,000 @\$17,758	\$4,219,200 @\$15,982
23	\$4,702,000 @\$17,811	\$4,231,800 @\$16,030
25	\$4,716,000 @\$17,864	\$4,244,400 @\$16,077
26	\$4,730,000 @\$17,917	\$4,257,000 @\$16,125
27	\$4,744,000 @\$17,970	\$4,269,600 @\$16,173
28	\$4,759,000 @\$18,027	\$4,283,100 @\$16,224

T1A 17 : 1房 269'		
樓層	訂價	折實價10%
3	\$4,691,000 @\$17,439	\$4,221,900 @\$15,695
5	\$4,705,000 @\$17,491	\$4,234,500 @\$15,742
6	\$4,719,000 @\$17,543	\$4,247,100 @\$15,788
7	\$4,733,000 @\$17,595	\$4,259,700 @\$15,835
8	\$4,748,000 @\$17,651	\$4,273,200 @\$15,886
9	\$4,762,000 @\$17,703	\$4,285,800 @\$15,932
10	\$4,805,000 @\$17,862	\$4,324,500 @\$16,076
11	\$4,833,000 @\$17,967	\$4,349,700 @\$16,170
12	\$4,847,000 @\$18,019	\$4,362,300 @\$16,217
15	\$4,862,000 @\$18,074	\$4,375,800 @\$16,267
16	\$4,876,000 @\$18,126	\$4,388,400 @\$16,314
17	\$4,890,000 @\$18,178	\$4,401,000 @\$16,361
18	\$4,918,000 @\$18,283	\$4,426,200 @\$16,454
19	\$4,947,000 @\$18,390	\$4,452,300 @\$16,551
20	\$4,975,000 @\$18,494	\$4,477,500 @\$16,645
21	\$5,004,000 @\$18,602	\$4,503,600 @\$16,742
22	\$5,032,000 @\$18,706	\$4,528,800 @\$16,836
23	\$5,061,000 @\$18,814	\$4,554,900 @\$16,933
25	\$5,089,000 @\$18,918	\$4,580,100 @\$17,026
26	\$5,118,000 @\$19,026	\$4,606,200 @\$17,123
27	\$5,146,000 @\$19,130	\$4,631,400 @\$17,217
28	\$5,175,000 @\$19,238	\$4,657,500 @\$17,314

T1A 5 : 1房 268'		
樓層	訂價	折實價10%
3	\$4,492,000 @\$16,761	\$4,042,800 @\$15,085
5	\$4,520,000 @\$16,866	\$4,068,000 @\$15,179
6	\$4,534,000 @\$16,918	\$4,080,600 @\$15,226
7	\$4,549,000 @\$16,974	\$4,094,100 @\$15,276
8	\$4,563,000 @\$17,026	\$4,106,700 @\$15,324
9	\$4,577,000 @\$17,078	\$4,119,300 @\$15,371
10	\$4,591,000 @\$17,131	\$4,131,900 @\$15,418
11	\$4,605,000 @\$17,183	\$4,144,500 @\$15,465
12	\$4,620,000 @\$17,239	\$4,158,000 @\$15,515
15	\$4,634,000 @\$17,291	\$4,170,600 @\$15,562
16	\$4,648,000 @\$17,343	\$4,183,200 @\$15,609
17	\$4,662,000 @\$17,396	\$4,195,800 @\$15,656
18	\$4,677,000 @\$17,451	\$4,209,300 @\$15,706
19	\$4,691,000 @\$17,504	\$4,221,900 @\$15,753
20	\$4,705,000 @\$17,556	\$4,234,500 @\$15,800
21	\$4,719,000 @\$17,608	\$4,247,100 @\$15,847
22	\$4,733,000 @\$17,660	\$4,259,700 @\$15,894
23	\$4,748,000 @\$17,716	\$4,273,200 @\$15,945
25	\$4,762,000 @\$17,769	\$4,285,800 @\$15,992
26	\$4,776,000 @\$17,821	\$4,298,400 @\$16,039
27	\$4,790,000 @\$17,873	\$4,311,000 @\$16,086
28	\$4,805,000 @\$17,929	\$4,324,500 @\$16,136

紅色為最高售價、最高平均呎價；藍色為最低售價、最低平均呎價

以上的物業資料只供參考，一切以發展商最新公布為準，如有任何資料錯漏本網頁不會承擔任何責任。

Tower 1B



T1B 12 : 2房 339'		
樓層	訂價	折實價10%
3	\$5,736,000 @\$16,920	\$5,162,400 @\$15,228
5	\$5,763,000 @\$16,971	\$5,177,700 @\$15,273
6	\$5,771,000 @\$17,024	\$5,193,900 @\$15,321
7	\$5,789,000 @\$17,077	\$5,210,100 @\$15,369
8	\$5,806,000 @\$17,127	\$5,225,400 @\$15,414
9	\$5,824,000 @\$17,180	\$5,241,600 @\$15,462
10	\$5,841,000 @\$17,230	\$5,256,900 @\$15,507
11	\$5,859,000 @\$17,283	\$5,273,100 @\$15,555
12	\$5,876,000 @\$17,333	\$5,288,400 @\$15,600
15	\$5,894,000 @\$17,386	\$5,304,600 @\$15,648
16	\$5,911,000 @\$17,437	\$5,319,900 @\$15,693
17	\$5,929,000 @\$17,490	\$5,336,100 @\$15,741
18	\$5,946,000 @\$17,540	\$5,351,400 @\$15,786
19	\$5,964,000 @\$17,593	\$5,367,600 @\$15,834
20	\$5,981,000 @\$17,643	\$5,382,900 @\$15,879
21	\$5,999,000 @\$17,696	\$5,399,100 @\$15,927
22	\$6,016,000 @\$17,746	\$5,414,400 @\$15,972
23	\$6,034,000 @\$17,799	\$5,430,600 @\$16,019
25	\$6,051,000 @\$17,850	\$5,445,900 @\$16,065
26	\$6,069,000 @\$17,903	\$5,462,100 @\$16,112
27	\$6,086,000 @\$17,953	\$5,477,400 @\$16,158
28	\$6,104,000 @\$18,006	\$5,493,600 @\$16,205

T1B 16 : 開放式 199'		
樓層	訂價	折實價10%
3	\$3,520,000 @\$17,688	\$3,168,000 @\$15,920
5	\$3,539,000 @\$17,784	\$3,185,100 @\$16,006
6	\$3,550,000 @\$17,839	\$3,195,000 @\$16,055
7	\$3,561,000 @\$17,894	\$3,204,900 @\$16,105
19	\$3,671,000 @\$18,447	\$3,303,900 @\$16,603
20	\$3,682,000 @\$18,503	\$3,313,800 @\$16,652
T1B 9 : 3房連套房 457'		
樓層	訂價	折實價10%
6	\$7,757,000 @\$16,974	\$6,981,300 @\$15,276
7	\$7,782,000 @\$17,028	\$7,003,800 @\$15,326
8	\$7,806,000 @\$17,081	\$7,025,400 @\$15,373
19	\$8,070,000 @\$17,659	\$7,263,000 @\$15,893
20	\$8,119,000 @\$17,766	\$7,307,100 @\$15,989

T1B 2 : 2房 346'		
樓層	訂價	折實價10%
3	\$6,006,000 @\$17,358	\$5,405,400 @\$15,623
5	\$6,044,000 @\$17,468	\$5,439,600 @\$15,721
6	\$6,062,000 @\$17,520	\$5,455,800 @\$15,768
7	\$6,081,000 @\$17,575	\$5,472,900 @\$15,818
8	\$6,099,000 @\$17,627	\$5,489,100 @\$15,864
9	\$6,118,000 @\$17,682	\$5,506,200 @\$15,914
10	\$6,137,000 @\$17,737	\$5,523,300 @\$15,963
11	\$6,155,000 @\$17,789	\$5,539,500 @\$16,010
12	\$6,174,000 @\$17,844	\$5,556,600 @\$16,060
15	\$6,192,000 @\$17,896	\$5,572,800 @\$16,106
16	\$6,211,000 @\$17,951	\$5,589,900 @\$16,156
17	\$6,230,000 @\$18,006	\$5,607,000 @\$16,205
18	\$6,267,000 @\$18,113	\$5,640,300 @\$16,301
19	\$6,304,000 @\$18,220	\$5,673,600 @\$16,398
20	\$6,341,000 @\$18,327	\$5,706,900 @\$16,494
21	\$6,378,000 @\$18,434	\$5,740,200 @\$16,590
22	\$6,416,000 @\$18,543	\$5,774,400 @\$16,689
23	\$6,453,000 @\$18,650	\$5,807,700 @\$16,785
25	\$6,490,000 @\$18,757	\$5,841,000 @\$16,882
26	\$6,527,000 @\$18,864	\$5,874,300 @\$16,978
27	\$6,564,000 @\$18,971	\$5,907,600 @\$17,074
28	\$6,602,000 @\$19,081	\$5,941,800 @\$17,173

紅色為最高售價、最高平均呎價；藍色為最低售價、