

1A座C室：2房 378'

樓層	訂價	折實價23%
5	\$6,374,000 @\$16,862	\$4,907,980 @\$12,984
6	\$6,452,000 @\$17,069	\$4,968,040 @\$13,143
7	\$6,517,000 @\$17,241	\$5,018,090 @\$13,275
8	\$6,582,000 @\$17,413	\$5,068,140 @\$13,408
9	\$6,648,000 @\$17,587	\$5,118,960 @\$13,542
10	\$6,714,000 @\$17,762	\$5,169,780 @\$13,677
11	\$6,748,000 @\$17,852	\$5,195,960 @\$13,746
12	\$6,781,000 @\$17,939	\$5,221,370 @\$13,813
15	\$6,815,000 @\$18,029	\$5,247,550 @\$13,882
16	\$6,849,000 @\$18,119	\$5,273,730 @\$13,952
17	\$6,884,000 @\$18,212	\$5,300,680 @\$14,023
18	\$6,918,000 @\$18,302	\$5,326,860 @\$14,092
19	\$6,953,000 @\$18,394	\$5,353,810 @\$14,164
20	\$6,987,000 @\$18,484	\$5,379,990 @\$14,233
21	\$7,022,000 @\$18,577	\$5,406,940 @\$14,304
22	\$7,058,000 @\$18,672	\$5,434,660 @\$14,377
23	\$7,092,000 @\$18,762	\$5,460,840 @\$14,447
25	\$7,128,000 @\$18,857	\$5,488,560 @\$14,520
26	\$7,164,000 @\$18,952	\$5,516,280 @\$14,593

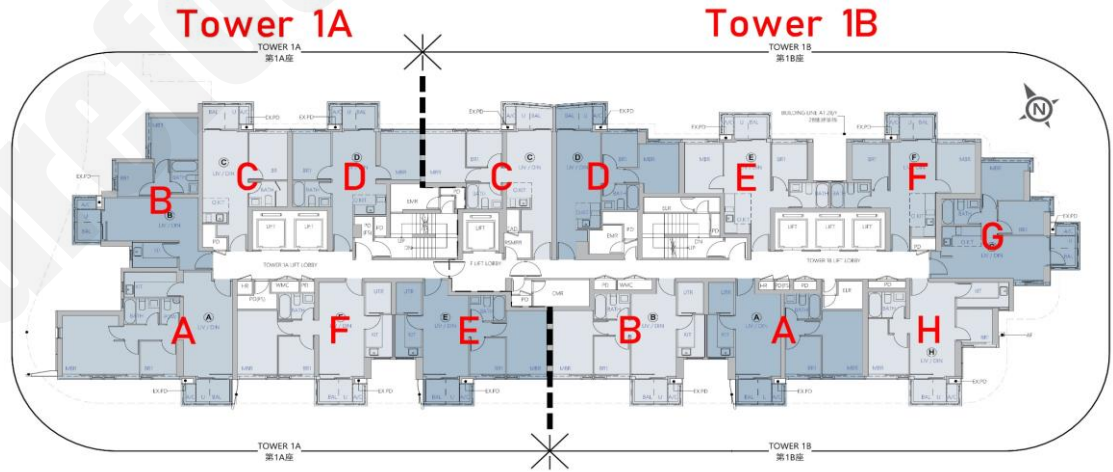

1A座D室：2房 471'

樓層	訂價	折實價23%
5	\$8,861,000 @\$18,813	\$6,822,970 @\$14,486
6	\$8,906,000 @\$18,909	\$6,857,620 @\$14,560
7	\$8,950,000 @\$19,002	\$6,891,500 @\$14,632
8	\$8,995,000 @\$19,098	\$6,926,150 @\$14,705
9	\$9,040,000 @\$19,193	\$6,960,800 @\$14,779
10	\$9,085,000 @\$19,289	\$6,995,450 @\$14,852
11	\$9,131,000 @\$19,386	\$7,030,870 @\$14,928
12	\$9,176,000 @\$19,482	\$7,065,520 @\$15,001
15	\$9,222,000 @\$19,580	\$7,100,940 @\$15,076
16	\$9,268,000 @\$19,677	\$7,136,360 @\$15,152
17	\$9,314,000 @\$19,775	\$7,171,780 @\$15,227
18	\$9,361,000 @\$19,875	\$7,207,970 @\$15,304
19	\$9,408,000 @\$19,975	\$7,244,160 @\$15,380
20	\$9,455,000 @\$20,074	\$7,280,350 @\$15,457
21	\$9,502,000 @\$20,174	\$7,316,540 @\$15,534
22	\$9,550,000 @\$20,276	\$7,353,500 @\$15,613
23	\$9,597,000 @\$20,376	\$7,389,690 @\$15,689
25	\$9,645,000 @\$20,478	\$7,426,650 @\$15,768
26	\$9,693,000 @\$20,580	\$7,463,610 @\$15,846

1A座E室：2房 549'

樓層	訂價	折實價23%
6	\$9,929,000 @\$18,086	\$7,645,330 @\$13,926
7	\$10,029,000 @\$18,268	\$7,722,330 @\$14,066
8	\$10,129,000 @\$18,450	\$7,799,330 @\$14,206
9	\$10,230,000 @\$18,634	\$7,877,100 @\$14,348
10	\$10,332,000 @\$18,820	\$7,955,640 @\$14,491
11	\$10,642,000 @\$19,384	\$8,194,340 @\$14,926
12	\$10,695,000 @\$19,481	\$8,235,150 @\$15,000
15	\$10,749,000 @\$19,579	\$8,276,730 @\$15,076
16	\$10,803,000 @\$19,678	\$8,318,310 @\$15,152
17	\$10,856,000 @\$19,774	\$8,359,120 @\$15,226
18	\$10,911,000 @\$19,874	\$8,401,470 @\$15,303
19	\$10,965,000 @\$19,973	\$8,443,050 @\$15,379
20	\$11,020,000 @\$20,073	\$8,485,400 @\$15,456
21	\$11,075,000 @\$20,173	\$8,527,750 @\$15,533
22	\$11,131,000 @\$20,275	\$8,570,870 @\$15,612
23	\$11,186,000 @\$20,375	\$8,613,220 @\$15,689
25	\$11,242,000 @\$20,477	\$8,656,340 @\$15,767
26	\$11,298,000 @\$20,579	\$8,699,460 @\$15,846

1A座F室：2房 561'

樓層	訂價	折實價23%
6	\$10,146,000 @\$18,086	\$7,812,420 @\$13,926
7	\$10,248,000 @\$18,267	\$7,890,960 @\$14,066
8	\$10,350,000 @\$18,449	\$7,969,500 @\$14,206
9	\$10,454,000 @\$18,635	\$8,049,580 @\$14,349
10	\$10,558,000 @\$18,820	\$8,129,660 @\$14,491
11	\$10,875,000 @\$19,385	\$8,373,750 @\$14,926
12	\$10,929,000 @\$19,481	\$8,415,330 @\$15,001
15	\$10,984,000 @\$19,579	\$8,457,680 @\$15,076
16	\$11,039,000 @\$19,677	\$8,500,030 @\$15,152
17	\$11,094,000 @\$19,775	\$8,542,380 @\$15,227
18	\$11,150,000 @\$19,875	\$8,585,500 @\$15,304
19	\$11,205,000 @\$19,973	\$8,627,850 @\$15,379
20	\$11,261,000 @\$20,073	\$8,670,970 @\$15,456
21	\$11,317,000 @\$20,173	\$8,714,090 @\$15,533
22	\$11,374,000 @\$20,275	\$8,757,980 @\$15,611
23	\$11,431,000 @\$20,376	\$8,801,870 @\$15,690
25	\$11,488,000 @\$20,478	\$8,845,760 @\$15,768
26	\$11,545,000 @\$20,579	\$8,889,650 @\$15,846

紅色為最高售價、最高平均呎價；藍色為最低售價、最低平均呎價

1B座C室：2房 465'		
樓層	訂價	折實價23%
5	\$8,922,000 @\$19,187	\$6,869,940 @\$14,774
6	\$8,966,000 @\$19,282	\$6,903,820 @\$14,847
7	\$9,011,000 @\$19,378	\$6,938,470 @\$14,921
8	\$9,056,000 @\$19,475	\$6,973,120 @\$14,996
9	\$9,101,000 @\$19,572	\$7,007,770 @\$15,070
10	\$9,147,000 @\$19,671	\$7,043,190 @\$15,147
11	\$9,192,000 @\$19,768	\$7,077,840 @\$15,221
12	\$9,238,000 @\$19,867	\$7,113,260 @\$15,297
15	\$9,285,000 @\$19,968	\$7,149,450 @\$15,375
16	\$9,331,000 @\$20,067	\$7,184,870 @\$15,451
17	\$9,378,000 @\$20,168	\$7,221,060 @\$15,529
18	\$9,425,000 @\$20,269	\$7,257,250 @\$15,607
19	\$9,472,000 @\$20,370	\$7,293,440 @\$15,685
20	\$9,519,000 @\$20,471	\$7,329,630 @\$15,763
21	\$9,567,000 @\$20,574	\$7,366,590 @\$15,842
22	\$9,615,000 @\$20,677	\$7,403,550 @\$15,922
23	\$9,663,000 @\$20,781	\$7,440,510 @\$16,001
25	\$9,711,000 @\$20,884	\$7,477,470 @\$16,081
26	\$9,760,000 @\$20,989	\$7,515,200 @\$16,162

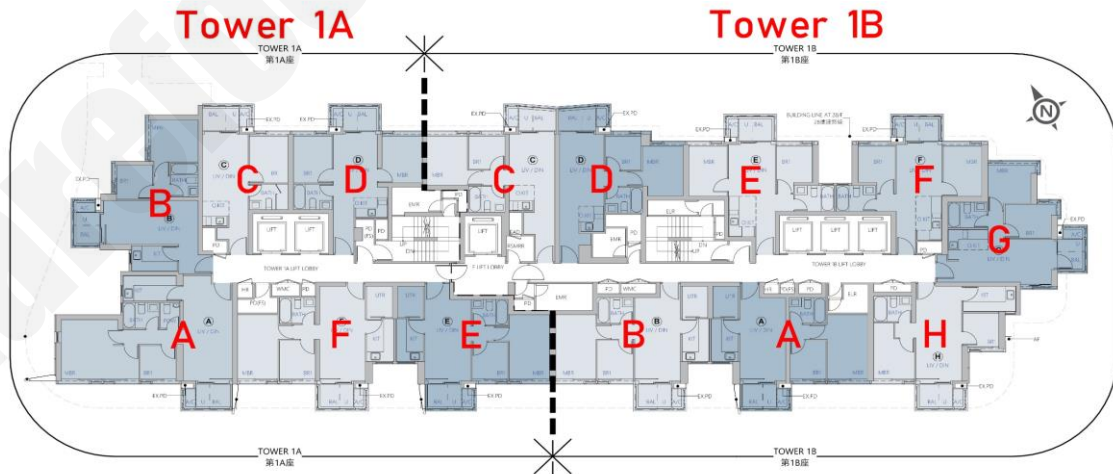

1B座C室：2房 465'		
樓層	訂價	折實價23%
6	\$9,948,000 @\$18,087	\$7,659,960 @\$13,927
7	\$10,047,000 @\$18,267	\$7,736,190 @\$14,066
8	\$10,148,000 @\$18,451	\$7,813,960 @\$14,207
9	\$10,249,000 @\$18,635	\$7,891,730 @\$14,349
10	\$10,351,000 @\$18,820	\$7,970,270 @\$14,491
11	\$10,662,000 @\$19,385	\$8,209,740 @\$14,927
12	\$10,715,000 @\$19,482	\$8,250,550 @\$15,001
15	\$10,768,000 @\$19,578	\$8,291,360 @\$15,075
16	\$10,823,000 @\$19,678	\$8,333,710 @\$15,152
17	\$10,876,000 @\$19,775	\$8,374,520 @\$15,226
18	\$10,931,000 @\$19,875	\$8,416,870 @\$15,303
19	\$10,985,000 @\$19,973	\$8,458,450 @\$15,379
20	\$11,040,000 @\$20,073	\$8,500,800 @\$15,456
21	\$11,095,000 @\$20,173	\$8,543,150 @\$15,533
22	\$11,151,000 @\$20,275	\$8,586,270 @\$15,611
23	\$11,207,000 @\$20,376	\$8,629,390 @\$15,690
25	\$11,263,000 @\$20,478	\$8,672,510 @\$15,768
26	\$11,319,000 @\$20,580	\$8,715,630 @\$15,847

紅色為最高售價、最高平均呎價；藍色為最低售價、最低平均呎價

新盤價單表

泰峯

價單1號

以最高23%折扣計算

制作日期: 2024-03-08



2A座A室：2房 514'		
樓層	訂價	折實價23%
5	\$8,664,000 @\$16,856	\$6,671,280 @\$12,979
6	\$8,744,000 @\$17,012	\$6,732,880 @\$13,099
7	\$8,832,000 @\$17,183	\$6,800,640 @\$13,231
8	\$8,920,000 @\$17,354	\$6,868,400 @\$13,363
9	\$9,009,000 @\$17,527	\$6,936,930 @\$13,496
10	\$9,099,000 @\$17,702	\$7,006,230 @\$13,631
11	\$9,372,000 @\$18,233	\$7,216,440 @\$14,040
12	\$9,419,000 @\$18,325	\$7,252,630 @\$14,110
15	\$9,466,000 @\$18,416	\$7,288,820 @\$14,181
16	\$9,513,000 @\$18,508	\$7,325,010 @\$14,251
17	\$9,561,000 @\$18,601	\$7,361,970 @\$14,323
18	\$9,609,000 @\$18,695	\$7,398,930 @\$14,395
19	\$9,657,000 @\$18,788	\$7,435,890 @\$14,467
20	\$9,705,000 @\$18,881	\$7,472,850 @\$14,539
21	\$9,754,000 @\$18,977	\$7,510,580 @\$14,612
22	\$9,803,000 @\$19,072	\$7,548,310 @\$14,685
23	\$9,851,000 @\$19,165	\$7,585,270 @\$14,757
25	\$9,901,000 @\$19,263	\$7,623,770 @\$14,832
26	\$9,950,000 @\$19,358	\$7,661,500 @\$14,906

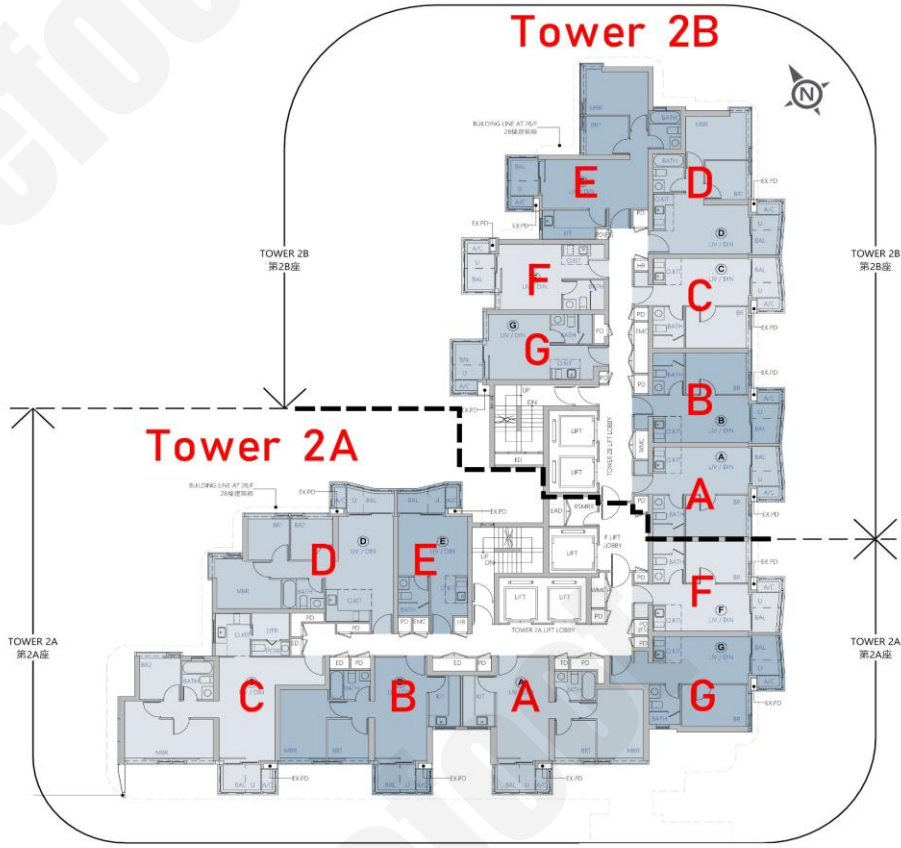

2A座E室：開放式 278'		
樓層	訂價	折實價23%
6	\$4,841,000 @\$17,414	\$3,727,570 @\$13,409
7	\$4,865,000 @\$17,500	\$3,746,050 @\$13,475
8	\$4,890,000 @\$17,590	\$3,765,300 @\$13,544
9	\$4,914,000 @\$17,676	\$3,783,780 @\$13,611
10	\$4,938,000 @\$17,763	\$3,802,260 @\$13,677
11	\$4,963,000 @\$17,853	\$3,821,510 @\$13,746
12	\$4,988,000 @\$17,942	\$3,840,760 @\$13,816
15	\$5,013,000 @\$18,032	\$3,860,010 @\$13,885
16	\$5,038,000 @\$18,122	\$3,879,260 @\$13,954
17	\$5,063,000 @\$18,212	\$3,898,510 @\$14,023
18	\$5,088,000 @\$18,302	\$3,917,760 @\$14,093
19	\$5,114,000 @\$18,396	\$3,937,780 @\$14,165
20	\$5,139,000 @\$18,486	\$3,957,030 @\$14,234
21	\$5,165,000 @\$18,579	\$3,977,050 @\$14,306
22	\$5,191,000 @\$18,673	\$3,997,070 @\$14,378
23	\$5,217,000 @\$18,766	\$4,017,090 @\$14,450
25	\$5,243,000 @\$18,860	\$4,037,110 @\$14,522
26	\$5,269,000 @\$18,953	\$4,057,130 @\$14,594

2B座A室：1房 336'		
樓層	訂價	折實價23%
5	\$6,106,000 @\$18,173	\$4,701,620 @\$13,993
6	\$6,198,000 @\$18,446	\$4,772,460 @\$14,204
7	\$6,229,000 @\$18,539	\$4,796,330 @\$14,275
8	\$6,261,000 @\$18,634	\$4,820,970 @\$14,348
9	\$6,292,000 @\$18,726	\$4,844,840 @\$14,419
10	\$6,418,000 @\$19,101	\$4,941,860 @\$14,708
11	\$6,450,000 @\$19,196	\$4,966,500 @\$14,781
12	\$6,482,000 @\$19,292	\$4,991,140 @\$14,855
15	\$6,514,000 @\$19,387	\$5,015,780 @\$14,928
16	\$6,547,000 @\$19,485	\$5,041,190 @\$15,004
17	\$6,580,000 @\$19,583	\$5,066,600 @\$15,079
18	\$6,612,000 @\$19,679	\$5,091,240 @\$15,153
19	\$6,645,000 @\$19,777	\$5,116,650 @\$15,228
20	\$6,679,000 @\$19,878	\$5,142,830 @\$15,306
21	\$6,712,000 @\$19,976	\$5,168,240 @\$15,382
22	\$6,745,000 @\$20,074	\$5,193,650 @\$15,457
23	\$6,779,000 @\$20,176	\$5,219,830 @\$15,535
25	\$6,813,000 @\$20,277	\$5,246,010 @\$15,613
26	\$6,847,000 @\$20,378	\$5,272,190 @\$15,691
29	\$7,053,000 @\$20,991	\$5,430,810 @\$16,163

紅色為最高售價、最高平均呎價；藍色為最低售價、最低平均呎價

以上的物業資料只供參考，一切以發展商最新公布為準，如有任何資料錯漏本網頁不會承擔任何責任。