

新盤價單表

朗賢峯 IIB期

價單1號

以最高18%折扣計算

制作日期: 2024-04-17



Tower 6 (6A) & Tower 6 (6B) | 2/F-3/F, 5/F-12/F & 15/F-18/F
第6座 (6A) 及第6座 (6B) | 2樓至3樓、5樓至12樓及15樓至18樓

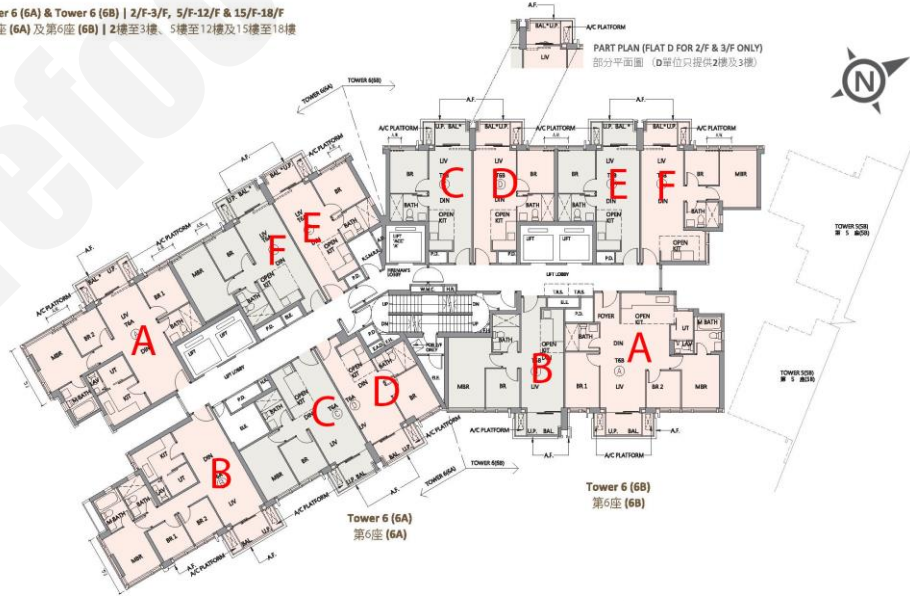

T6A A : 3房連套房 774'		
樓層	訂價	折實價18%
2	\$18,312,000 @\$23,659	\$15,015,840 @\$19,400
3	\$18,404,000 @\$23,778	\$15,091,280 @\$19,498
5	\$18,495,000 @\$23,895	\$15,165,900 @\$19,594
6	\$18,588,000 @\$24,016	\$15,242,160 @\$19,693
7	\$18,680,000 @\$24,134	\$15,317,600 @\$19,790
8	\$18,867,000 @\$24,376	\$15,470,940 @\$19,988
9	\$18,867,000 @\$24,376	\$15,470,940 @\$19,988
10	\$18,962,000 @\$24,499	\$15,548,840 @\$20,089
11	\$19,448,000 @\$25,127	\$15,947,360 @\$20,604
12	\$19,934,000 @\$25,755	\$16,345,880 @\$21,119
15	\$20,432,000 @\$26,398	\$16,754,240 @\$21,646
16	\$20,943,000 @\$27,058	\$17,173,260 @\$22,188
17	\$21,466,000 @\$27,734	\$17,602,120 @\$22,742
18	\$22,110,000 @\$28,566	\$18,130,200 @\$23,424
19	\$22,552,000 @\$29,137	\$18,492,640 @\$23,892
T6A F : 2房 528'		
樓層	訂價	折實價18%
2	\$12,202,000 @\$23,110	\$10,005,640 @\$18,950
3	\$12,263,000 @\$23,225	\$10,055,660 @\$19,045
5	\$12,324,000 @\$23,341	\$10,105,680 @\$19,140
6	\$12,387,000 @\$23,460	\$10,157,340 @\$19,237
7	\$12,448,000 @\$23,576	\$10,207,360 @\$19,332
8	\$12,572,000 @\$23,811	\$10,309,040 @\$19,525
9	\$12,572,000 @\$23,811	\$10,309,040 @\$19,525
10	\$12,635,000 @\$23,930	\$10,360,700 @\$19,623
11	\$12,901,000 @\$24,434	\$10,578,820 @\$20,036
12	\$13,223,000 @\$25,044	\$10,842,860 @\$20,536
15	\$13,555,000 @\$25,672	\$11,115,100 @\$21,051
16	\$13,893,000 @\$26,313	\$11,392,260 @\$21,576
17	\$14,240,000 @\$26,970	\$11,676,800 @\$22,115
18	\$14,667,000 @\$27,778	\$12,026,940 @\$22,778
T6A B : 2房 525'		
樓層	訂價	折實價18%
2	\$12,188,000 @\$23,215	\$9,994,160 @\$19,036
3	\$12,249,000 @\$23,331	\$10,044,180 @\$19,132
5	\$12,310,000 @\$23,448	\$10,094,200 @\$19,227
6	\$12,371,000 @\$23,564	\$10,144,220 @\$19,322
7	\$12,433,000 @\$23,682	\$10,195,060 @\$19,419
8	\$12,557,000 @\$23,918	\$10,296,740 @\$19,613
9	\$12,557,000 @\$23,918	\$10,296,740 @\$19,613
10	\$12,620,000 @\$24,038	\$10,348,400 @\$19,711
11	\$12,683,000 @\$24,158	\$10,400,060 @\$19,810
12	\$12,746,000 @\$24,278	\$10,451,720 @\$19,908
15	\$12,810,000 @\$24,400	\$10,504,200 @\$20,008
16	\$12,874,000 @\$24,522	\$10,556,680 @\$20,108
17	\$12,939,000 @\$24,646	\$10,609,980 @\$20,209
18	\$13,068,000 @\$24,891	\$10,715,760 @\$20,411
19	\$13,068,000 @\$24,891	\$10,715,760 @\$20,411

T6A E : 1房 388'		
樓層	訂價	折實價18%
2	\$8,532,000 @\$21,990	\$6,996,240 @\$18,032
3	\$8,549,000 @\$22,034	\$7,010,180 @\$18,067
5	\$8,566,000 @\$22,077	\$7,024,120 @\$18,103
6	\$8,583,000 @\$22,121	\$7,038,060 @\$18,139
7	\$8,600,000 @\$22,165	\$7,052,000 @\$18,175
8	\$8,660,000 @\$22,320	\$7,101,200 @\$18,302
9	\$8,660,000 @\$22,320	\$7,101,200 @\$18,302
10	\$8,677,000 @\$22,363	\$7,115,140 @\$18,338
11	\$8,695,000 @\$22,410	\$7,129,900 @\$18,376
12	\$8,712,000 @\$22,454	\$7,143,840 @\$18,412
15	\$8,729,000 @\$22,497	\$7,157,780 @\$18,448
16	\$8,748,000 @\$22,546	\$7,173,360 @\$18,488
17	\$8,765,000 @\$22,590	\$7,187,300 @\$18,524
18	\$8,826,000 @\$22,747	\$7,237,320 @\$18,653
19	\$8,826,000 @\$22,747	\$7,237,320 @\$18,653
20	\$8,844,000 @\$22,794	\$7,252,080 @\$18,691
21	\$8,861,000 @\$22,838	\$7,266,020 @\$18,727
22	\$8,952,000 @\$23,072	\$7,340,840 @\$18,919
23	\$9,085,000 @\$23,415	\$7,449,700 @\$19,200
25	\$9,239,000 @\$23,812	\$7,575,980 @\$19,526
26	\$9,428,000 @\$24,299	\$7,730,960 @\$19,925
27	\$9,613,000 @\$24,776	\$7,882,660 @\$20,316

T6B A : 3房連套房 757'		
樓層	訂價	折實價18%
2	\$18,627,000 @\$24,606	\$15,274,140 @\$20,177
3	\$18,720,000 @\$24,729	\$15,350,400 @\$20,278
5	\$18,813,000 @\$24,852	\$15,426,660 @\$20,379
6	\$18,907,000 @\$24,976	\$15,503,740 @\$20,481
7	\$19,002,000 @\$25,102	\$15,581,640 @\$20,583
8	\$19,193,000 @\$25,354	\$15,738,260 @\$20,790
9	\$19,193,000 @\$25,354	\$15,738,260 @\$20,790
10	\$19,288,000 @\$25,480	\$15,816,160 @\$20,893
11	\$19,384,000 @\$25,606	\$15,894,880 @\$20,997
12	\$19,482,000 @\$25,736	\$15,975,240 @\$21,103
15	\$19,579,000 @\$25,864	\$16,054,780 @\$21,208
16	\$19,677,000 @\$25,993	\$16,135,140 @\$21,315
17	\$19,776,000 @\$26,124	\$16,216,320 @\$21,422
18	\$19,973,000 @\$26,384	\$16,377,860 @\$21,635
T6B B : 2房 520'		
樓層	訂價	折實價18%
2	\$12,990,000 @\$24,981	\$10,651,800 @\$20,484
3	\$13,055,000 @\$25,106	\$10,705,100 @\$20,587
5	\$13,121,000 @\$25,233	\$10,759,220 @\$20,691
6	\$13,187,000 @\$25,360	\$10,813,340 @\$20,795
7	\$13,252,000 @\$25,485	\$10,866,640 @\$20,897
8	\$13,384,000 @\$25,738	\$10,974,880 @\$21,106
9	\$13,384,000 @\$25,738	\$10,974,880 @\$21,106
10	\$13,451,000 @\$25,867	\$11,029,820 @\$21,211
11	\$13,518,000 @\$25,996	\$11,084,760 @\$21,317
12	\$13,587,000 @\$26,129	\$11,141,340 @\$21,426
15	\$13,655,000 @\$26,260	\$11,197,100 @\$21,533

T6B C : 1房 388'		
樓層	訂價	折實價18%
2	\$8,399,000 @\$21,647	\$6,887,180 @\$17,750
3	\$8,422,000 @\$21,706	\$6,906,040 @\$17,799
5	\$8,439,000 @\$21,750	\$6,919,980 @\$17,835
6	\$8,456,000 @\$21,794	\$6,933,920 @\$17,871
7	\$8,473,000 @\$21,838	\$6,947,860 @\$17,907
8	\$8,532,000 @\$21,990	\$6,996,240 @\$18,032
9	\$8,532,000 @\$21,990	\$6,996,240 @\$18,032
10	\$8,549,000 @\$22,034	\$7,010,180 @\$18,067
11	\$8,566,000 @\$22,077	\$7,024,120 @\$18,103
12	\$8,583,000 @\$22,121	\$7,038,060 @\$18,139
15	\$8,601,000 @\$22,168	\$7,052,200 @\$18,177
16	\$8,618,000 @\$22,211	\$7,066,760 @\$18,213
17	\$8,635,000 @\$22,255	\$7,080,700 @\$18,249
18	\$8,695,000 @\$22,410	\$7,129,900 @\$18,376
19	\$8,695,000 @\$22,410	\$7,129,900 @\$18,376
20	\$8,713,000 @\$22,456	\$7,144,660 @\$18,414
21	\$8,730,000 @\$22,500	\$7,158,600 @\$18,450
22	\$8,748,000 @\$22,546	\$7,173,360 @\$18,488
23	\$8,839,000 @\$22,781	\$7,247,980 @\$18,680
25	\$8,972,000 @\$23,124	\$7,357,040 @\$18,961
26	\$9,107,000 @\$23,472	\$7,467,740 @\$19,247
27	\$9,241,000 @\$23,817	\$7,577,620 @\$19,530

以上的物業資料只供參考，一切以發展商最新公布為準，如有任何資料錯漏本網頁不會承擔任何責任。