

新盤價單表

譽林

價單1號

以最高10%折扣計算
制作日期: 2023-11-01



A: 3房連套房及工人套房 698'		
樓層	訂價	折實價10%
5	\$16,560,000 @\$23,725	\$14,904,000 @\$21,352
6	\$16,725,000 @\$23,961	\$15,052,500 @\$21,565
7	\$16,907,000 @\$24,222	\$15,216,300 @\$21,800
8	\$17,088,000 @\$24,481	\$15,379,200 @\$22,033
9	\$17,583,000 @\$25,191	\$15,824,700 @\$22,671
10	\$17,764,000 @\$25,450	\$15,987,600 @\$22,905

B: 3房連套房及工人套房 754'		
樓層	訂價	折實價10%
5	\$17,835,000 @\$23,654	\$16,051,500 @\$21,288
6	\$18,013,000 @\$23,890	\$16,211,700 @\$21,501
7	\$18,210,000 @\$24,151	\$16,389,000 @\$21,736
8	\$18,388,000 @\$24,387	\$16,549,200 @\$21,949
9	\$18,940,000 @\$25,119	\$17,046,000 @\$22,607
10	\$19,137,000 @\$25,381	\$17,223,300 @\$22,843

C: 2房 494'		
樓層	訂價	折實價10%
5	\$10,028,000 @\$20,300	\$9,025,200 @\$18,270
6	\$10,249,000 @\$20,747	\$9,224,100 @\$18,672
7	\$10,460,000 @\$21,174	\$9,414,000 @\$19,057
8	\$10,565,000 @\$21,387	\$9,508,500 @\$19,248
9	\$11,020,000 @\$22,308	\$9,918,000 @\$20,077
10	\$11,825,000 @\$23,937	\$10,642,500 @\$21,544

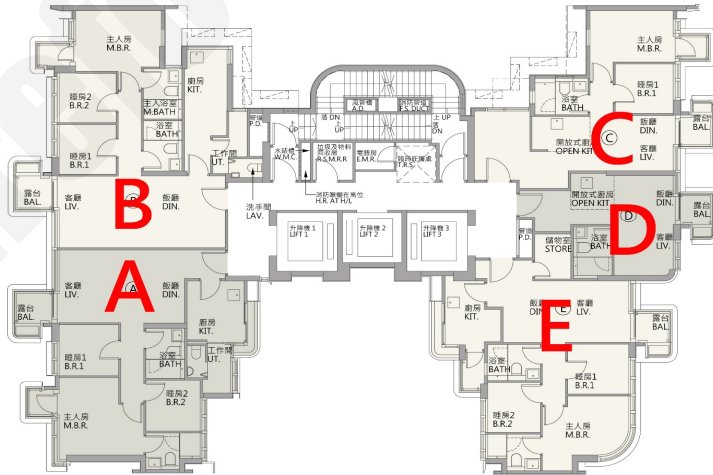

D: 開放式 260/306'		
樓層	訂價	折實價10%
5	\$6,368,000 @\$20,810	\$5,731,200 @\$18,729
6	\$6,502,000 @\$21,248	\$5,851,800 @\$19,124
7	\$6,642,000 @\$21,706	\$5,977,800 @\$19,535
8	\$5,983,000 @\$23,012	\$5,384,700 @\$20,710
9	\$6,047,000 @\$23,258	\$5,442,300 @\$20,932
10	\$6,292,000 @\$24,200	\$5,662,800 @\$21,780
11	\$6,449,000 @\$24,804	\$5,804,100 @\$22,323

E: 3房連套房及工人套房 625/641/671'		
樓層	訂價	折實價10%
8	\$15,328,000 @\$22,844	\$13,795,200 @\$20,559
9	\$14,416,000 @\$23,066	\$12,974,400 @\$20,759
10	\$15,148,000 @\$23,632	\$13,633,200 @\$21,269
11	\$15,602,000 @\$24,340	\$14,041,800 @\$21,906
12	\$15,753,000 @\$24,576	\$14,177,700 @\$22,118

紅色為最高售價、最高平均呎價；藍色為最低售價、最低平均呎價