

T3A A9: 1房 274/295'		
樓層	訂價	折實價13.5%
3	\$3,935,100 @\$14,362	\$3,344,835 @\$12,207
5	\$3,467,800 @\$11,755	\$2,947,630 @\$9,992
6	\$3,607,000 @\$12,227	\$3,065,950 @\$10,393
7	\$3,697,200 @\$12,533	\$3,142,620 @\$10,653
8	\$3,772,800 @\$12,789	\$3,206,880 @\$10,871
9	\$3,833,800 @\$12,996	\$3,258,730 @\$11,047
10	\$3,883,100 @\$13,163	\$3,300,635 @\$11,189
11	\$3,911,900 @\$13,261	\$3,325,115 @\$11,272
12	\$3,920,100 @\$13,288	\$3,332,085 @\$11,295
15	\$3,924,200 @\$13,302	\$3,335,570 @\$11,307
16	\$3,928,400 @\$13,317	\$3,339,140 @\$11,319
17	\$3,932,400 @\$13,330	\$3,342,540 @\$11,331
18	\$3,936,700 @\$13,345	\$3,346,195 @\$11,343
19	\$3,940,800 @\$13,359	\$3,349,680 @\$11,355
20	\$3,945,000 @\$13,373	\$3,353,250 @\$11,367
21	\$3,949,100 @\$13,387	\$3,356,735 @\$11,379
22	\$3,953,200 @\$13,401	\$3,360,220 @\$11,391
23	\$3,957,400 @\$13,415	\$3,363,790 @\$11,403
25	\$3,961,600 @\$13,429	\$3,367,360 @\$11,415
26	\$3,965,700 @\$13,443	\$3,370,845 @\$11,427
27	\$3,969,900 @\$13,457	\$3,374,415 @\$11,439
28	\$3,974,100 @\$13,472	\$3,377,985 @\$11,451
29	\$3,978,300 @\$13,486	\$3,381,555 @\$11,463
30	\$3,986,700 @\$13,514	\$3,388,695 @\$11,487
31	\$3,995,000 @\$13,542	\$3,395,750 @\$11,511
32	\$4,003,400 @\$13,571	\$3,402,890 @\$11,535
33	\$4,011,900 @\$13,600	\$3,410,115 @\$11,560
35	\$4,020,300 @\$13,628	\$3,417,255 @\$11,584

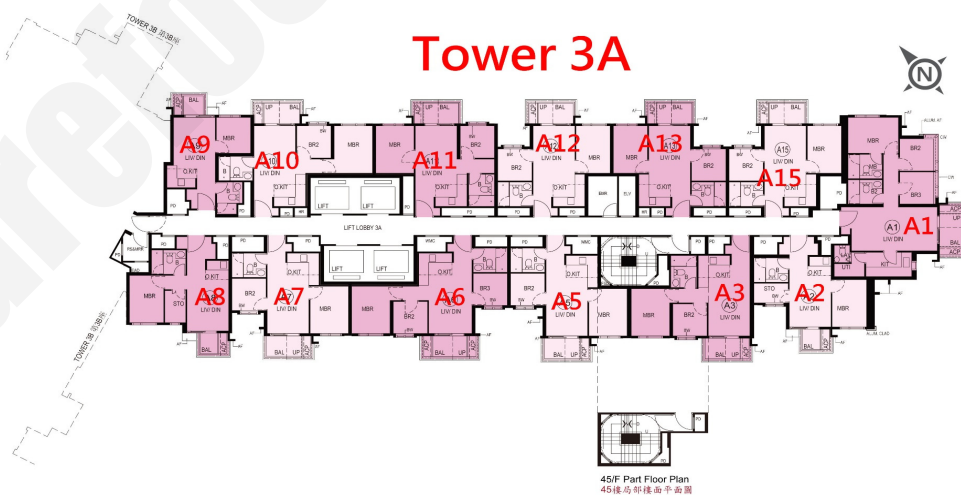

T3A A1: 3房連套房 651'		
樓層	訂價	折實價13.5%
5	\$7,711,200 @\$11,845	\$6,554,520 @\$10,068
6	\$7,826,800 @\$12,023	\$6,652,780 @\$10,219
7	\$7,924,100 @\$12,172	\$6,735,485 @\$10,346
8	\$7,959,900 @\$12,227	\$6,765,915 @\$10,393
9	\$7,997,000 @\$12,284	\$6,797,450 @\$10,442
10	\$8,047,000 @\$12,361	\$6,839,950 @\$10,507
11	\$8,063,900 @\$12,387	\$6,854,315 @\$10,529
12	\$8,080,900 @\$12,413	\$6,868,765 @\$10,551
15	\$8,089,400 @\$12,426	\$6,875,990 @\$10,562
16	\$8,097,900 @\$12,439	\$6,883,215 @\$10,573
17	\$8,106,400 @\$12,452	\$6,890,440 @\$10,584
18	\$8,115,000 @\$12,465	\$6,897,750 @\$10,596
19	\$8,123,500 @\$12,478	\$6,904,975 @\$10,607
20	\$8,094,400 @\$12,434	\$6,880,240 @\$10,569
21	\$8,102,900 @\$12,447	\$6,887,465 @\$10,580
22	\$8,111,500 @\$12,460	\$6,894,775 @\$10,591
23	\$8,120,200 @\$12,473	\$6,902,170 @\$10,602
25	\$8,128,600 @\$12,486	\$6,909,310 @\$10,613
26	\$8,137,300 @\$12,500	\$6,916,705 @\$10,625
27	\$8,145,800 @\$12,513	\$6,923,930 @\$10,636
28	\$8,154,400 @\$12,526	\$6,931,240 @\$10,647
29	\$8,163,100 @\$12,539	\$6,938,635 @\$10,658
30	\$8,180,300 @\$12,566	\$6,953,255 @\$10,681
31	\$8,197,500 @\$12,592	\$6,967,875 @\$10,703
32	\$8,214,800 @\$12,619	\$6,982,580 @\$10,726
33	\$8,232,200 @\$12,645	\$6,997,370 @\$10,749
35	\$8,249,500 @\$12,672	\$7,012,075 @\$10,771
36	\$8,267,000 @\$12,699	\$7,026,950 @\$10,794
37	\$8,284,300 @\$12,725	\$7,041,655 @\$10,817
38	\$8,301,800 @\$12,752	\$7,056,530 @\$10,840
39	\$8,319,400 @\$12,779	\$7,071,490 @\$10,863
40	\$8,336,900 @\$12,806	\$7,086,365 @\$10,885
41	\$8,363,300 @\$12,847	\$7,108,805 @\$10,920

T3A A10: 2房 437'		
樓層	訂價	折實價13.5%
5	\$5,055,300 @\$11,568	\$4,297,005 @\$9,833
6	\$5,178,900 @\$11,851	\$4,402,065 @\$10,073
7	\$5,245,500 @\$12,003	\$4,458,675 @\$10,203
8	\$5,304,300 @\$12,138	\$4,508,655 @\$10,317
9	\$5,362,800 @\$12,272	\$4,558,380 @\$10,431
10	\$5,431,600 @\$12,429	\$4,616,860 @\$10,565
11	\$5,472,000 @\$12,522	\$4,651,200 @\$10,643
12	\$5,483,500 @\$12,548	\$4,660,975 @\$10,666
15	\$5,489,400 @\$12,562	\$4,665,990 @\$10,677
16	\$5,495,200 @\$12,575	\$4,670,920 @\$10,689
17	\$5,501,000 @\$12,588	\$4,675,850 @\$10,700
18	\$5,506,800 @\$12,601	\$4,680,780 @\$10,711
19	\$5,512,500 @\$12,614	\$4,685,625 @\$10,722
20	\$5,518,300 @\$12,628	\$4,690,555 @\$10,734
21	\$5,524,300 @\$12,641	\$4,695,655 @\$10,745
22	\$5,530,100 @\$12,655	\$4,700,585 @\$10,756
23	\$5,535,900 @\$12,668	\$4,705,515 @\$10,768
25	\$5,541,800 @\$12,681	\$4,710,530 @\$10,779
26	\$5,547,600 @\$12,695	\$4,715,460 @\$10,791
27	\$5,553,500 @\$12,708	\$4,720,475 @\$10,802
28	\$5,559,300 @\$12,722	\$4,725,405 @\$10,813
29	\$5,565,200 @\$12,735	\$4,730,420 @\$10,825
30	\$5,576,900 @\$12,762	\$4,740,365 @\$10,848
31	\$5,588,700 @\$12,789	\$4,750,395 @\$10,870
32	\$5,600,500 @\$12,816	\$4,760,425 @\$10,893
33	\$5,612,300 @\$12,843	\$4,770,455 @\$10,916
35	\$5,624,100 @\$12,870	\$4,780,485 @\$10,939
36	\$5,636,000 @\$12,897	\$4,790,600 @\$10,962
37	\$5,647,800 @\$12,924	\$4,800,630 @\$10,985
38	\$5,659,700 @\$12,951	\$4,810,745 @\$11,009
39	\$5,671,700 @\$12,979	\$4,820,945 @\$11,032
40	\$5,683,500 @\$13,006	\$4,830,975 @\$11,055
41	\$5,701,600 @\$13,047	\$4,846,360 @\$11,090

T3A A15: 2房 396'		
樓層	訂價	折實價13.5%
42	\$5,865,400 @\$14,812	\$4,985,590 @\$12,590

紅色為最高售價、最高平均呎價；藍色為最低售價、最低平均呎價

**T3B B10: 3房 509'546'**

樓層	訂價	折實價13.5%
3	\$6,595,400 @\$12,958	\$5,606,090 @\$11,014
5	\$6,312,200 @\$11,561	\$5,365,370 @\$9,827
6	\$6,518,000 @\$11,938	\$5,540,300 @\$10,147
7	\$6,609,800 @\$12,106	\$5,618,330 @\$10,290
8	\$6,694,200 @\$12,260	\$5,690,070 @\$10,421
9	\$6,750,800 @\$12,364	\$5,738,180 @\$10,509
10	\$6,779,100 @\$12,416	\$5,762,235 @\$10,554
11	\$6,793,500 @\$12,442	\$5,774,475 @\$10,576
12	\$6,807,600 @\$12,468	\$5,786,460 @\$10,598
15	\$6,814,900 @\$12,482	\$5,792,665 @\$10,609
16	\$6,821,900 @\$12,494	\$5,798,615 @\$10,620
17	\$6,829,100 @\$12,508	\$5,804,735 @\$10,631
18	\$6,836,200 @\$12,521	\$5,810,770 @\$10,642
19	\$6,843,400 @\$12,534	\$5,816,890 @\$10,654
20	\$6,850,600 @\$12,547	\$5,823,010 @\$10,665
21	\$6,857,700 @\$12,560	\$5,829,045 @\$10,676
22	\$6,864,900 @\$12,573	\$5,835,165 @\$10,687
23	\$6,872,100 @\$12,586	\$5,841,285 @\$10,698
25	\$6,879,400 @\$12,600	\$5,847,490 @\$10,710
26	\$6,886,500 @\$12,613	\$5,853,525 @\$10,721
27	\$6,893,700 @\$12,626	\$5,859,645 @\$10,732
28	\$6,901,000 @\$12,639	\$5,865,850 @\$10,743
29	\$6,908,300 @\$12,653	\$5,872,055 @\$10,755
30	\$6,922,600 @\$12,679	\$5,884,210 @\$10,777
31	\$6,937,200 @\$12,705	\$5,896,620 @\$10,800
32	\$6,951,700 @\$12,732	\$5,909,945 @\$10,822
33	\$6,966,200 @\$12,759	\$5,921,270 @\$10,845
35	\$6,980,900 @\$12,786	\$5,933,765 @\$10,868
36	\$6,995,400 @\$12,812	\$5,946,090 @\$10,890
37	\$7,010,000 @\$12,839	\$5,958,500 @\$10,913
38	\$7,024,700 @\$12,866	\$5,970,995 @\$10,936
39	\$7,039,400 @\$12,893	\$5,983,490 @\$10,959
40	\$7,054,200 @\$12,920	\$5,996,070 @\$10,982
41	\$7,076,400 @\$12,960	\$6,014,940 @\$11,016
42	\$7,214,500 @\$13,213	\$6,132,325 @\$11,231
43	\$7,394,800 @\$13,544	\$6,285,580 @\$11,512
45	\$7,601,900 @\$13,923	\$6,461,615 @\$11,834

**T3B B9: 2房 398'**

樓層	訂價	折實價13.5%
42	\$5,719,300 @\$14,370	\$4,861,405 @\$12,215

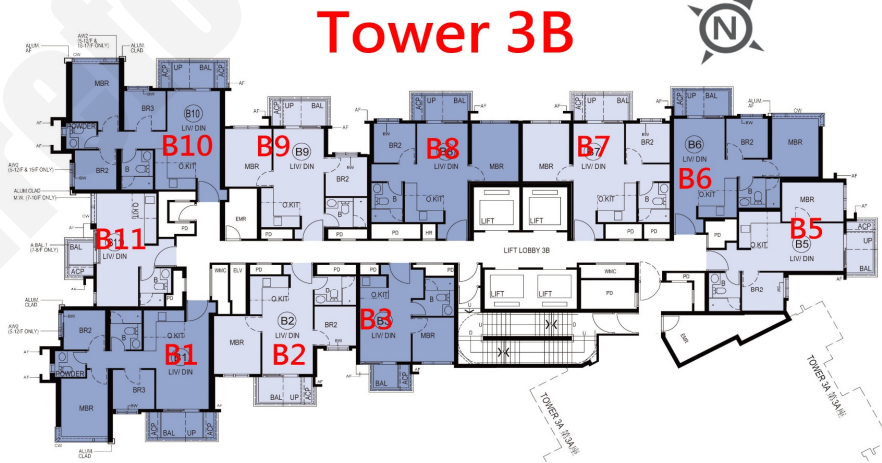

**Tower 3B**



**T3B B6: 2房 433'**

樓層	訂價	折實價13.5%
3	\$5,008,400 @\$11,567	\$4,257,140 @\$9,832
5	\$5,095,000 @\$11,767	\$4,330,750 @\$10,002
6	\$5,188,500 @\$11,983	\$4,410,225 @\$10,185
7	\$5,246,300 @\$12,116	\$4,459,355 @\$10,299
8	\$5,304,600 @\$12,251	\$4,508,910 @\$10,413
9	\$5,321,400 @\$12,290	\$4,523,190 @\$10,446
10	\$5,361,100 @\$12,381	\$4,556,935 @\$10,524
11	\$5,389,400 @\$12,447	\$4,580,990 @\$10,580
12	\$5,400,900 @\$12,473	\$4,590,765 @\$10,602
15	\$5,406,500 @\$12,486	\$4,595,525 @\$10,613
16	\$5,412,200 @\$12,499	\$4,600,370 @\$10,624
17	\$5,418,100 @\$12,513	\$4,605,385 @\$10,636
18	\$5,423,800 @\$12,526	\$4,610,230 @\$10,647
19	\$5,429,400 @\$12,539	\$4,614,990 @\$10,658
20	\$5,435,200 @\$12,552	\$4,619,920 @\$10,670
21	\$5,441,000 @\$12,566	\$4,624,850 @\$10,681
22	\$5,446,600 @\$12,579	\$4,629,610 @\$10,692
23	\$5,452,400 @\$12,592	\$4,634,540 @\$10,703
25	\$5,458,200 @\$12,606	\$4,639,470 @\$10,715
26	\$5,464,000 @\$12,619	\$4,644,400 @\$10,726
27	\$5,469,800 @\$12,632	\$4,649,330 @\$10,737
28	\$5,475,400 @\$12,645	\$4,654,090 @\$10,748
29	\$5,481,200 @\$12,659	\$4,659,020 @\$10,760
30	\$5,492,900 @\$12,686	\$4,668,965 @\$10,783
31	\$5,504,500 @\$12,712	\$4,678,825 @\$10,806
32	\$5,516,000 @\$12,739	\$4,688,600 @\$10,828
33	\$5,527,700 @\$12,766	\$4,698,545 @\$10,851
35	\$5,539,400 @\$12,793	\$4,708,490 @\$10,874
36	\$5,550,900 @\$12,820	\$4,718,265 @\$10,897
37	\$5,562,700 @\$12,847	\$4,728,295 @\$10,920
38	\$5,574,500 @\$12,874	\$4,738,325 @\$10,943
39	\$5,586,200 @\$12,901	\$4,748,270 @\$10,966
40	\$5,598,000 @\$12,928	\$4,758,300 @\$10,989
41	\$5,616,400 @\$12,969	\$4,773,345 @\$11,024

**T3B B7: 2房 441'**

樓層	訂價	折實價13.5%
3	\$5,187,700 @\$11,763	\$4,409,545 @\$9,999
5	\$5,234,100 @\$11,869	\$4,448,985 @\$10,088
6	\$5,269,200 @\$11,948	\$4,478,820 @\$10,156
7	\$5,292,700 @\$12,002	\$4,498,795 @\$10,201
8	\$5,316,400 @\$12,055	\$4,518,940 @\$10,247
9	\$5,350,300 @\$12,132	\$4,547,755 @\$10,312
10	\$5,372,900 @\$12,183	\$4,566,965 @\$10,356
11	\$5,390,000 @\$12,222	\$4,581,500 @\$10,389
12	\$5,401,400 @\$12,248	\$4,591,190 @\$10,411
15	\$5,407,200 @\$12,261	\$4,596,120 @\$10,422
16	\$5,412,900 @\$12,274	\$4,600,965 @\$10,433
17	\$5,418,500 @\$12,287	\$4,605,725 @\$10,444
18	\$5,424,300 @\$12,300	\$4,610,655 @\$10,455
19	\$5,430,100 @\$12,313	\$4,615,585 @\$10,466
20	\$5,435,800 @\$12,326	\$4,620,430 @\$10,477
21	\$5,441,600 @\$12,339	\$4,625,360 @\$10,488
22	\$5,447,300 @\$12,352	\$4,630,205 @\$10,499
23	\$5,453,100 @\$12,365	\$4,635,135 @\$10,511
25	\$5,458,800 @\$12,378	\$4,639,980 @\$10,521
26	\$5,464,600 @\$12,391	\$4,644,910 @\$10,533
27	\$5,470,400 @\$12,405	\$4,649,840 @\$10,544
28	\$5,476,100 @\$12,417	\$4,654,685 @\$10,555
29	\$5,481,900 @\$12,431	\$4,659,615 @\$10,566
30	\$5,493,500 @\$12,457	\$4,669,475 @\$10,588
31	\$5,505,200 @\$12,483	\$4,679,420 @\$10,611
32	\$5,516,700 @\$12,510	\$4,689,195 @\$10,633
33	\$5,528,400 @\$12,536	\$4,699,140 @\$10,656
35	\$5,540,100 @\$12,563	\$4,709,085 @\$10,678
36	\$5,551,700 @\$12,589	\$4,718,945 @\$10,701
37	\$5,563,400 @\$12,615	\$4,728,890 @\$10,723
38	\$5,575,200 @\$12,642	\$4,738,920 @\$10,746
39	\$5,586,900 @\$12,669	\$4,748,865 @\$10,768
40	\$5,598,700 @\$12,695	\$4,758,895 @\$10,791
41	\$5,616,400 @\$12,736	\$4,773,940 @\$10,825

**T3B B8: 2房 440'**

樓層	訂價	折實價13.5%
3	\$5,176,000 @\$11,764	\$4,399,600 @\$9,999
5	\$5,222,300 @\$11,869	\$4,438,955 @\$10,089
6	\$5,257,300 @\$11,948	\$4,468,705 @\$10,156
7	\$5,280,800 @\$12,002	\$4,488,680 @\$10,202
8	\$5,304,300 @\$12,055	\$4,508,655 @\$10,247
9	\$5,338,200 @\$12,132	\$4,537,470 @\$10,312
10	\$5,360,900 @\$12,184	\$4,556,965 @\$10,356
11	\$5,377,900 @\$12,223	\$4,571,215 @\$10,389
12	\$5,389,300 @\$12,248	\$4,580,905 @\$10,411
15	\$5,395,000 @\$12,261	\$4,585,750 @\$10,422
16	\$5,400,800 @\$12,275	\$4,590,680 @\$10,433
17	\$5,406,400 @\$12,287	\$4,595,440 @\$10,444
18	\$5,412,100 @\$12,300	\$4,600,285 @\$10,455
19	\$5,417,800 @\$12,313	\$4,605,130 @\$10,466
20	\$5,423,600 @\$12,326	\$4,610,060 @\$10,477
21	\$5,429,300 @\$12,339	\$4,614,905 @\$10,488
22	\$5,435,100 @\$12,353	\$4,619,835 @\$10,500
23	\$5,440,700 @\$12,365	\$4,624,595 @\$10,511
25	\$5,446,500 @\$12,378	\$4,629,525 @\$10,522
26	\$5,452,300 @\$12,392	\$4,634,455 @\$10,533
27	\$5,458,100 @\$12,405	\$4,639,385 @\$10,544
28	\$5,463,800 @\$12,418	\$4,644,230 @\$10,555
29	\$5,469,700 @\$12,431	\$4,649,245 @\$10,566
30	\$5,481,100 @\$12,457	\$4,658,935 @\$10,588
31	\$5,492,700 @\$12,483	\$4,668,795 @\$10,611
32	\$5,504,300 @\$12,510	\$4,678,655 @\$10,633
33	\$5,515,900 @\$12,536	\$4,688,515 @\$10,656
35	\$5,527,600 @\$12,563	\$4,698,460 @\$10,678
36	\$5,539,300 @\$12,589	\$4,708,405 @\$10,701
37	\$5,550,900 @\$12,616	\$4,718,265 @\$10,723
38	\$5,562,600 @\$12,642	\$4,728,210 @\$10,746
39	\$5,574,400 @\$12,669	\$4,738,240 @\$10,769
40	\$5,586,100 @\$12,696	\$4,748,185 @\$10,791
41	\$5,603,800 @\$12,736	\$4,763,230 @\$10,826

紅色為最高售價、最高平均呎價；藍色為最低售價、最低平均呎價

新盤價單表

YOHO West 1期

價單1號

以最高13.5%折扣計算

制作日期: 2023-11-20



T2A A8: 2房 416'/454'

樓層	訂價	折實價13.5%
3	\$5,667,100 @\$13,623	\$4,817,035 @\$11,579
5	\$5,371,700 @\$11,832	\$4,565,945 @\$10,057
6	\$5,545,600 @\$12,215	\$4,713,760 @\$10,383
7	\$5,638,400 @\$12,419	\$4,792,640 @\$10,556
8	\$5,662,400 @\$12,472	\$4,813,040 @\$10,601
9	\$5,680,300 @\$12,512	\$4,828,255 @\$10,635
10	\$5,692,400 @\$12,538	\$4,838,540 @\$10,658
11	\$5,704,300 @\$12,565	\$4,848,655 @\$10,680
12	\$5,716,500 @\$12,591	\$4,859,025 @\$10,703
15	\$5,722,500 @\$12,605	\$4,864,125 @\$10,714
16	\$5,728,500 @\$12,618	\$4,869,225 @\$10,725
17	\$5,734,600 @\$12,631	\$4,874,410 @\$10,737
18	\$5,740,600 @\$12,644	\$4,879,510 @\$10,748
19	\$5,746,600 @\$12,658	\$4,884,610 @\$10,759
20	\$5,752,800 @\$12,671	\$4,889,880 @\$10,771
21	\$5,758,900 @\$12,685	\$4,895,065 @\$10,782
22	\$5,764,900 @\$12,698	\$4,900,165 @\$10,793
23	\$5,771,000 @\$12,711	\$4,905,350 @\$10,805
25	\$5,777,000 @\$12,725	\$4,910,450 @\$10,816
26	\$5,783,200 @\$12,738	\$4,915,720 @\$10,828
27	\$5,789,300 @\$12,752	\$4,920,905 @\$10,839
28	\$5,795,400 @\$12,765	\$4,926,090 @\$10,850
29	\$5,801,400 @\$12,778	\$4,931,190 @\$10,862
30	\$5,813,700 @\$12,806	\$4,941,645 @\$10,885
31	\$5,826,000 @\$12,833	\$4,952,100 @\$10,908
32	\$5,838,300 @\$12,860	\$4,962,555 @\$10,931
33	\$5,850,600 @\$12,887	\$4,973,010 @\$10,954
35	\$5,862,800 @\$12,914	\$4,983,380 @\$10,977
36	\$5,875,300 @\$12,941	\$4,994,005 @\$11,000
37	\$5,887,700 @\$12,969	\$5,004,545 @\$11,023
38	\$5,900,100 @\$12,996	\$5,015,085 @\$11,046
39	\$5,912,500 @\$13,023	\$5,025,625 @\$11,070
40	\$5,925,000 @\$13,051	\$5,036,250 @\$11,093
41	\$5,943,600 @\$13,092	\$5,052,060 @\$11,128
42	\$5,962,400 @\$13,133	\$5,068,040 @\$11,163
43	\$5,981,300 @\$13,175	\$5,084,105 @\$11,198
45	\$6,000,200 @\$13,216	\$5,100,170 @\$11,234

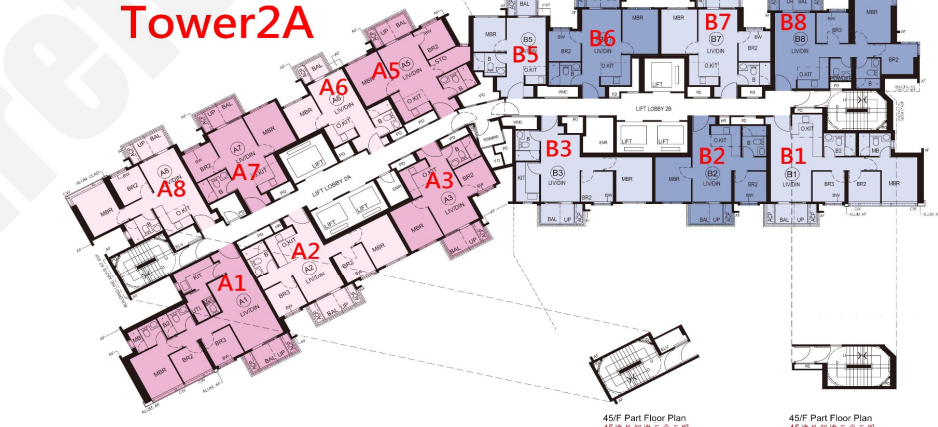

T2B B8: 3房 568'

樓層	訂價	折實價13.5%
5	\$6,587,300 @\$11,597	\$5,599,205 @\$9,858
6	\$6,761,200 @\$11,904	\$5,747,020 @\$10,118
7	\$6,819,600 @\$12,006	\$5,796,660 @\$10,205
8	\$6,877,900 @\$12,109	\$5,846,215 @\$10,293
9	\$6,921,800 @\$12,186	\$5,883,530 @\$10,358
10	\$6,966,100 @\$12,264	\$5,921,185 @\$10,425
11	\$7,003,100 @\$12,329	\$5,952,635 @\$10,480

紅色為最高售價、最高平均呎價；藍色為最低售價、最低平均呎價

以上的物業資料只供參考，一切以發展商最新公布為準，如有任何資料錯漏本網頁不會承擔任何責任。