

J: 1房 286'		
樓層	訂價	折實價16%
23	\$5,414,000 @\$18,930	\$4,547,760 @\$15,901
22	\$5,393,000 @\$18,857	\$4,530,120 @\$15,840
21	\$5,377,000 @\$18,801	\$4,516,680 @\$15,793
20	\$5,367,000 @\$18,766	\$4,508,280 @\$15,763
19	\$5,356,000 @\$18,727	\$4,499,040 @\$15,731
11	\$5,168,000 @\$18,070	\$4,341,120 @\$15,179
10	\$5,139,000 @\$17,969	\$4,316,760 @\$15,094
9	\$5,110,000 @\$17,867	\$4,292,400 @\$15,008
8	\$5,060,000 @\$17,692	\$4,250,400 @\$14,862
7	\$5,033,000 @\$17,598	\$4,227,720 @\$14,782
6	\$5,004,000 @\$17,497	\$4,203,360 @\$14,697
5	\$4,965,000 @\$17,360	\$4,170,600 @\$14,583
3	\$4,925,000 @\$17,220	\$4,137,000 @\$14,465
2	\$4,850,000 @\$16,958	\$4,074,000 @\$14,245
1	\$4,763,000 @\$16,654	\$4,000,920 @\$13,989
E: 3房連套房 714/717'		
樓層	訂價	折實價19%
23	\$14,631,000 @\$20,492	\$11,851,110 @\$16,598
22	\$14,587,000 @\$20,430	\$11,815,470 @\$16,548
21	\$14,543,000 @\$20,368	\$11,779,830 @\$16,498
20	\$14,360,000 @\$20,112	\$11,631,600 @\$16,291
17	\$14,134,000 @\$19,796	\$11,448,540 @\$16,034
16	\$14,092,000 @\$19,737	\$11,414,520 @\$15,987
15	\$14,049,000 @\$19,676	\$11,379,690 @\$15,938
12	\$14,008,000 @\$19,619	\$11,346,480 @\$15,891
7	\$13,625,000 @\$19,083	\$11,036,250 @\$15,457
6	\$13,489,000 @\$18,892	\$10,926,090 @\$15,303
5	\$13,286,000 @\$18,608	\$10,761,660 @\$15,072
3	\$13,088,000 @\$18,331	\$10,601,280 @\$14,848
2	\$12,879,000 @\$17,962	\$10,431,990 @\$14,549
H: 1房 287'		
樓層	訂價	折實價16%
11	\$5,486,000 @\$19,115	\$4,608,240 @\$16,057
10	\$5,463,000 @\$19,035	\$4,588,920 @\$15,989
9	\$5,441,000 @\$18,958	\$4,570,440 @\$15,925
8	\$5,386,000 @\$18,767	\$4,524,240 @\$15,764
7	\$5,364,000 @\$18,690	\$4,505,760 @\$15,700
6	\$5,343,000 @\$18,617	\$4,488,120 @\$15,638
5	\$5,300,000 @\$18,467	\$4,452,000 @\$15,512
3	\$5,257,000 @\$18,317	\$4,415,880 @\$15,386
2	\$5,180,000 @\$18,049	\$4,351,200 @\$15,161
1	\$5,086,000 @\$17,721	\$4,272,240 @\$14,886

D: 2房 466/468'		
樓層	訂價	折實價16%
23	\$9,827,000 @\$21,088	\$8,254,680 @\$17,714
22	\$9,780,000 @\$20,987	\$8,215,200 @\$17,629
21	\$9,730,000 @\$20,880	\$8,173,200 @\$17,539
20	\$9,589,000 @\$20,577	\$8,054,760 @\$17,285
17	\$9,401,000 @\$20,174	\$7,896,840 @\$16,946
16	\$9,344,000 @\$20,052	\$7,848,960 @\$16,843
15	\$9,288,000 @\$19,931	\$7,801,920 @\$16,742
12	\$9,270,000 @\$19,893	\$7,786,800 @\$16,710
11	\$9,252,000 @\$19,854	\$7,771,680 @\$16,677
10	\$9,143,000 @\$19,620	\$7,680,120 @\$16,481
9	\$9,126,000 @\$19,584	\$7,665,840 @\$16,450
8	\$9,107,000 @\$19,543	\$7,649,880 @\$16,416
7	\$9,089,000 @\$19,504	\$7,634,760 @\$16,384
6	\$9,062,000 @\$19,446	\$7,612,080 @\$16,335
5	\$9,034,000 @\$19,386	\$7,588,560 @\$16,284
3	\$8,990,000 @\$19,292	\$7,551,600 @\$16,205
2	\$8,872,000 @\$19,039	\$7,452,480 @\$15,992
1	\$8,776,000 @\$18,752	\$7,371,840 @\$15,752
G: 1房 274/278'		
樓層	訂價	折實價16%
11	\$4,959,000 @\$18,099	\$4,165,560 @\$15,203
10	\$4,944,000 @\$18,044	\$4,152,960 @\$15,157
9	\$4,930,000 @\$17,993	\$4,141,200 @\$15,114
8	\$4,913,000 @\$17,931	\$4,126,920 @\$15,062
7	\$4,900,000 @\$17,883	\$4,116,000 @\$15,022
3	\$4,806,000 @\$17,540	\$4,037,040 @\$14,734
2	\$4,735,000 @\$17,281	\$3,977,400 @\$14,516
1	\$4,718,000 @\$16,971	\$3,963,120 @\$14,256

C: 2房 442'		
樓層	訂價	折實價16%
23	\$9,102,000 @\$20,593	\$7,645,680 @\$17,298
22	\$9,068,000 @\$20,516	\$7,617,120 @\$17,233
21	\$9,031,000 @\$20,432	\$7,586,040 @\$17,163
20	\$8,909,000 @\$20,156	\$7,483,560 @\$16,931
17	\$8,751,000 @\$19,799	\$7,350,840 @\$16,631
16	\$8,708,000 @\$19,701	\$7,314,720 @\$16,549
15	\$8,664,000 @\$19,602	\$7,277,760 @\$16,466
12	\$8,646,000 @\$19,561	\$7,262,640 @\$16,431
11	\$8,629,000 @\$19,523	\$7,248,360 @\$16,399
10	\$8,528,000 @\$19,294	\$7,163,520 @\$16,207
9	\$8,512,000 @\$19,258	\$7,150,080 @\$16,177
8	\$8,495,000 @\$19,219	\$7,135,800 @\$16,144
7	\$8,477,000 @\$19,179	\$7,120,680 @\$16,110
6	\$8,452,000 @\$19,122	\$7,099,680 @\$16,063
5	\$8,427,000 @\$19,066	\$7,078,680 @\$16,015
3	\$8,385,000 @\$18,971	\$7,043,400 @\$15,935
2	\$8,275,000 @\$18,722	\$6,951,000 @\$15,726
1	\$8,151,000 @\$18,441	\$6,846,840 @\$15,491
B: 3房連套房 729'		
樓層	訂價	折實價19%
6	\$14,696,000 @\$20,159	\$11,903,760 @\$16,329
5	\$14,636,000 @\$20,077	\$11,855,160 @\$16,262
3	\$14,519,000 @\$19,916	\$11,760,390 @\$16,132
2	\$14,330,000 @\$19,657	\$11,607,300 @\$15,922
1	\$14,115,000 @\$19,362	\$11,433,150 @\$15,683

K: 1房 273'		
樓層	訂價	折實價16%
11	\$4,864,000 @\$17,817	\$4,085,760 @\$14,966
10	\$4,845,000 @\$17,747	\$4,069,800 @\$14,908
9	\$4,827,000 @\$17,681	\$4,054,680 @\$14,852
8	\$4,778,000 @\$17,502	\$4,013,520 @\$14,702
7	\$4,758,000 @\$17,429	\$3,996,720 @\$14,640
3	\$4,663,000 @\$17,081	\$3,916,920 @\$14,348
2	\$4,593,000 @\$16,824	\$3,858,120 @\$14,132
1	\$4,510,000 @\$16,520	\$3,788,400 @\$13,877
A: 3房連套房 736'		
樓層	訂價	折實價19%
6	\$14,763,000 @\$20,058	\$11,958,030 @\$16,247
5	\$14,674,000 @\$19,938	\$11,885,940 @\$16,149
3	\$14,557,000 @\$19,779	\$11,791,170 @\$16,021
2	\$14,441,000 @\$19,621	\$11,697,210 @\$15,893
1	\$14,223,000 @\$19,325	\$11,520,630 @\$15,653

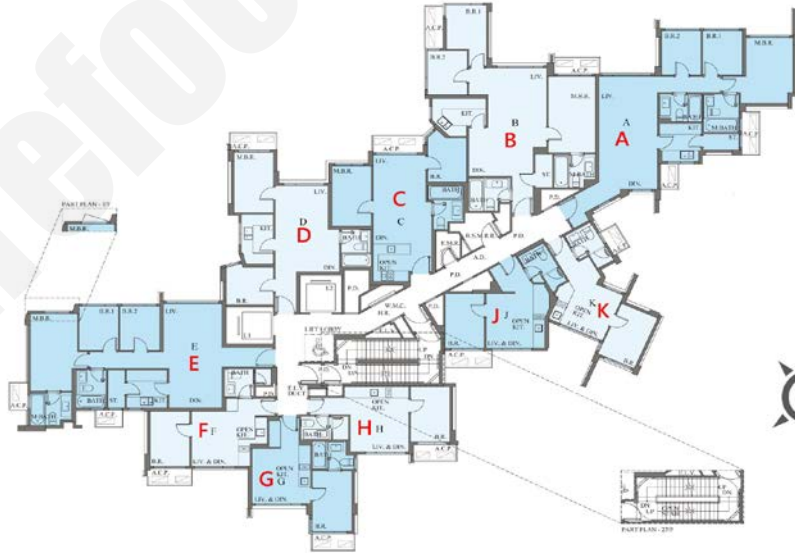

紅色為最高售價、最高平均呎價；藍色為最低售價、最低平均呎價