

T1 B08 : 1房 329'		
樓層	訂價	折實價14%
11	\$5,543,000 @\$16,848	\$4,766,980 @\$14,489
10	\$5,517,000 @\$16,769	\$4,744,620 @\$14,421
9	\$5,490,000 @\$16,687	\$4,721,400 @\$14,351
8	\$5,464,000 @\$16,608	\$4,699,040 @\$14,283
7	\$5,437,000 @\$16,526	\$4,675,820 @\$14,212
6	\$5,411,000 @\$16,447	\$4,653,460 @\$14,144
5	\$5,385,000 @\$16,368	\$4,631,100 @\$14,076
3	\$5,358,000 @\$16,286	\$4,607,880 @\$14,006
2	\$5,332,000 @\$16,207	\$4,585,520 @\$13,938

T1 B06 : 2房 439'		
樓層	訂價	折實價14%
11	\$5,543,000 @\$16,848	\$4,766,980 @\$14,489
10	\$5,517,000 @\$16,769	\$4,744,620 @\$14,421
9	\$5,490,000 @\$16,687	\$4,721,400 @\$14,351
8	\$5,464,000 @\$16,608	\$4,699,040 @\$14,283
7	\$5,437,000 @\$16,526	\$4,675,820 @\$14,212
6	\$5,411,000 @\$16,447	\$4,653,460 @\$14,144
5	\$5,385,000 @\$16,368	\$4,631,100 @\$14,076
3	\$5,358,000 @\$16,286	\$4,607,880 @\$14,006
2	\$5,332,000 @\$16,207	\$4,585,520 @\$13,938
3	\$9,347,000 @\$24,597	\$8,879,650 @\$23,368
2	\$9,289,000 @\$24,445	\$8,824,550 @\$23,223

T1 B05 : 2房 410'		
樓層	訂價	折實價14%
11	\$6,681,000 @\$16,295	\$5,745,660 @\$14,014
10	\$6,649,000 @\$16,217	\$5,718,140 @\$13,947
9	\$6,617,000 @\$16,139	\$5,690,620 @\$13,880
8	\$6,585,000 @\$16,061	\$5,663,100 @\$13,812
7	\$6,554,000 @\$15,985	\$5,636,440 @\$13,747
6	\$6,522,000 @\$15,907	\$5,608,920 @\$13,680
5	\$6,490,000 @\$15,829	\$5,581,400 @\$13,613
3	\$6,458,000 @\$15,751	\$5,553,880 @\$13,546
2	\$6,426,000 @\$15,673	\$5,526,360 @\$13,479

T1 B03 : 2房 452'		
樓層	訂價	折實價14%
11	\$7,212,000 @\$15,956	\$6,202,320 @\$13,722
10	\$7,177,000 @\$15,878	\$6,172,220 @\$13,655
9	\$7,143,000 @\$15,803	\$6,142,980 @\$13,591
8	\$7,109,000 @\$15,728	\$6,113,740 @\$13,526
7	\$7,074,000 @\$15,650	\$6,083,640 @\$13,459
6	\$7,040,000 @\$15,575	\$6,054,400 @\$13,395
5	\$7,006,000 @\$15,500	\$6,025,160 @\$13,330
3	\$6,972,000 @\$15,425	\$5,995,920 @\$13,265
2	\$6,937,000 @\$15,347	\$5,965,820 @\$13,199

T1 B01 : 2房 435'		
樓層	訂價	折實價14%
11	\$5,543,000 @\$16,848	\$4,766,980 @\$14,489
10	\$5,517,000 @\$16,769	\$4,744,620 @\$14,421
9	\$5,490,000 @\$16,687	\$4,721,400 @\$14,351
8	\$5,464,000 @\$16,608	\$4,699,040 @\$14,283
7	\$5,437,000 @\$16,526	\$4,675,820 @\$14,212
6	\$5,411,000 @\$16,447	\$4,653,460 @\$14,144
5	\$5,385,000 @\$16,368	\$4,631,100 @\$14,076
3	\$5,358,000 @\$16,286	\$4,607,880 @\$14,006
2	\$5,332,000 @\$16,207	\$4,585,520 @\$13,938

T1 A11 : 2房 449'		
樓層	訂價	折實價14%
11	\$7,333,000 @\$16,332	\$6,306,380 @\$14,045
10	\$7,298,000 @\$16,254	\$6,276,280 @\$13,978
9	\$7,263,000 @\$16,176	\$6,246,180 @\$13,911
8	\$7,228,000 @\$16,098	\$6,216,080 @\$13,844
7	\$7,193,000 @\$16,020	\$6,185,980 @\$13,777
6	\$7,158,000 @\$15,942	\$6,155,880 @\$13,710
5	\$7,124,000 @\$15,866	\$6,126,640 @\$13,645
3	\$7,089,000 @\$15,788	\$6,096,540 @\$13,578
2	\$7,054,000 @\$15,710	\$6,066,440 @\$13,511

T1 A10 : 2房 426'		
樓層	訂價	折實價14%
11	\$7,031,000 @\$16,505	\$6,046,660 @\$14,194
10	\$6,997,000 @\$16,425	\$6,017,420 @\$14,125
9	\$6,964,000 @\$16,347	\$5,989,040 @\$14,059
8	\$6,930,000 @\$16,268	\$5,959,800 @\$13,990
7	\$6,897,000 @\$16,190	\$5,931,420 @\$13,924
6	\$6,863,000 @\$16,110	\$5,902,180 @\$13,855
5	\$6,830,000 @\$16,033	\$5,873,800 @\$13,788
3	\$6,796,000 @\$15,953	\$5,844,560 @\$13,720
2	\$6,763,000 @\$15,876	\$5,816,180 @\$13,653

T1 A9 : 2房 450'		
樓層	訂價	折實價14%
11	\$7,308,000 @\$16,240	\$6,284,880 @\$13,966
10	\$7,274,000 @\$16,164	\$6,255,640 @\$13,901
9	\$7,239,000 @\$16,087	\$6,225,540 @\$13,835
8	\$7,204,000 @\$16,009	\$6,195,440 @\$13,768
7	\$7,169,000 @\$15,931	\$6,165,340 @\$13,701
6	\$7,134,000 @\$15,853	\$6,135,240 @\$13,634
5	\$7,100,000 @\$15,778	\$6,106,000 @\$13,569
3	\$7,065,000 @\$15,700	\$6,075,900 @\$13,502
2	\$7,030,000 @\$15,622	\$6,045,800 @\$13,435

T1 A01 : 2房 399'		
樓層	訂價	折實價14%
11	\$6,654,000 @\$16,677	\$5,722,440 @\$14,342
10	\$6,622,000 @\$16,596	\$5,694,920 @\$14,273
9	\$6,590,000 @\$16,516	\$5,667,400 @\$14,204
8	\$6,559,000 @\$16,439	\$5,640,740 @\$14,137
7	\$6,527,000 @\$16,358	\$5,613,220 @\$14,068
6	\$6,495,000 @\$16,278	\$5,585,700 @\$13,999
5	\$6,464,000 @\$16,201	\$5,559,040 @\$13,932
3	\$6,432,000 @\$16,120	\$5,531,520 @\$13,863
2	\$6,400,000 @\$16,040	\$5,504,000 @\$13,794

T1 B02 : 2房 452'		
樓層	訂價	折實價14%
8	\$7,328,000 @\$16,212	\$6,302,080 @\$13,943
7	\$7,292,000 @\$16,133	\$6,271,120 @\$13,874
6	\$7,257,000 @\$16,055	\$6,241,020 @\$13,808
5	\$7,221,000 @\$15,976	\$6,210,060 @\$13,739
3	\$7,186,000 @\$15,898	\$6,179,960 @\$13,672
2	\$7,151,000 @\$15,821	\$6,149,860 @\$13,606

紅色為最高售價、最高平均呎價；藍色為最低售價、最低平均呎價

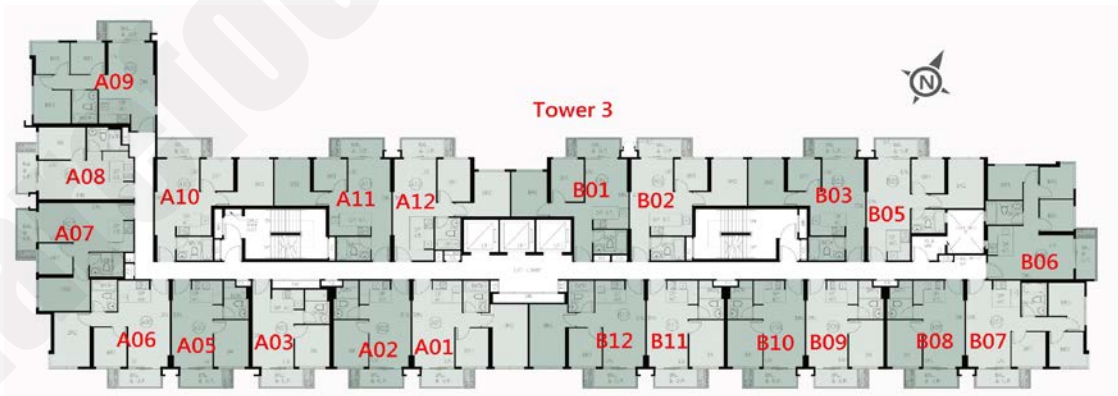

T3 A03 : 1房 329'		
樓層	訂價	折實價14%
12	\$5,717,000 @\$17,537	\$4,916,620 @\$15,082
11	\$5,250,000 @\$16,104	\$4,515,000 @\$13,850
10	\$5,234,000 @\$16,055	\$4,501,240 @\$13,807
9	\$5,219,000 @\$16,009	\$4,488,340 @\$13,768
8	\$5,204,000 @\$15,963	\$4,475,440 @\$13,728
7	\$5,189,000 @\$15,917	\$4,462,540 @\$13,689
6	\$5,173,000 @\$15,868	\$4,448,780 @\$13,647
5	\$5,158,000 @\$15,822	\$4,435,880 @\$13,607
3	\$5,143,000 @\$15,776	\$4,422,980 @\$13,567
2	\$5,127,000 @\$15,727	\$4,409,220 @\$13,525

T3 B12 : 2房 449'		
樓層	訂價	折實價14%
11	\$6,920,000 @\$15,412	\$5,951,200 @\$13,254
10	\$6,900,000 @\$15,367	\$5,934,000 @\$13,216
9	\$6,880,000 @\$15,323	\$5,916,800 @\$13,178
8	\$6,860,000 @\$15,278	\$5,899,600 @\$13,139
7	\$6,840,000 @\$15,234	\$5,882,400 @\$13,101
6	\$6,819,000 @\$15,187	\$5,864,340 @\$13,061
5	\$6,799,000 @\$15,143	\$5,847,140 @\$13,023
3	\$6,624,500 @\$14,754	\$5,697,070 @\$12,688

T3 B08 : 1房 340'		
樓層	訂價	折實價14%
11	\$5,421,000 @\$15,944	\$4,662,060 @\$13,712
10	\$5,405,000 @\$15,897	\$4,648,300 @\$13,671
9	\$5,389,000 @\$15,850	\$4,634,540 @\$13,631
8	\$5,374,000 @\$15,806	\$4,621,640 @\$13,593
7	\$5,358,000 @\$15,759	\$4,607,880 @\$13,553
6	\$5,342,000 @\$15,712	\$4,594,120 @\$13,512
5	\$5,326,000 @\$15,665	\$4,580,360 @\$13,472
3	\$5,310,000 @\$15,618	\$4,566,600 @\$13,431

T3 B03 : 2房 433'		
樓層	訂價	折實價14%
11	\$7,072,000 @\$16,333	\$6,081,920 @\$14,046
10	\$7,038,000 @\$16,254	\$6,052,680 @\$13,978
9	\$7,004,000 @\$16,176	\$6,023,440 @\$13,911
8	\$6,971,000 @\$16,099	\$5,995,060 @\$13,845
7	\$6,937,000 @\$16,021	\$5,965,820 @\$13,778
6	\$6,903,000 @\$15,942	\$5,936,580 @\$13,710
5	\$6,870,000 @\$15,866	\$5,908,200 @\$13,645
3	\$6,836,000 @\$15,788	\$5,878,960 @\$13,577
2	\$6,802,000 @\$15,709	\$5,849,720 @\$13,510

T3 B07 : 3房 498'		
樓層	訂價	折實價14%
6	\$8,209,000 @\$16,484	\$7,059,740 @\$14,176
5	\$8,185,000 @\$16,436	\$7,039,100 @\$14,135

紅色為最高售價、最高平均呎價；藍色為最低售價、最低平均呎價