

新盤價單表

KOKO Mare

價單1號

以最高12%折扣計算
制作日期: 2023-03-28

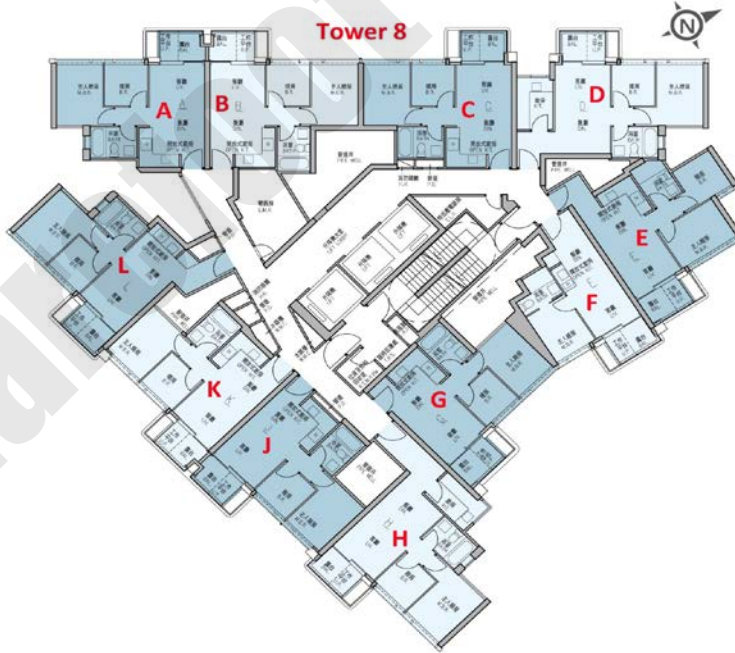

G: 2房 437/441'

樓層	訂價	折實價12%
26	\$10,342,000 @\$23,666	\$9,100,960 @\$20,826
25	\$9,394,000 @\$21,497	\$8,266,720 @\$18,917
23	\$9,386,000 @\$21,478	\$8,259,680 @\$18,901
22	\$9,374,000 @\$21,256	\$8,249,120 @\$18,705
21	\$9,346,000 @\$21,193	\$8,224,480 @\$18,650
20	\$9,318,000 @\$21,129	\$8,199,840 @\$18,594
19	\$9,289,000 @\$21,063	\$8,174,320 @\$18,536
18	\$9,261,000 @\$21,000	\$8,149,680 @\$18,480
17	\$9,205,000 @\$20,873	\$8,100,400 @\$18,368
16	\$9,181,000 @\$20,819	\$8,079,280 @\$18,320
15	\$9,158,000 @\$20,766	\$8,059,040 @\$18,274
12	\$9,133,000 @\$20,710	\$8,037,040 @\$18,225
11	\$9,111,000 @\$20,660	\$8,017,680 @\$18,181
10	\$9,096,000 @\$20,626	\$8,004,480 @\$18,151
9	\$9,082,000 @\$20,594	\$7,992,160 @\$18,123
8	\$9,069,000 @\$20,565	\$7,980,720 @\$18,097
7	\$9,041,000 @\$20,501	\$7,956,080 @\$18,041
6	\$9,029,000 @\$20,474	\$7,945,520 @\$18,017
5	\$9,014,000 @\$20,440	\$7,932,320 @\$17,987
3	\$9,002,000 @\$20,413	\$7,921,760 @\$17,963
2	\$8,987,000 @\$20,379	\$7,908,560 @\$17,933

H: 2房 470/520'

樓層	訂價	折實價12%
22	\$11,285,000 @\$21,702	\$9,930,800 @\$19,098
21	\$11,240,000 @\$21,615	\$9,891,200 @\$19,022
20	\$11,196,000 @\$21,531	\$9,852,480 @\$18,947
19	\$11,151,000 @\$21,444	\$9,812,880 @\$18,871
18	\$11,107,000 @\$21,360	\$9,774,160 @\$18,796
17	\$11,019,000 @\$21,190	\$9,696,720 @\$18,648
16	\$10,975,000 @\$21,106	\$9,658,000 @\$18,573
15	\$10,823,000 @\$20,813	\$9,524,240 @\$18,316
12	\$10,467,000 @\$20,129	\$9,210,960 @\$17,713
11	\$10,323,000 @\$19,852	\$9,084,240 @\$17,470
10	\$10,227,000 @\$19,667	\$8,999,760 @\$17,307
9	\$10,202,000 @\$19,619	\$8,977,760 @\$17,265
8	\$10,177,000 @\$19,571	\$8,955,760 @\$17,223
7	\$10,127,000 @\$19,475	\$8,911,760 @\$17,138
6	\$10,102,000 @\$19,427	\$8,889,760 @\$17,096
5	\$10,077,000 @\$19,379	\$8,867,760 @\$17,053
3	\$10,052,000 @\$19,331	\$8,845,760 @\$17,011
2	\$10,045,000 @\$19,317	\$8,839,600 @\$16,999
1	\$11,094,000 @\$23,604	\$9,762,720 @\$20,772

F: 1房 334'

樓層	訂價	折實價12%
23	\$7,386,000 @\$22,114	\$6,499,680 @\$19,460
22	\$7,363,000 @\$22,045	\$6,479,440 @\$19,400
21	\$7,340,000 @\$21,976	\$6,459,200 @\$19,339
20	\$7,319,000 @\$21,913	\$6,440,720 @\$19,284
19	\$7,282,000 @\$21,802	\$6,408,160 @\$19,186
18	\$7,218,000 @\$21,611	\$6,351,840 @\$19,017
17	\$7,160,000 @\$21,437	\$6,300,800 @\$18,865
16	\$7,138,000 @\$21,371	\$6,281,440 @\$18,807
15	\$7,116,000 @\$21,305	\$6,262,080 @\$18,749
12	\$7,095,000 @\$21,243	\$6,243,600 @\$18,693
11	\$7,073,000 @\$21,177	\$6,224,240 @\$18,635
10	\$7,052,000 @\$21,114	\$6,205,760 @\$18,580
9	\$7,016,000 @\$21,006	\$6,174,080 @\$18,485
8	\$6,954,000 @\$20,820	\$6,119,520 @\$18,322
7	\$6,818,000 @\$20,413	\$5,999,840 @\$17,964
6	\$6,800,000 @\$20,359	\$5,984,000 @\$17,916
5	\$6,782,000 @\$20,305	\$5,968,160 @\$17,869
3	\$6,764,000 @\$20,251	\$5,952,320 @\$17,821
2	\$6,746,000 @\$20,198	\$5,936,480 @\$17,774

E: 2房 464'

樓層	訂價	折實價12%
26	\$10,768,000 @\$23,207	\$9,475,840 @\$20,422
25	\$9,407,000 @\$20,274	\$8,278,160 @\$17,841
23	\$9,379,000 @\$20,213	\$8,253,520 @\$17,788
22	\$9,350,000 @\$20,151	\$8,228,000 @\$17,733
21	\$9,322,000 @\$20,091	\$8,203,360 @\$17,680
20	\$9,294,000 @\$20,030	\$8,178,720 @\$17,627
19	\$9,265,000 @\$19,968	\$8,153,200 @\$17,572
18	\$9,237,000 @\$19,907	\$8,128,560 @\$17,518
17	\$9,181,000 @\$19,787	\$8,079,280 @\$17,412
16	\$9,157,000 @\$19,735	\$8,058,160 @\$17,367
15	\$9,133,000 @\$19,683	\$8,037,040 @\$17,321
12	\$9,110,000 @\$19,634	\$8,016,800 @\$17,278
11	\$9,087,000 @\$19,584	\$7,996,560 @\$17,234
10	\$9,073,000 @\$19,554	\$7,984,240 @\$17,207
9	\$9,060,000 @\$19,526	\$7,972,800 @\$17,183
8	\$9,046,000 @\$19,496	\$7,960,480 @\$17,156
7	\$9,019,000 @\$19,438	\$7,936,720 @\$17,105
6	\$9,005,000 @\$19,407	\$7,924,400 @\$17,078
5	\$8,991,000 @\$19,377	\$7,912,080 @\$17,052
3	\$8,978,000 @\$19,349	\$7,900,640 @\$17,027
2	\$8,963,000 @\$19,317	\$7,887,440 @\$16,999

I: 2房 388/425'

樓層	訂價	折實價12%
22	\$9,653,000 @\$22,713	\$8,494,640 @\$19,987
21	\$9,615,000 @\$22,624	\$8,461,200 @\$19,909
20	\$9,576,000 @\$22,532	\$8,426,880 @\$19,828
19	\$9,538,000 @\$22,442	\$8,393,440 @\$19,749
18	\$9,500,000 @\$22,353	\$8,360,000 @\$19,671
17	\$9,425,000 @\$22,176	\$8,294,000 @\$19,515
16	\$9,387,000 @\$22,087	\$8,260,560 @\$19,437
15	\$9,258,000 @\$21,784	\$8,147,040 @\$19,170
12	\$9,090,000 @\$21,388	\$7,999,200 @\$18,822
11	\$9,033,000 @\$21,254	\$7,949,040 @\$18,704
10	\$8,944,000 @\$21,045	\$7,870,720 @\$18,519
9	\$8,927,000 @\$21,005	\$7,855,760 @\$18,484
8	\$8,911,000 @\$20,967	\$7,841,680 @\$18,451
7	\$8,876,000 @\$20,885	\$7,810,880 @\$18,379
6	\$8,859,000 @\$20,845	\$7,795,920 @\$18,343
5	\$8,842,000 @\$20,805	\$7,780,960 @\$18,308
3	\$8,826,000 @\$20,767	\$7,766,880 @\$18,275
2	\$8,809,000 @\$20,727	\$7,751,920 @\$18,240
1	\$10,157,000 @\$26,178	\$8,938,160 @\$23,036

紅色為最高售價、最高平均呎價；藍色為最低售價、最低平均呎價

以上的物業資料只供參考，一切以發展商最新公布為準，如有任何資料錯漏本網頁不會承擔任何責任。