

1A座D : 2房 453'/454'		
樓層	訂價	折實價15%
33	\$7,267,000 @\$16,007	\$6,176,950 @\$13,608
32	\$7,247,000 @\$15,963	\$6,159,950 @\$13,568
31	\$7,228,000 @\$15,921	\$6,143,800 @\$13,533
30	\$7,209,000 @\$15,879	\$6,127,650 @\$13,497
29	\$7,191,000 @\$15,839	\$6,112,350 @\$13,463
28	\$7,175,000 @\$15,839	\$6,098,750 @\$13,463
27	\$7,136,000 @\$15,753	\$6,065,600 @\$13,390
26	\$7,118,000 @\$15,713	\$6,050,300 @\$13,356
25	\$7,100,000 @\$15,673	\$6,035,000 @\$13,322
23	\$7,081,000 @\$15,631	\$6,018,850 @\$13,287
22	\$7,064,000 @\$15,594	\$6,004,400 @\$13,255
21	\$7,046,000 @\$15,554	\$5,989,100 @\$13,221
20	\$7,025,000 @\$15,508	\$5,971,250 @\$13,182
19	\$7,011,000 @\$15,477	\$5,959,350 @\$13,155
18	\$7,011,000 @\$15,477	\$5,959,350 @\$13,155
17	\$6,982,000 @\$15,413	\$5,934,700 @\$13,101
16	\$6,968,000 @\$15,382	\$5,922,800 @\$13,075
15	\$6,954,000 @\$15,351	\$5,910,900 @\$13,048
12	\$6,940,000 @\$15,320	\$5,899,000 @\$13,022
11	\$6,927,000 @\$15,291	\$5,887,950 @\$12,998
10	\$6,913,000 @\$15,260	\$5,876,050 @\$12,971
9	\$6,899,000 @\$15,230	\$5,864,150 @\$12,945
8	\$6,899,000 @\$15,230	\$5,864,150 @\$12,945
7	\$6,871,000 @\$15,168	\$5,840,350 @\$12,893
6	\$6,858,000 @\$15,139	\$5,829,300 @\$12,868
5	\$6,845,000 @\$15,110	\$5,818,250 @\$12,844
3	\$6,811,000 @\$15,035	\$5,789,350 @\$12,780

1A座C : 2房 444'		
樓層	訂價	折實價15%
27	\$7,080,000 @\$15,946	\$6,018,000 @\$13,554
26	\$7,062,000 @\$15,905	\$6,002,700 @\$13,520
25	\$7,045,000 @\$15,867	\$5,988,250 @\$13,487
23	\$7,026,000 @\$15,824	\$5,972,100 @\$13,451
22	\$7,007,000 @\$15,782	\$5,955,950 @\$13,414
21	\$6,989,000 @\$15,741	\$5,940,650 @\$13,380
20	\$6,968,000 @\$15,694	\$5,922,800 @\$13,340
19	\$6,955,000 @\$15,664	\$5,911,750 @\$13,315
18	\$6,955,000 @\$15,664	\$5,911,750 @\$13,315
17	\$6,927,000 @\$15,601	\$5,887,950 @\$13,261
16	\$6,913,000 @\$15,570	\$5,876,050 @\$13,234
15	\$6,899,000 @\$15,538	\$5,864,150 @\$13,208
12	\$6,885,000 @\$15,507	\$5,852,250 @\$13,181
11	\$6,872,000 @\$15,477	\$5,841,200 @\$13,156
10	\$6,858,000 @\$15,446	\$5,829,300 @\$13,129
9	\$6,845,000 @\$15,417	\$5,818,250 @\$13,104
8	\$6,845,000 @\$15,417	\$5,818,250 @\$13,104
7	\$6,818,000 @\$15,356	\$5,795,300 @\$13,052
6	\$6,804,000 @\$15,324	\$5,783,400 @\$13,026
5	\$6,791,000 @\$15,295	\$5,772,350 @\$13,001
3	\$6,756,000 @\$15,216	\$5,742,600 @\$12,934

1A座A1 : 3房連套房 671'		
樓層	訂價	折實價15%
22	\$10,736,000 @\$16,000	\$9,125,600 @\$13,600
21	\$10,721,000 @\$15,978	\$9,112,850 @\$13,581
20	\$10,705,000 @\$15,954	\$9,099,250 @\$13,561
19	\$10,684,000 @\$15,923	\$9,081,400 @\$13,534
17	\$10,641,000 @\$15,858	\$9,044,850 @\$13,480
16	\$10,620,000 @\$15,827	\$9,027,000 @\$13,453
15	\$10,598,000 @\$15,794	\$9,008,300 @\$13,425
12	\$10,578,000 @\$15,765	\$8,991,300 @\$13,400
11	\$10,558,000 @\$15,735	\$8,974,300 @\$13,375
10	\$10,536,000 @\$15,702	\$8,955,600 @\$13,347
9	\$10,515,000 @\$15,671	\$8,937,750 @\$13,320
8	\$10,515,000 @\$15,671	\$8,937,750 @\$13,320
7	\$10,473,000 @\$15,608	\$8,902,050 @\$13,267
6	\$10,452,000 @\$15,577	\$8,884,200 @\$13,240
5	\$10,430,000 @\$15,544	\$8,865,500 @\$13,212
3	\$10,409,000 @\$15,513	\$8,847,650 @\$13,186

紅色為最高售價、最高平均呎價；藍色為最低售價、最低平均呎價

1B座L: 2房 457'		
樓層	訂價	折實價15%
23	\$7,281,000 @\$15,932	<b>\$6,188,850</b> <b>@\$13,542</b>
22	\$7,262,000 @\$15,891	\$6,172,700 @\$13,507
21	\$7,244,000 @\$15,851	\$6,157,400 @\$13,474
20	\$7,225,000 @\$15,810	\$6,141,250 @\$13,438
19	\$7,211,000 @\$15,779	\$6,129,350 @\$13,412
17	\$7,181,000 @\$15,713	\$6,103,850 @\$13,356
16	\$7,167,000 @\$15,683	\$6,091,950 @\$13,330
15	\$7,153,000 @\$15,652	\$6,080,050 @\$13,304
12	\$7,138,000 @\$15,619	\$6,067,300 @\$13,276
11	\$7,124,000 @\$15,589	\$6,055,400 @\$13,250
10	\$7,109,000 @\$15,556	\$6,042,650 @\$13,222
9	\$7,096,000 @\$15,527	\$6,031,600 @\$13,198
8	\$7,096,000 @\$15,527	\$6,031,600 @\$13,198
7	\$7,068,000 @\$15,466	\$6,007,800 @\$13,146
6	\$7,054,000 @\$15,435	\$5,995,900 @\$13,120
5	\$7,040,000 @\$15,405	\$5,984,000 @\$13,094
3	\$7,026,000 @\$15,374	<b>\$5,972,100</b> <b>@\$13,068</b>

1B座G: 2房 455'		
樓層	訂價	折實價15%
22	\$7,251,000 @\$15,936	\$6,163,350 @\$13,546
21	\$7,231,000 @\$15,892	\$6,146,350 @\$13,508
20	\$7,212,000 @\$15,851	\$6,130,200 @\$13,473
19	\$7,198,000 @\$15,820	\$6,118,300 @\$13,447
18	\$7,198,000 @\$15,820	\$6,118,300 @\$13,447
17	\$7,169,000 @\$15,756	\$6,093,650 @\$13,393
16	\$7,154,000 @\$15,723	\$6,080,900 @\$13,365
15	\$7,140,000 @\$15,692	\$6,069,000 @\$13,338
12	\$7,126,000 @\$15,662	\$6,057,100 @\$13,312
11	\$7,112,000 @\$15,631	\$6,045,200 @\$13,286
10	\$7,099,000 @\$15,602	\$6,034,150 @\$13,262
9	\$7,084,000 @\$15,569	\$6,021,400 @\$13,234
8	\$7,084,000 @\$15,569	\$6,021,400 @\$13,234
7	\$7,055,000 @\$15,505	\$5,996,750 @\$13,180
6	\$7,041,000 @\$15,475	\$5,984,850 @\$13,154
5	\$7,027,000 @\$15,444	\$5,972,950 @\$13,127
3	\$7,013,000 @\$15,413	\$5,961,050 @\$13,101

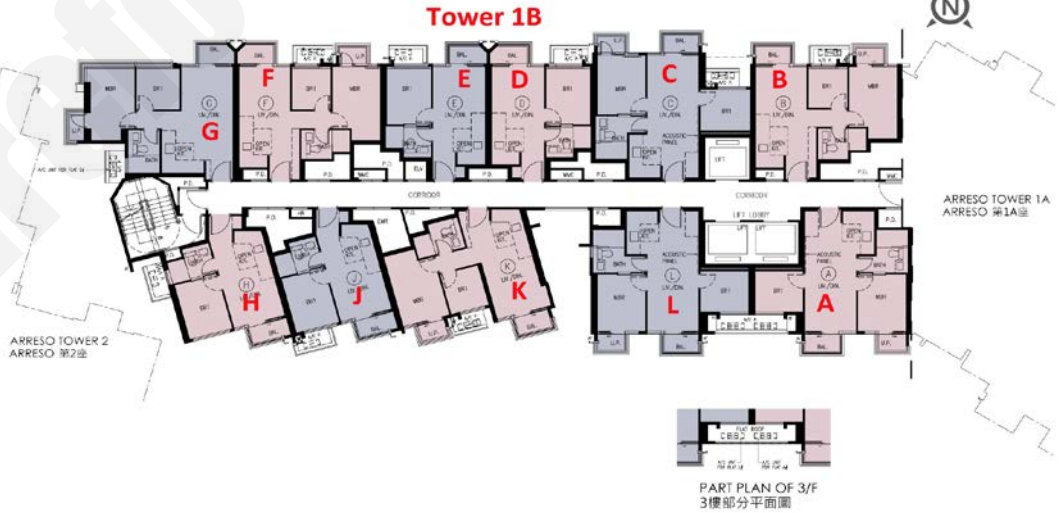

1B座C: 1房 454'		
樓層	訂價	折實價15%
22	\$7,244,000 @\$15,956	\$6,157,400 @\$13,563
21	\$7,225,000 @\$15,914	\$6,141,250 @\$13,527
20	\$7,206,000 @\$15,872	\$6,125,100 @\$13,491
19	\$7,192,000 @\$15,841	\$6,113,200 @\$13,465
18	\$7,192,000 @\$15,841	\$6,113,200 @\$13,465
17	\$7,162,000 @\$15,775	\$6,087,700 @\$13,409
16	\$7,148,000 @\$15,744	\$6,075,800 @\$13,383
15	\$7,134,000 @\$15,714	\$6,063,900 @\$13,357
12	\$7,120,000 @\$15,683	\$6,052,000 @\$13,330
11	\$7,105,000 @\$15,650	\$6,039,250 @\$13,302
10	\$7,092,000 @\$15,621	\$6,028,200 @\$13,278
9	\$7,078,000 @\$15,590	\$6,016,300 @\$13,252
8	\$7,078,000 @\$15,590	\$6,016,300 @\$13,252
7	\$7,049,000 @\$15,526	\$5,991,650 @\$13,197
6	\$7,035,000 @\$15,496	\$5,979,750 @\$13,171
5	\$7,021,000 @\$15,465	\$5,967,850 @\$13,145
3	\$7,007,000 @\$15,434	\$5,955,950 @\$13,119

1B座H: 1房 305'		
樓層	訂價	折實價15%
12	\$5,094,000 @\$16,702	<b>\$4,329,900</b> <b>@\$14,196</b>
11	\$5,084,000 @\$16,669	\$4,321,400 @\$14,169
8	\$5,064,000 @\$16,603	\$4,304,400 @\$14,113
7	\$5,044,000 @\$16,538	\$4,287,400 @\$14,057
3	\$5,006,000 @\$16,413	<b>\$4,255,100</b> <b>@\$13,951</b>

紅色為最高售價、最高平均呎價；藍色為最低售價、最低平均呎價

2座A1: 3房連套房 703'		
樓層	訂價	折實價15%
33	\$11,145,000 @\$15,853	\$9,473,250 @\$13,475
32	\$11,129,000 @\$15,831	\$9,459,650 @\$13,456
31	\$11,114,000 @\$15,809	\$9,446,900 @\$13,438
30	\$11,099,000 @\$15,788	\$9,434,150 @\$13,420
29	\$11,084,000 @\$15,767	\$9,421,400 @\$13,402
28	\$11,084,000 @\$15,767	\$9,421,400 @\$13,402
27	\$11,053,000 @\$15,723	\$9,395,050 @\$13,364
26	\$11,038,000 @\$15,701	\$9,382,300 @\$13,346
25	\$11,022,000 @\$15,679	\$9,368,700 @\$13,327
23	\$11,006,000 @\$15,656	\$9,355,100 @\$13,307
22	\$10,991,000 @\$15,634	\$9,342,350 @\$13,289
21	\$10,975,000 @\$15,612	\$9,328,750 @\$13,270
20	\$10,960,000 @\$15,590	\$9,316,000 @\$13,252
18	\$10,951,000 @\$15,578	\$9,308,350 @\$13,241
17	\$10,908,000 @\$15,516	\$9,271,800 @\$13,189
16	\$10,886,000 @\$15,485	\$9,253,100 @\$13,162
15	\$10,864,000 @\$15,454	\$9,234,400 @\$13,136
12	\$10,842,000 @\$15,422	\$9,215,700 @\$13,109
11	\$10,820,000 @\$15,391	\$9,197,000 @\$13,083
10	\$10,799,000 @\$15,361	\$9,179,150 @\$13,057
9	\$10,776,000 @\$15,329	\$9,159,600 @\$13,029
8	\$10,776,000 @\$15,329	\$9,159,600 @\$13,029
7	\$10,760,000 @\$15,306	\$9,146,000 @\$13,010
6	\$10,754,000 @\$15,297	\$9,140,900 @\$13,003
5	\$10,725,000 @\$15,256	\$9,116,250 @\$12,968
3	\$10,678,000 @\$15,189	\$9,076,300 @\$12,911



紅色為最高售價、最高平均呎價；藍色為最低售價、最低平均呎價