

新盤價單表

KOKO Rosso

價單1號

以最高12%折扣計算
制作日期: 2023-02-16

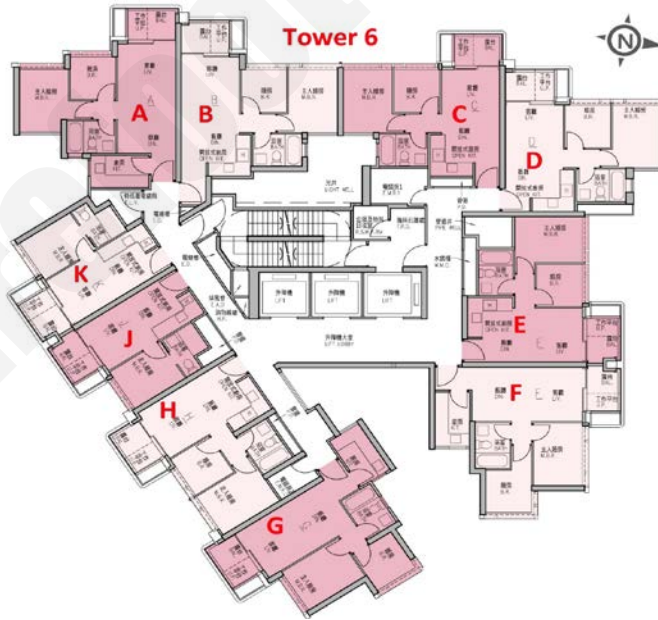

H: 2房 424'		
樓層	訂價	折實價12%
23	\$8,854,000 @\$20,882	\$7,791,520 @\$18,376
22	\$8,818,000 @\$20,797	\$7,759,840 @\$18,302
21	\$8,783,000 @\$20,715	\$7,729,040 @\$18,229
20	\$8,749,000 @\$20,634	\$7,699,120 @\$18,158
19	\$8,713,000 @\$20,550	\$7,667,440 @\$18,084
18	\$8,679,000 @\$20,469	\$7,637,520 @\$18,013
17	\$8,609,000 @\$20,304	\$7,575,920 @\$17,868
16	\$8,576,000 @\$20,226	\$7,546,880 @\$17,799
15	\$8,541,000 @\$20,144	\$7,516,080 @\$17,727
12	\$8,508,000 @\$20,066	\$7,487,040 @\$17,658
11	\$8,474,000 @\$19,986	\$7,457,120 @\$17,588
10	\$8,442,000 @\$19,910	\$7,428,960 @\$17,521
9	\$8,410,000 @\$19,835	\$7,400,800 @\$17,455
8	\$8,378,000 @\$19,759	\$7,372,640 @\$17,388
7	\$8,323,000 @\$19,630	\$7,324,240 @\$17,274
6	\$8,294,000 @\$19,561	\$7,298,720 @\$17,210
5	\$8,266,000 @\$19,495	\$7,274,080 @\$17,156
J: 1房 300'		
樓層	訂價	折實價12%
12	\$6,507,000 @\$21,690	\$5,726,160 @\$19,087
11	\$6,482,000 @\$21,607	\$5,704,160 @\$19,014
10	\$6,456,000 @\$21,520	\$5,681,280 @\$18,938
9	\$6,432,000 @\$21,440	\$5,660,160 @\$18,867
8	\$6,408,000 @\$21,360	\$5,639,040 @\$18,797
7	\$6,366,000 @\$21,220	\$5,602,080 @\$18,674
6	\$6,345,000 @\$21,150	\$5,583,600 @\$18,612
5	\$6,323,000 @\$21,077	\$5,564,240 @\$18,547
3	\$6,301,000 @\$21,003	\$5,544,880 @\$18,483
K: 1房 310'		
樓層	訂價	折實價12%
11	\$6,631,000 @\$21,390	\$5,835,280 @\$18,823
10	\$6,606,000 @\$21,310	\$5,813,280 @\$18,753
9	\$6,581,000 @\$21,229	\$5,791,280 @\$18,682
8	\$6,556,000 @\$21,148	\$5,769,280 @\$18,611
7	\$6,515,000 @\$21,016	\$5,733,200 @\$18,494
6	\$6,492,000 @\$20,942	\$5,712,960 @\$18,429
5	\$6,469,000 @\$20,868	\$5,692,720 @\$18,364
3	\$6,448,000 @\$20,800	\$5,674,240 @\$18,304
2	\$6,427,000 @\$20,732	\$5,655,760 @\$18,244

G: 1房 475'		
樓層	訂價	折實價12%
20	\$9,923,000 @\$20,891	\$8,732,240 @\$18,384
19	\$9,883,000 @\$20,806	\$8,697,040 @\$18,310
18	\$9,843,000 @\$20,722	\$8,661,840 @\$18,235
17	\$9,766,000 @\$20,560	\$8,594,080 @\$18,093
16	\$9,726,000 @\$20,476	\$8,558,880 @\$18,019
15	\$9,688,000 @\$20,396	\$8,525,440 @\$17,948
12	\$9,649,000 @\$20,314	\$8,491,120 @\$17,876
11	\$9,611,000 @\$20,234	\$8,457,680 @\$17,806
10	\$9,573,000 @\$20,154	\$8,424,240 @\$17,735
9	\$9,538,000 @\$20,080	\$8,393,440 @\$17,670
8	\$9,503,000 @\$20,006	\$8,362,640 @\$17,606
7	\$9,440,000 @\$19,874	\$8,307,200 @\$17,489
6	\$9,408,000 @\$19,806	\$8,279,040 @\$17,430
5	\$9,376,000 @\$19,739	\$8,250,880 @\$17,370
C: 2房 426'		
樓層	訂價	折實價12%
9	\$8,972,000 @\$21,061	\$7,895,360 @\$18,534
8	\$8,947,000 @\$21,002	\$7,873,360 @\$18,482
7	\$8,892,000 @\$20,873	\$7,824,960 @\$18,368
6	\$8,865,000 @\$20,810	\$7,801,200 @\$18,313
5	\$8,840,000 @\$20,751	\$7,779,200 @\$18,261
3	\$8,812,000 @\$20,685	\$7,754,560 @\$18,203
2	\$8,608,000 @\$20,207	\$7,575,040 @\$17,782
1	\$8,582,000 @\$20,146	\$7,552,160 @\$17,728

E: 2房 424'		
樓層	訂價	折實價12%
20	\$8,806,000 @\$20,769	\$7,749,280 @\$18,277
19	\$8,789,000 @\$20,729	\$7,734,320 @\$18,241
18	\$8,762,000 @\$20,665	\$7,710,560 @\$18,185
17	\$8,710,000 @\$20,542	\$7,664,800 @\$18,077
16	\$8,684,000 @\$20,481	\$7,641,920 @\$18,023
15	\$8,659,000 @\$20,422	\$7,619,920 @\$17,972
12	\$8,632,000 @\$20,358	\$7,596,160 @\$17,915
11	\$8,607,000 @\$20,300	\$7,574,160 @\$17,864
10	\$8,580,000 @\$20,236	\$7,550,400 @\$17,808
9	\$8,555,000 @\$20,177	\$7,528,400 @\$17,756
8	\$8,530,000 @\$20,118	\$7,506,400 @\$17,704
7	\$8,479,000 @\$19,998	\$7,461,520 @\$17,598
6	\$8,453,000 @\$19,936	\$7,438,640 @\$17,544
5	\$8,428,000 @\$19,877	\$7,416,640 @\$17,492
3	\$8,403,000 @\$19,818	\$7,394,640 @\$17,440
2	\$8,398,000 @\$19,807	\$7,390,240 @\$17,430
D: 2房 433'		
樓層	訂價	折實價12%
9	\$8,972,000 @\$21,061	\$7,895,360 @\$18,534
8	\$8,947,000 @\$21,002	\$7,873,360 @\$18,482
7	\$8,892,000 @\$20,873	\$7,824,960 @\$18,368
6	\$8,865,000 @\$20,810	\$7,801,200 @\$18,313

F: 2房 497'		
樓層	訂價	折實價12%
16	\$10,204,000 @\$20,531	\$8,979,520 @\$18,067
15	\$10,174,000 @\$20,471	\$8,953,120 @\$18,014
12	\$10,144,000 @\$20,410	\$8,926,720 @\$17,961
11	\$10,114,000 @\$20,350	\$8,900,320 @\$17,908
10	\$10,084,000 @\$20,290	\$8,873,920 @\$17,855
9	\$10,053,000 @\$20,227	\$8,846,640 @\$17,800
8	\$10,023,000 @\$20,167	\$8,820,240 @\$17,747
7	\$9,963,000 @\$20,046	\$8,767,440 @\$17,641
6	\$9,933,000 @\$19,986	\$8,741,040 @\$17,588
5	\$9,903,000 @\$19,926	\$8,714,640 @\$17,534
3	\$9,874,000 @\$19,867	\$8,689,120 @\$17,483

紅色為最高售價、最高平均呎價；藍色為最低售價、最低平均呎價

以上的物業資料只供參考，一切以發展商最新公布為準，如有任何資料錯漏本網頁不會承擔任何責任。