

新盤價單表

University Hill

價單1號

以最高15%折扣計算
制作日期: 2023-04-19

Tower 1

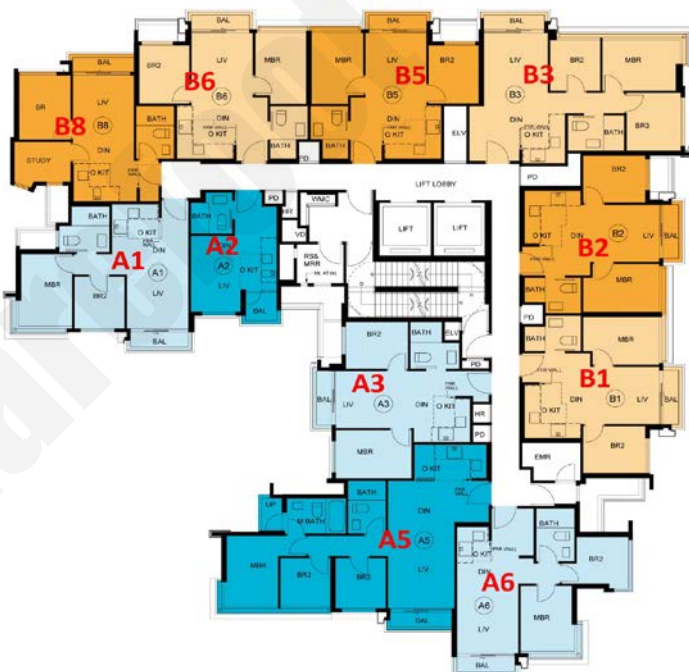

T1 B6 : 2房 384'/405'/406'

樓層	訂價	折實價15%
12	\$9,067,500 @\$22,334	\$7,707,375 @\$18,984
11	\$8,714,000 @\$21,516	\$7,406,900 @\$18,289
10	\$8,662,000 @\$21,388	\$7,362,700 @\$18,180
9	\$8,610,500 @\$21,260	\$7,318,925 @\$18,071
5	\$8,524,800 @\$21,049	\$7,246,080 @\$17,892
3	\$8,507,700 @\$21,007	\$7,231,545 @\$17,856
2	\$8,273,200 @\$20,428	\$7,032,220 @\$17,364
1	\$8,183,500 @\$21,311	\$6,955,975 @\$18,115

T1 B1 : 2房 391'/411'/413'

樓層	訂價	折實價15%
12	\$8,403,300 @\$20,446	\$7,142,805 @\$17,379
11	\$7,996,500 @\$19,362	\$6,797,025 @\$16,458
10	\$7,948,800 @\$19,246	\$6,756,480 @\$16,360
9	\$7,901,400 @\$19,132	\$6,716,190 @\$16,262
8	\$7,869,900 @\$19,055	\$6,689,415 @\$16,197
7	\$7,854,200 @\$19,017	\$6,676,070 @\$16,165
6	\$7,838,400 @\$18,979	\$6,662,640 @\$16,132
5	\$7,822,800 @\$18,941	\$6,649,380 @\$16,100
3	\$7,807,200 @\$18,904	\$6,636,120 @\$16,068
2	\$7,738,600 @\$18,738	\$6,577,810 @\$15,927
1	\$7,869,900 @\$20,128	\$6,689,415 @\$17,108

T1 A6 : 2房 406'/428'

樓層	訂價	折實價15%
11	\$8,154,100 @\$19,052	\$6,930,985 @\$16,194
10	\$8,089,400 @\$18,900	\$6,875,990 @\$16,065
9	\$8,041,200 @\$18,788	\$6,835,020 @\$15,970
8	\$8,009,200 @\$18,713	\$6,807,820 @\$15,906
7	\$7,993,200 @\$18,676	\$6,794,220 @\$15,874
6	\$7,977,200 @\$18,638	\$6,780,620 @\$15,843
5	\$7,961,300 @\$18,601	\$6,767,105 @\$15,811
3	\$7,835,600 @\$18,307	\$6,660,260 @\$15,561
2	\$7,645,900 @\$17,864	\$6,499,015 @\$15,185
1	\$7,879,000 @\$19,406	\$6,697,150 @\$16,495

T1 A5 : 3房連套房 640'

樓層	訂價	折實價15%
11	\$13,113,900 @\$20,490	\$11,146,815 @\$17,417
10	\$13,009,800 @\$20,328	\$11,058,330 @\$17,279
9	\$12,932,300 @\$20,207	\$10,992,455 @\$17,176
3	\$12,388,000 @\$19,356	\$10,529,800 @\$16,453
2	\$12,092,000 @\$18,894	\$10,278,200 @\$16,060

T1 B5 : 2房 385'/407'

樓層	訂價	折實價15%
9	\$8,610,500 @\$21,156	\$7,318,925 @\$17,983
8	\$8,576,000 @\$21,071	\$7,289,600 @\$17,911
7	\$8,559,000 @\$21,029	\$7,275,150 @\$17,875
6	\$8,541,900 @\$20,987	\$7,260,615 @\$17,839
5	\$8,524,800 @\$20,945	\$7,246,080 @\$17,804
3	\$8,507,700 @\$20,903	\$7,231,545 @\$17,768
2	\$8,428,300 @\$20,708	\$7,164,055 @\$17,602
1	\$8,338,000 @\$21,657	\$7,087,300 @\$18,409

紅色為最高售價、最高平均呎價；藍色為最低售價、最低平均呎價

以上的物業資料只供參考，一切以發展商最新公布為準，如有任何資料錯漏本網頁不會承擔任何責任。

新盤價單表

University Hill

價單1號

以最高15%折扣計算
制作日期: 2023-04-19

Tower 2

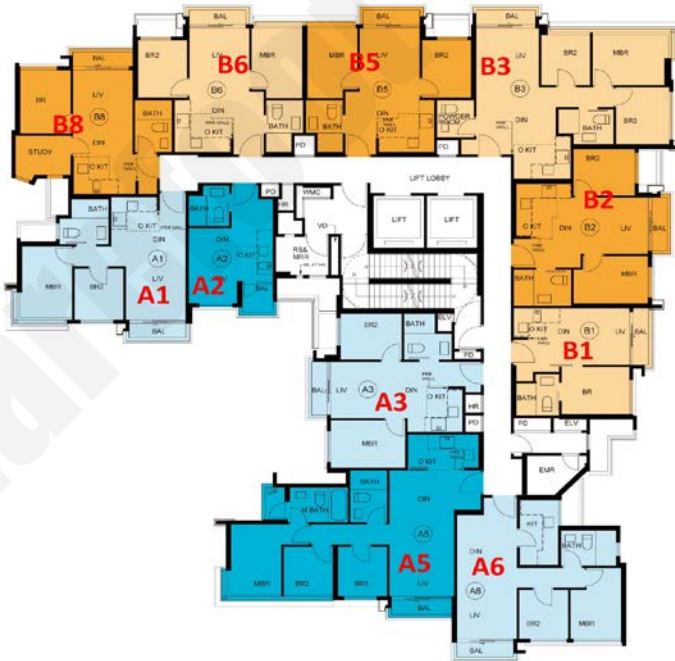

T2 B8 : 1房 353/376'		
樓層	訂價	折實價15%
12	\$7,707,300 @\$20,498	\$6,551,205 @\$17,423
11	\$7,271,000 @\$19,338	\$6,180,350 @\$16,437
10	\$7,227,700 @\$19,223	\$6,143,545 @\$16,339
9	\$7,184,500 @\$19,108	\$6,106,825 @\$16,242
8	\$7,156,000 @\$19,032	\$6,082,600 @\$16,177
7	\$7,141,600 @\$18,994	\$6,070,360 @\$16,145
6	\$7,127,300 @\$18,956	\$6,058,205 @\$16,112
5	\$6,749,200 @\$17,950	\$5,736,820 @\$15,258
3	\$6,690,700 @\$17,794	\$5,687,095 @\$15,125
2	\$6,573,500 @\$17,483	\$5,587,475 @\$14,860
1	\$6,603,300 @\$18,706	\$5,612,805 @\$15,900

T2 B6 : 2房 384/405/406'		
樓層	訂價	折實價15%
12	\$8,335,800 @\$20,532	\$7,085,430 @\$17,452
11	\$8,038,400 @\$19,848	\$6,832,640 @\$16,871
10	\$7,990,900 @\$19,731	\$6,792,265 @\$16,771
9	\$7,906,800 @\$19,523	\$6,720,780 @\$16,595
8	\$7,875,400 @\$19,445	\$6,694,090 @\$16,529
7	\$7,859,800 @\$19,407	\$6,680,830 @\$16,496
6	\$7,807,400 @\$19,278	\$6,636,290 @\$16,386
5	\$7,393,100 @\$18,255	\$6,284,135 @\$15,516
3	\$7,330,800 @\$18,101	\$6,231,180 @\$15,386
2	\$7,207,800 @\$17,797	\$6,126,630 @\$15,127
1	\$7,039,100 @\$18,331	\$5,983,235 @\$15,581

T2 B5 : 2房 384/406'		
樓層	訂價	折實價15%
11	\$8,177,800 @\$20,142	\$6,951,130 @\$17,121
10	\$8,129,700 @\$20,024	\$6,910,245 @\$17,020
9	\$8,020,500 @\$19,755	\$6,817,425 @\$16,792
8	\$7,988,800 @\$19,677	\$6,790,480 @\$16,725
7	\$7,973,000 @\$19,638	\$6,777,050 @\$16,692
6	\$7,895,700 @\$19,448	\$6,711,345 @\$16,530
5	\$7,441,600 @\$18,329	\$6,325,360 @\$15,580
3	\$7,356,100 @\$18,118	\$6,252,685 @\$15,401
2	\$7,289,500 @\$17,954	\$6,196,075 @\$15,261
1	\$7,101,300 @\$18,493	\$6,036,105 @\$15,719

T2 B3 : 3房 580'		
樓層	訂價	折實價15%
11	\$11,745,200 @\$20,250	\$9,983,420 @\$17,213
10	\$11,675,100 @\$20,129	\$9,923,835 @\$17,110
9	\$11,605,600 @\$20,010	\$9,864,760 @\$17,008
8	\$11,435,800 @\$19,717	\$9,720,430 @\$16,759
7	\$11,413,100 @\$19,678	\$9,701,135 @\$16,726
6	\$11,390,300 @\$19,638	\$9,681,755 @\$16,693
5	\$10,785,900 @\$18,596	\$9,168,015 @\$15,807
3	\$10,669,200 @\$18,395	\$9,068,820 @\$15,636
2	\$10,509,900 @\$18,121	\$8,933,415 @\$15,402

紅色為最高售價、最高平均呎價；藍色為最低售價、最低平均呎價

以上的物業資料只供參考，一切以發展商最新公布為準，如有任何資料錯漏本網頁不會承擔任何責任。

新盤價單表

University Hill

價單1號

以最高15%折扣計算
制作日期: 2023-04-19



T5A A1 : 2房 441'/463'		
樓層	訂價	折實價15%
15	\$9,240,200 @\$19,957	\$7,854,170 @\$16,964
12	\$8,981,600 @\$19,399	\$7,634,360 @\$16,489
11	\$8,928,600 @\$19,284	\$7,589,310 @\$16,392
10	\$8,789,200 @\$18,983	\$7,470,820 @\$16,136
9	\$8,737,500 @\$18,871	\$7,426,875 @\$16,041
8	\$8,702,800 @\$18,797	\$7,397,380 @\$15,977
7	\$8,597,600 @\$18,569	\$7,307,960 @\$15,784
6	\$8,580,500 @\$18,532	\$7,293,425 @\$15,753
5	\$8,477,600 @\$18,310	\$7,205,960 @\$15,564
3	\$8,341,400 @\$18,016	\$7,090,190 @\$15,314
2	\$8,009,200 @\$17,298	\$6,807,820 @\$14,704
1	\$8,204,300 @\$18,604	\$6,973,655 @\$15,813

T5A A2 : 2房 427'/450'		
樓層	訂價	折實價16%
10	\$8,028,600 @\$17,841	\$6,824,310 @\$15,165
9	\$7,981,200 @\$17,736	\$6,784,020 @\$15,076
6	\$7,856,300 @\$17,458	\$6,677,855 @\$14,840
5	\$7,761,900 @\$17,249	\$6,597,615 @\$14,661
3	\$7,640,800 @\$16,980	\$6,494,680 @\$14,433
2	\$7,409,200 @\$16,465	\$6,297,820 @\$13,995
1	\$7,557,700 @\$17,700	\$6,424,045 @\$15,045

T5B A1 : 1房 273'/297'		
樓層	訂價	折實價15%
15	\$6,750,900 @\$22,730	\$5,738,265 @\$19,321
12	\$6,303,500 @\$21,224	\$5,357,975 @\$18,040
11	\$6,119,800 @\$20,605	\$5,201,830 @\$17,515
10	\$5,692,700 @\$19,167	\$4,838,795 @\$16,292
9	\$5,616,500 @\$18,911	\$4,774,025 @\$16,074
8	\$5,594,100 @\$18,835	\$4,754,985 @\$16,010
7	\$5,547,800 @\$18,679	\$4,715,630 @\$15,878
6	\$5,536,700 @\$18,642	\$4,706,195 @\$15,846
5	\$5,444,800 @\$18,333	\$4,628,080 @\$15,583
3	\$5,325,100 @\$17,930	\$4,526,335 @\$15,240
2	\$5,144,000 @\$17,320	\$4,372,400 @\$14,722
1	\$5,311,900 @\$19,458	\$4,515,115 @\$16,539

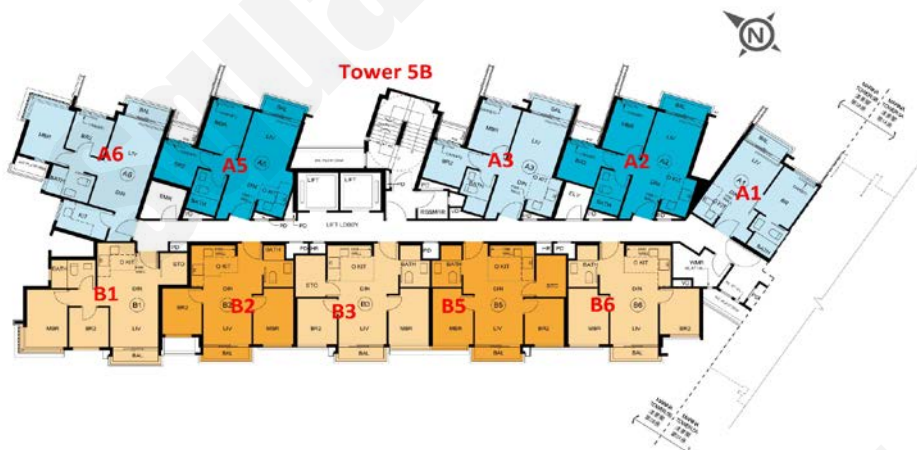

T5B A5 : 2房 415'		
樓層	訂價	折實價15%
11	\$8,346,800 @\$20,113	\$7,094,780 @\$17,096
10	\$7,619,500 @\$18,360	\$6,476,575 @\$15,606
9	\$7,521,800 @\$18,125	\$6,393,530 @\$15,406
8	\$7,450,400 @\$17,953	\$6,332,840 @\$15,260
7	\$7,340,900 @\$17,689	\$6,239,765 @\$15,036
6	\$7,221,500 @\$17,401	\$6,138,275 @\$14,791
5	\$7,044,800 @\$16,975	\$5,988,080 @\$14,429
3	\$6,790,000 @\$16,361	\$5,771,500 @\$13,907
2	\$6,599,900 @\$15,903	\$5,609,915 @\$13,518

紅色為最高售價、最高平均呎價；藍色為最低售價、最低平均呎價

以上的物業資料只供參考，一切以發展商最新公布為準，如有任何資料錯漏本網頁不會承擔任何責任。