

新盤價單表

連方 I

價單1號

以最高16%折扣計算

制作日期: 2022-11-07



F: 1房 292'		
樓層	訂價	折實價16%
16	\$7,111,000 @\$24,353	\$5,973,240 @\$20,456
15	\$7,079,000 @\$24,243	\$5,946,360 @\$20,364
12	\$7,044,000 @\$24,123	\$5,916,960 @\$20,264
11	\$7,020,000 @\$24,041	\$5,896,800 @\$20,195
10	\$6,835,000 @\$23,408	\$5,741,400 @\$19,662
9	\$6,742,000 @\$23,089	\$5,663,280 @\$19,395
8	\$6,680,000 @\$22,877	\$5,611,200 @\$19,216
7	\$6,576,000 @\$22,521	\$5,523,840 @\$18,917
6	\$6,503,000 @\$22,271	\$5,462,520 @\$18,707
5	\$6,369,000 @\$21,812	\$5,349,960 @\$18,322

E: 開放式 266'		
樓層	訂價	折實價16%
16	\$6,608,000 @\$24,842	\$5,550,720 @\$20,867
15	\$6,559,000 @\$24,658	\$5,509,560 @\$20,713
12	\$6,508,000 @\$24,466	\$5,466,720 @\$20,552
11	\$6,467,000 @\$24,312	\$5,432,280 @\$20,422
10	\$6,290,000 @\$23,647	\$5,283,600 @\$19,863
9	\$6,230,000 @\$23,421	\$5,233,200 @\$19,674
8	\$6,140,000 @\$23,083	\$5,157,600 @\$19,389
7	\$6,061,000 @\$22,786	\$5,091,240 @\$19,140
6	\$5,966,000 @\$22,429	\$5,011,440 @\$18,840
5	\$5,866,000 @\$22,053	\$4,927,440 @\$18,524

A: 開放式 232'		
樓層	訂價	折實價16%
15	\$5,615,000 @\$24,203	\$4,716,600 @\$20,330
12	\$5,514,000 @\$23,767	\$4,631,760 @\$19,964
11	\$5,434,000 @\$23,422	\$4,564,560 @\$19,675
10	\$5,355,000 @\$23,082	\$4,498,200 @\$19,389
9	\$5,258,000 @\$22,664	\$4,416,720 @\$19,038
8	\$5,214,000 @\$22,474	\$4,379,760 @\$18,878
7	\$5,117,000 @\$22,056	\$4,298,280 @\$18,527
6	\$5,038,000 @\$21,716	\$4,231,920 @\$18,241
5	\$4,952,000 @\$21,345	\$4,159,680 @\$17,930

B: 2房 401'		
樓層	訂價	折實價16%
12	\$9,309,000 @\$23,214	\$7,819,560 @\$19,500
11	\$9,122,000 @\$22,748	\$7,662,480 @\$19,108
10	\$8,970,000 @\$22,369	\$7,534,800 @\$18,790
9	\$8,846,000 @\$22,060	\$7,430,640 @\$18,530
8	\$8,747,000 @\$21,813	\$7,347,480 @\$18,323
7	\$8,601,000 @\$21,449	\$7,224,840 @\$18,017
6	\$8,494,000 @\$21,182	\$7,134,960 @\$17,793
5	\$8,332,000 @\$20,778	\$6,998,880 @\$17,454
G: 1房 293'		
樓層	訂價	折實價16%
10	\$6,926,000 @\$23,638	\$5,817,840 @\$19,856
9	\$6,861,000 @\$23,416	\$5,763,240 @\$19,670
8	\$6,800,000 @\$23,208	\$5,712,000 @\$19,495
7	\$6,719,000 @\$22,932	\$5,643,960 @\$19,263
6	\$6,622,000 @\$22,601	\$5,562,480 @\$18,985
5	\$6,467,000 @\$22,072	\$5,432,280 @\$18,540

C: 1房 290'		
樓層	訂價	折實價16%
11	\$6,934,000 @\$23,910	\$5,824,560 @\$20,085
10	\$6,740,000 @\$23,241	\$5,661,600 @\$19,523
9	\$6,627,000 @\$22,852	\$5,566,680 @\$19,195
8	\$6,566,000 @\$22,641	\$5,515,440 @\$19,019
7	\$6,464,000 @\$22,290	\$5,429,760 @\$18,723
6	\$6,392,000 @\$22,041	\$5,369,280 @\$18,515
5	\$6,259,000 @\$21,583	\$5,257,560 @\$18,130

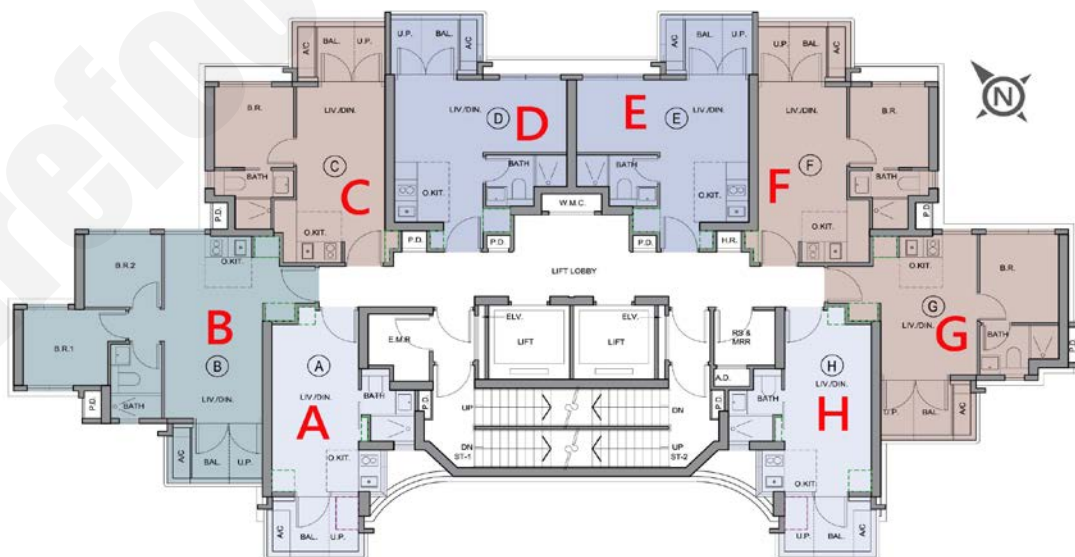

紅色為最高售價、最高平均呎價；藍色為最低售價、最低平均呎價

以上的物業資料只供參考，一切以發展商最新公布為準，如有任何資料錯漏本網頁不會承擔任何責任。