

B5 : 2房 438'		
樓層	訂價	即供價17.5%
9	\$7,638,500 @\$17,439	\$6,301,763 @\$14,388
8	\$7,430,500 @\$16,965	\$6,130,163 @\$13,996
7	\$7,263,400 @\$16,583	\$5,992,305 @\$13,681
6	\$7,248,900 @\$16,550	\$5,980,343 @\$13,654
5	\$7,234,400 @\$16,517	\$5,968,380 @\$13,626
3	\$7,205,500 @\$16,451	\$5,944,538 @\$13,572
2	\$7,147,900 @\$16,319	\$5,897,018 @\$13,464
1	\$7,004,900 @\$15,993	\$5,779,043 @\$13,194

B2 : 2房 430'		
樓層	訂價	即供價17.5%
9	\$7,518,900 @\$17,486	\$6,203,093 @\$14,426
8	\$7,314,100 @\$17,010	\$6,034,133 @\$14,033
7	\$7,149,700 @\$16,627	\$5,898,503 @\$13,717
6	\$7,135,400 @\$16,594	\$5,886,705 @\$13,690
5	\$7,121,100 @\$16,561	\$5,874,908 @\$13,663
3	\$7,092,600 @\$16,494	\$5,851,395 @\$13,608
2	\$7,035,900 @\$16,363	\$5,804,618 @\$13,499
1	\$6,895,200 @\$16,035	\$5,688,540 @\$13,229

A2 : 3房 520'		
樓層	訂價	即供價17.5%
9	\$8,702,300 @\$16,735	\$7,179,398 @\$13,807
8	\$8,633,300 @\$16,603	\$7,122,473 @\$13,697
7	\$8,564,700 @\$16,471	\$7,065,878 @\$13,588
6	\$8,547,600 @\$16,438	\$7,051,770 @\$13,561
5	\$8,530,500 @\$16,405	\$7,037,663 @\$13,534
3	\$8,496,400 @\$16,339	\$7,009,530 @\$13,480
2	\$8,428,400 @\$16,208	\$6,953,430 @\$13,372

B5 : 2房 438'		
樓層	訂價	即供價17.5%
9	\$7,277,700 @\$16,616	\$6,004,103 @\$13,708
8	\$7,219,900 @\$16,484	\$5,956,418 @\$13,599
7	\$7,162,600 @\$16,353	\$5,909,145 @\$13,491
6	\$7,148,300 @\$16,320	\$5,897,348 @\$13,464
5	\$7,134,000 @\$16,288	\$5,885,550 @\$13,437
3	\$7,105,500 @\$16,223	\$5,862,038 @\$13,384
2	\$7,048,700 @\$16,093	\$5,815,178 @\$13,277
1	\$6,907,700 @\$15,771	\$5,698,853 @\$13,011

B3 : 2房及多用途房 447'		
樓層	訂價	即供價17.5%
9	\$7,547,900 @\$16,886	\$6,227,018 @\$13,931
8	\$7,488,000 @\$16,752	\$6,177,600 @\$13,820
7	\$7,428,500 @\$16,619	\$6,128,513 @\$13,710
6	\$7,413,700 @\$16,585	\$6,116,303 @\$13,683
5	\$7,398,900 @\$16,552	\$6,104,093 @\$13,656
3	\$7,369,300 @\$16,486	\$6,079,673 @\$13,601
2	\$7,310,300 @\$16,354	\$6,030,998 @\$13,492
1	\$7,164,100 @\$16,027	\$5,910,383 @\$13,222

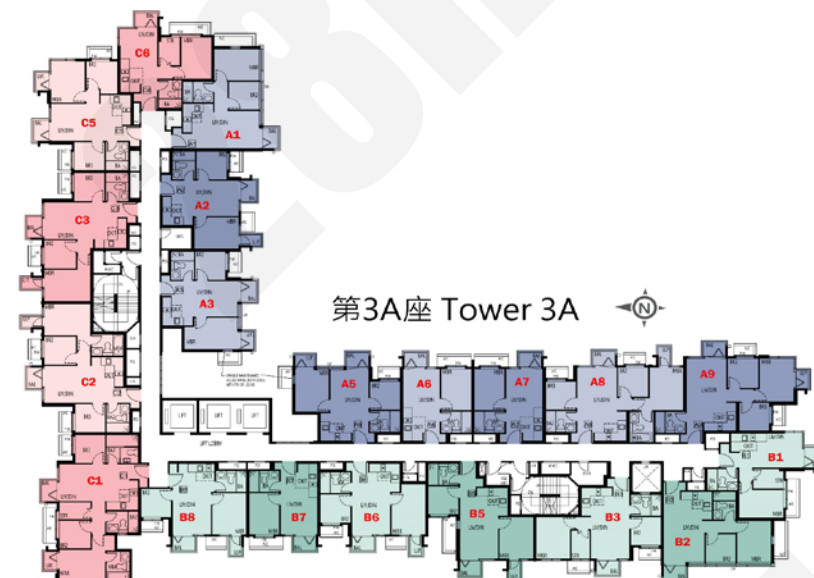

B2 : 2房 430'		
樓層	訂價	即供價17.5%
9	\$7,191,500 @\$16,724	\$5,932,988 @\$13,798
8	\$7,134,400 @\$16,592	\$5,885,880 @\$13,688
7	\$7,077,800 @\$16,460	\$5,839,185 @\$13,580
6	\$7,063,600 @\$16,427	\$5,827,470 @\$13,552
5	\$7,049,500 @\$16,394	\$5,815,838 @\$13,525
3	\$7,021,300 @\$16,329	\$5,792,573 @\$13,471
2	\$6,965,100 @\$16,198	\$5,746,208 @\$13,363
1	\$6,825,800 @\$15,874	\$5,631,285 @\$13,096

B6 : 2房 419'		
樓層	訂價	即供價17.5%
9	\$7,473,200 @\$17,836	\$6,165,390 @\$14,715

紅色為最高售價、最高平均呎價；藍色為最低售價、最低平均呎價

以上的物業資料只供參考，一切以發展商最新公布為準，如有任何資料錯漏本網頁不會承擔任何責任。

C7: 2房 430'		
樓層	訂價	即供價17.5%
9	\$7,720,600 @\$17,955	\$6,369,495 @\$14,813
8	\$7,495,700 @\$17,432	\$6,183,953 @\$14,381
6	\$7,108,100 @\$16,530	\$5,864,183 @\$13,638
5	\$7,093,900 @\$16,497	\$5,852,468 @\$13,610
3	\$7,065,500 @\$16,431	\$5,829,038 @\$13,556
2	\$7,009,000 @\$16,300	\$5,782,425 @\$13,448
1	\$6,868,800 @\$15,974	\$5,666,760 @\$13,179
C6: 2房及多用途房 447'		
樓層	訂價	即供價17.5%
9	\$8,181,700 @\$18,304	\$6,749,903 @\$15,100
8	\$7,928,000 @\$17,736	\$6,540,600 @\$14,632
7	\$7,593,800 @\$16,988	\$6,264,885 @\$14,015
6	\$7,489,000 @\$16,754	\$6,178,425 @\$13,822
5	\$7,474,000 @\$16,720	\$6,166,050 @\$13,794
3	\$7,444,100 @\$16,653	\$6,141,383 @\$13,739
2	\$7,384,600 @\$16,520	\$6,092,295 @\$13,629
1	\$7,236,900 @\$16,190	\$5,970,443 @\$13,357
C5: 2房 438'		
樓層	訂價	即供價17.5%
9	\$8,062,200 @\$18,407	\$6,651,315 @\$15,186
8	\$7,797,100 @\$17,802	\$6,432,608 @\$14,686
6	\$7,199,500 @\$16,437	\$5,939,588 @\$13,561
5	\$7,185,100 @\$16,404	\$5,927,708 @\$13,534
3	\$7,156,400 @\$16,339	\$5,904,030 @\$13,480
2	\$7,099,100 @\$16,208	\$5,856,758 @\$13,372
1	\$6,957,200 @\$15,884	\$5,739,690 @\$13,104

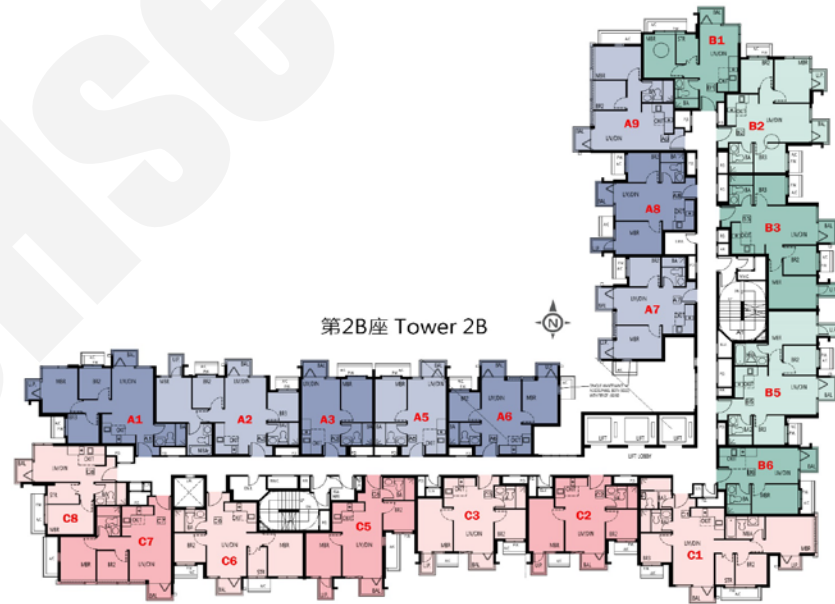

C1: 3房連套房及多用途房 673'		
樓層	訂價	即供價17.5%
9	\$12,032,600 @\$17,879	\$9,926,895 @\$14,750
8	\$11,481,500 @\$17,060	\$9,472,238 @\$14,075
7	\$10,750,400 @\$15,974	\$8,869,080 @\$13,178
6	\$10,519,000 @\$15,630	\$8,678,175 @\$12,895
5	\$10,498,000 @\$15,599	\$8,660,850 @\$12,869
3	\$10,456,000 @\$15,536	\$8,626,200 @\$12,818
2	\$10,372,400 @\$15,412	\$8,557,230 @\$12,715
1	\$10,164,900 @\$15,104	\$8,386,043 @\$12,461
B3: 3房 518'		
樓層	訂價	即供價17.5%
9	\$9,225,900 @\$17,811	\$7,611,368 @\$14,694
8	\$8,974,700 @\$17,326	\$7,404,128 @\$14,294
6	\$8,222,300 @\$15,873	\$6,783,398 @\$13,095
5	\$8,205,900 @\$15,842	\$6,769,868 @\$13,069
3	\$8,173,100 @\$15,778	\$6,742,808 @\$13,017
2	\$8,107,700 @\$15,652	\$6,688,853 @\$12,913
1	\$7,945,500 @\$15,339	\$6,555,038 @\$12,655

B6: 1房 300'		
樓層	訂價	即供價17.5%
9	\$6,638,700 @\$22,129	\$5,476,928 @\$18,256
8	\$6,334,600 @\$21,115	\$5,226,045 @\$17,420
7	\$5,924,900 @\$19,750	\$4,888,043 @\$16,293
6	\$5,708,000 @\$19,027	\$4,709,100 @\$15,697
5	\$5,696,600 @\$18,989	\$4,699,695 @\$15,666
3	\$5,673,800 @\$18,913	\$4,680,885 @\$15,603
2	\$5,616,800 @\$18,723	\$4,633,860 @\$15,446
1	\$5,515,900 @\$18,386	\$4,550,618 @\$15,169
C3: 2房 420'		
樓層	訂價	即供價17.5%
1	\$6,868,200 @\$16,353	\$5,666,265 @\$13,491
C2: 2房 418'		
樓層	訂價	即供價17.5%
1	\$6,879,800 @\$16,459	\$5,675,835 @\$13,579

B5: 3房連套房 557'		
樓層	訂價	即供價17.5%
9	\$9,890,300 @\$17,756	\$8,159,498 @\$14,649
8	\$9,437,300 @\$16,943	\$7,785,773 @\$13,978
7	\$8,836,400 @\$15,864	\$7,290,030 @\$13,088
6	\$8,646,200 @\$15,523	\$7,133,115 @\$12,806
5	\$8,628,900 @\$15,492	\$7,118,843 @\$12,781
3	\$8,594,400 @\$15,430	\$7,090,380 @\$12,730
2	\$8,525,600 @\$15,306	\$7,033,620 @\$12,628
1	\$8,355,100 @\$15,000	\$6,892,958 @\$12,375
B2: 3房 493'		
樓層	訂價	即供價17.5%
1	\$7,943,600 @\$16,113	\$6,553,470 @\$13,293

C7: 2房 430'		
樓層	訂價	即供價17.5%
9	\$7,430,000 @\$17,279	\$6,129,750 @\$14,255
8	\$7,298,600 @\$16,973	\$6,021,345 @\$14,003
7	\$7,099,800 @\$16,511	\$5,857,335 @\$13,622
6	\$7,085,700 @\$16,478	\$5,845,703 @\$13,595
5	\$7,071,500 @\$16,445	\$5,833,988 @\$13,567
3	\$7,043,200 @\$16,380	\$5,810,640 @\$13,513
2	\$6,986,900 @\$16,249	\$5,764,193 @\$13,405
1	\$6,847,100 @\$15,923	\$5,648,858 @\$13,137
C6: 2房及多用途房 447'		
樓層	訂價	即供價17.5%
9	\$7,723,300 @\$17,278	\$6,371,723 @\$14,254
8	\$7,586,800 @\$16,973	\$6,259,110 @\$14,002
7	\$7,380,100 @\$16,510	\$6,088,583 @\$13,621
6	\$7,365,400 @\$16,477	\$6,076,455 @\$13,594
5	\$7,350,700 @\$16,445	\$6,064,328 @\$13,567
3	\$7,321,300 @\$16,379	\$6,040,073 @\$13,512
2	\$7,262,700 @\$16,248	\$5,991,728 @\$13,404
1	\$7,117,400 @\$15,923	\$5,871,855 @\$13,136
C5: 2房 438'		
樓層	訂價	即供價17.5%
9	\$7,647,400 @\$17,460	\$6,309,105 @\$14,404
8	\$7,439,100 @\$16,984	\$6,137,258 @\$14,012
7	\$7,166,800 @\$16,363	\$5,912,610 @\$13,499
6	\$7,152,500 @\$16,330	\$5,900,813 @\$13,472
5	\$7,138,200 @\$16,297	\$5,889,015 @\$13,445
3	\$7,109,600 @\$16,232	\$5,865,420 @\$13,391
2	\$7,052,700 @\$16,102	\$5,818,478 @\$13,284
1	\$6,911,700 @\$15,780	\$5,702,153 @\$13,019

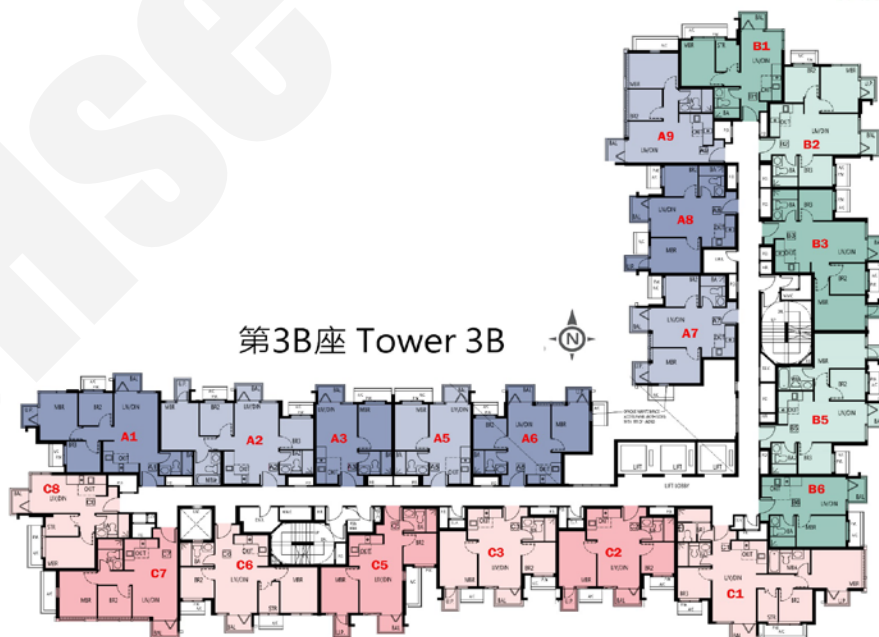

C1: 3房連套房及多用途房 673'		
樓層	訂價	即供價17.5%
9	\$11,824,900 @\$17,570	\$9,755,543 @\$14,496
8	\$11,392,000 @\$16,927	\$9,398,400 @\$13,965
7	\$10,818,600 @\$16,075	\$8,925,345 @\$13,262
6	\$10,637,700 @\$15,806	\$8,776,103 @\$13,040
5	\$10,616,500 @\$15,775	\$8,758,613 @\$13,014
3	\$10,574,000 @\$15,712	\$8,723,550 @\$12,962
2	\$10,489,400 @\$15,586	\$8,653,755 @\$12,858
1	\$10,279,600 @\$15,274	\$8,480,670 @\$12,601

B3: 3房 518'		
樓層	訂價	即供價17.5%
9	\$9,375,400 @\$18,099	\$7,734,705 @\$14,932
8	\$8,969,200 @\$17,315	\$7,399,590 @\$14,285
6	\$8,259,900 @\$15,946	\$6,814,418 @\$13,155
5	\$8,243,400 @\$15,914	\$6,800,805 @\$13,129
3	\$8,210,400 @\$15,850	\$6,773,580 @\$13,076
2	\$8,144,700 @\$15,723	\$6,719,378 @\$12,972
1	\$7,981,800 @\$15,409	\$6,584,985 @\$12,712

B5: 3房 557'		
樓層	訂價	折實價16%
9	\$9,828,400 @\$17,645	\$8,108,430 @\$14,557
8	\$9,351,500 @\$16,789	\$7,714,988 @\$13,851
7	\$8,793,100 @\$15,787	\$7,254,308 @\$13,024
6	\$8,688,900 @\$15,599	\$7,168,343 @\$12,870
5	\$8,671,500 @\$15,568	\$7,153,988 @\$12,844
3	\$8,636,800 @\$15,506	\$7,125,360 @\$12,792
2	\$8,567,700 @\$15,382	\$7,068,353 @\$12,690
1	\$8,396,400 @\$15,074	\$6,927,030 @\$12,436
B2: 3房 493'		
樓層	訂價	即供價17.5%
1	\$7,959,300 @\$16,145	\$6,566,423 @\$13,319

C7 : 2房及多用途房 449'		
樓層	訂價	即供價17.5%
9	\$7,604,600 @\$16,937	\$6,273,795 @\$13,973
8	\$7,544,200 @\$16,802	\$6,223,965 @\$13,862
7	\$7,484,300 @\$16,669	\$6,174,548 @\$13,752
6	\$7,469,400 @\$16,636	\$6,162,255 @\$13,724
5	\$7,454,500 @\$16,602	\$6,149,963 @\$13,697
3	\$7,424,600 @\$16,536	\$6,125,295 @\$13,642
2	\$7,365,300 @\$16,404	\$6,076,373 @\$13,533
C2 : 2房及多用途房 444'		
樓層	訂價	即供價17.5%
9	\$7,572,500 @\$17,055	\$6,247,313 @\$14,071
8	\$7,512,400 @\$16,920	\$6,197,730 @\$13,959
7	\$7,452,800 @\$16,786	\$6,148,560 @\$13,848
6	\$7,437,900 @\$16,752	\$6,136,268 @\$13,820
5	\$7,423,000 @\$16,718	\$6,123,975 @\$13,793
3	\$7,393,300 @\$16,652	\$6,099,473 @\$13,738
2	\$7,334,200 @\$16,518	\$6,050,715 @\$13,628

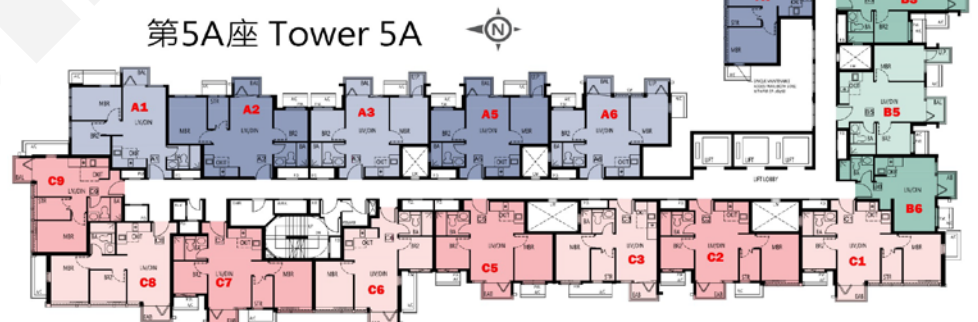

C1 : 2房及多用途房 445'		
樓層	訂價	即供價17.5%
9	\$7,589,400 @\$17,055	\$6,261,255 @\$14,070
8	\$7,529,100 @\$16,919	\$6,211,508 @\$13,958
7	\$7,469,400 @\$16,785	\$6,162,255 @\$13,848
6	\$7,454,500 @\$16,752	\$6,149,963 @\$13,820
5	\$7,439,500 @\$16,718	\$6,137,588 @\$13,792
3	\$7,409,800 @\$16,651	\$6,113,085 @\$13,737
2	\$7,276,400 @\$16,351	\$6,003,030 @\$13,490
1	\$6,912,600 @\$15,534	\$5,702,895 @\$12,815

B3 : 2房 432'		
樓層	訂價	即供價17.5%
2	\$7,105,200 @\$16,447	\$5,861,790 @\$13,569
1	\$6,892,000 @\$15,954	\$5,685,900 @\$13,162

C5 : 2房 389'		
樓層	訂價	即供價17.5%
9	\$7,190,600 @\$18,485	\$5,932,245 @\$15,250



第5B座 Tower 5B

C5 : 2房及多用途房 450'		
樓層	訂價	即供價17.5%
9	\$7,608,600 @\$16,908	\$6,277,095 @\$13,949
8	\$7,548,200 @\$16,774	\$6,227,265 @\$13,838
7	\$7,488,300 @\$16,641	\$6,177,848 @\$13,729
6	\$7,473,400 @\$16,608	\$6,165,555 @\$13,701
5	\$7,458,400 @\$16,574	\$6,153,180 @\$13,674
3	\$7,428,600 @\$16,508	\$6,128,595 @\$13,619
2	\$7,369,200 @\$16,376	\$6,079,590 @\$13,510
1	\$7,221,800 @\$16,048	\$5,957,985 @\$13,240
C3 : 2房 438'		
樓層	訂價	即供價17.5%
9	\$7,362,000 @\$16,808	\$6,073,650 @\$13,867
8	\$7,303,600 @\$16,675	\$6,025,470 @\$13,757
6	\$7,231,200 @\$16,510	\$5,965,740 @\$13,620
5	\$7,216,700 @\$16,476	\$5,953,778 @\$13,593
3	\$7,187,800 @\$16,411	\$5,929,935 @\$13,539
2	\$7,130,300 @\$16,279	\$5,882,498 @\$13,430
1	\$6,987,700 @\$15,954	\$5,764,853 @\$13,162
C2 : 1房及多用途房 366'		
樓層	訂價	即供價17.5%
9	\$6,510,600 @\$17,789	\$5,371,245 @\$14,676
8	\$6,458,900 @\$17,647	\$5,328,593 @\$14,559
7	\$6,407,700 @\$17,507	\$5,286,353 @\$14,444
6	\$6,394,900 @\$17,472	\$5,275,793 @\$14,415
5	\$6,382,100 @\$17,437	\$5,265,233 @\$14,386
3	\$6,356,600 @\$17,368	\$5,244,195 @\$14,328
2	\$6,305,700 @\$17,229	\$5,202,203 @\$14,214
1	\$6,179,600 @\$16,884	\$5,098,170 @\$13,929



A8 : 3房 507'		
樓層	訂價	即供價17.5%
9	\$9,420,100 @\$18,580	\$7,771,583 @\$15,329
8	\$8,988,700 @\$17,729	\$7,415,678 @\$14,627
6	\$8,235,200 @\$16,243	\$6,794,040 @\$13,400
5	\$8,218,700 @\$16,210	\$6,780,428 @\$13,374
3	\$8,185,900 @\$16,146	\$6,753,368 @\$13,320
2	\$8,120,400 @\$16,017	\$6,699,330 @\$13,214
1	\$7,958,000 @\$15,696	\$6,565,350 @\$12,949
A6 : 2房及多用途房 448'		
樓層	訂價	即供價17.5%
9	\$7,701,800 @\$17,192	\$6,353,985 @\$14,183
8	\$7,603,000 @\$16,971	\$6,272,475 @\$14,001
7	\$7,468,500 @\$16,671	\$6,161,513 @\$13,753
6	\$7,416,600 @\$16,555	\$6,118,695 @\$13,658
5	\$7,401,800 @\$16,522	\$6,106,485 @\$13,631
3	\$7,372,200 @\$16,456	\$6,082,065 @\$13,576
2	\$7,313,200 @\$16,324	\$6,033,390 @\$13,467
1	\$7,166,900 @\$15,998	\$5,912,693 @\$13,198

A5 : 1房 307'		
樓層	訂價	即供價17.5%
9	\$5,900,800 @\$19,221	\$4,868,160 @\$15,857
8	\$5,825,100 @\$18,974	\$4,805,708 @\$15,654
7	\$5,778,900 @\$18,824	\$4,767,593 @\$15,530
6	\$5,767,300 @\$18,786	\$4,758,023 @\$15,498
5	\$5,755,800 @\$18,749	\$4,748,535 @\$15,468
3	\$5,732,800 @\$18,674	\$4,729,560 @\$15,406
2	\$5,686,900 @\$18,524	\$4,691,693 @\$15,282
1	\$5,573,200 @\$18,154	\$4,597,890 @\$14,977
C6 : 2房 429'		
樓層	訂價	即供價17.5%
1	\$6,970,600 @\$16,248	\$5,750,745 @\$13,405
B1 : 3房 502'		
樓層	訂價	即供價17.5%
1	\$8,007,600 @\$15,951	\$6,606,270 @\$13,160

A2 : 2房及多用途房 449'		
樓層	訂價	即供價17.5%
9	\$7,922,100 @\$17,644	\$6,535,733 @\$14,556
8	\$7,782,000 @\$17,332	\$6,420,150 @\$14,299
6	\$7,517,500 @\$16,743	\$6,201,938 @\$13,813
5	\$7,502,400 @\$16,709	\$6,189,480 @\$13,785
3	\$7,472,400 @\$16,642	\$6,164,730 @\$13,730
2	\$7,412,600 @\$16,509	\$6,115,395 @\$13,620
1	\$7,264,400 @\$16,179	\$5,993,130 @\$13,348
A1 : 2房及多用途房 444'		
樓層	訂價	即供價17.5%
1	\$7,276,400 @\$16,388	\$6,003,030 @\$13,520

別墅WV6 House WV6

C: 3房連套房及多用途房 75'		
樓層	訂價	即供價17.5%
2	\$12,244,900 @\$16,176	\$10,102,043 @\$13,345
1	\$12,004,800 @\$15,858	\$9,903,960 @\$13,083
B: 4房連套房 773'		
樓層	訂價	即供價17.5%
2	\$13,633,100 @\$17,637	\$11,247,308 @\$14,550
1	\$13,365,800 @\$17,291	\$11,026,785 @\$14,265
A: 4房連套房 795'		
樓層	訂價	即供價17.5%
2	\$13,633,100 @\$17,637	\$11,247,308 @\$14,550
1	\$13,365,800 @\$17,291	\$11,026,785 @\$14,265



1樓 1/F



2樓 2/F

C: 3房連套房及多用途房 75'		
樓層	訂價	即供價17.5%
2	\$12,244,900 @\$16,176	\$10,102,043 @\$13,345
1	\$12,004,800 @\$15,858	\$9,903,960 @\$13,083
B: 4房連套房 773'		
樓層	訂價	即供價17.5%
2	\$13,633,100 @\$17,637	\$11,247,308 @\$14,550
1	\$13,365,800 @\$17,291	\$11,026,785 @\$14,265
A: 4房連套房 795'		
樓層	訂價	即供價17.5%
2	\$13,211,100 @\$16,618	\$10,899,158 @\$13,710
1	\$12,952,000 @\$16,292	\$10,685,400 @\$13,441



1樓 1/F



2樓 2/F